

Remaining Portion

R.P.O. Vol. 136 Fol. 601  
 C.T. Vol. 372 Fol. 427  
 Bk.993 fol. 32  
 Bk.714 fol. 171  
**C.T VOL 5223 Fol. 241**

165(1)

Cadastral Sheet G.18.D.  $\frac{73C}{2/c}$   
 Ward of Siparia  
 County of St. Patrick  
Penal

31

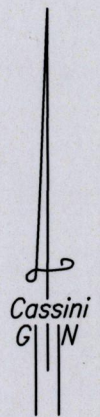
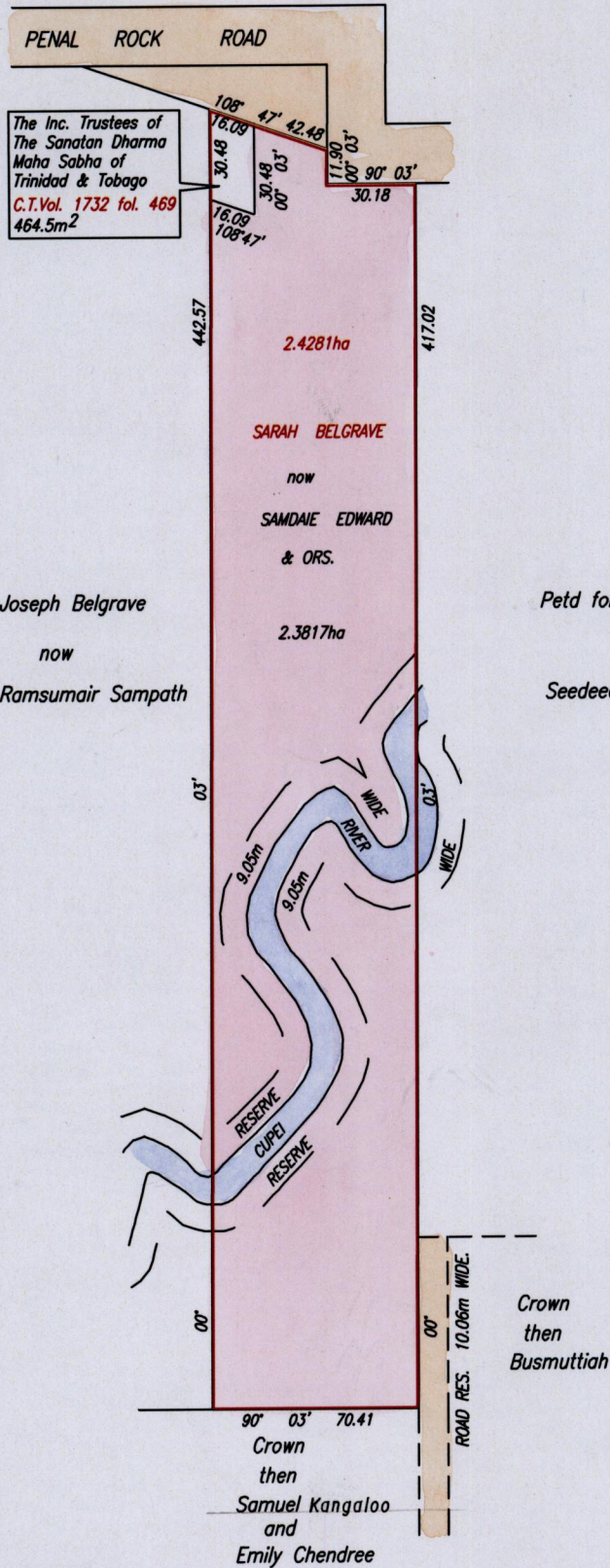

Approved *[Signature]*  
 Director of Surveys **2009.8.27**

SCALE 1:2500  
 Distances are in Metres.

This is a true diagram of a Parcel of land in the Ward of Siparia  
 Containing two point four two eight one hectares originally transferred to SARAH BELGROVE  
 Showing a portion coloured pink and containing two point three eight one seven hectares  
 being the remainder after one previous transfer of another portion of the the land  
 In accordance with Regulation 25(1) of the Land Surveyors' Regulations 1998,  
 I certify that this plan is correct.

Checked by *[Signature]* 25/8/09  
 Entered . . . . .

*[Signature]*  
 Trinidad & Tobago, Land Surveyor **31<sup>st</sup> July 2009**  
PATH = E:\700 E\Drawings\09\Edwards.dwg

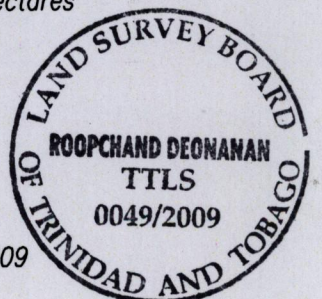





1659/31  
~~1588/74~~