

Vol. 5308 Fol. 3

REMAINING PORTION

R.P.O. Vol. 515 Fol. 477

C.T. Vol. Fol.

Cadastral Sheet B.23.A. ^{24A} 1/c

Ward of Tacarigua
County of St. George

Bk. 100 Fol. 78

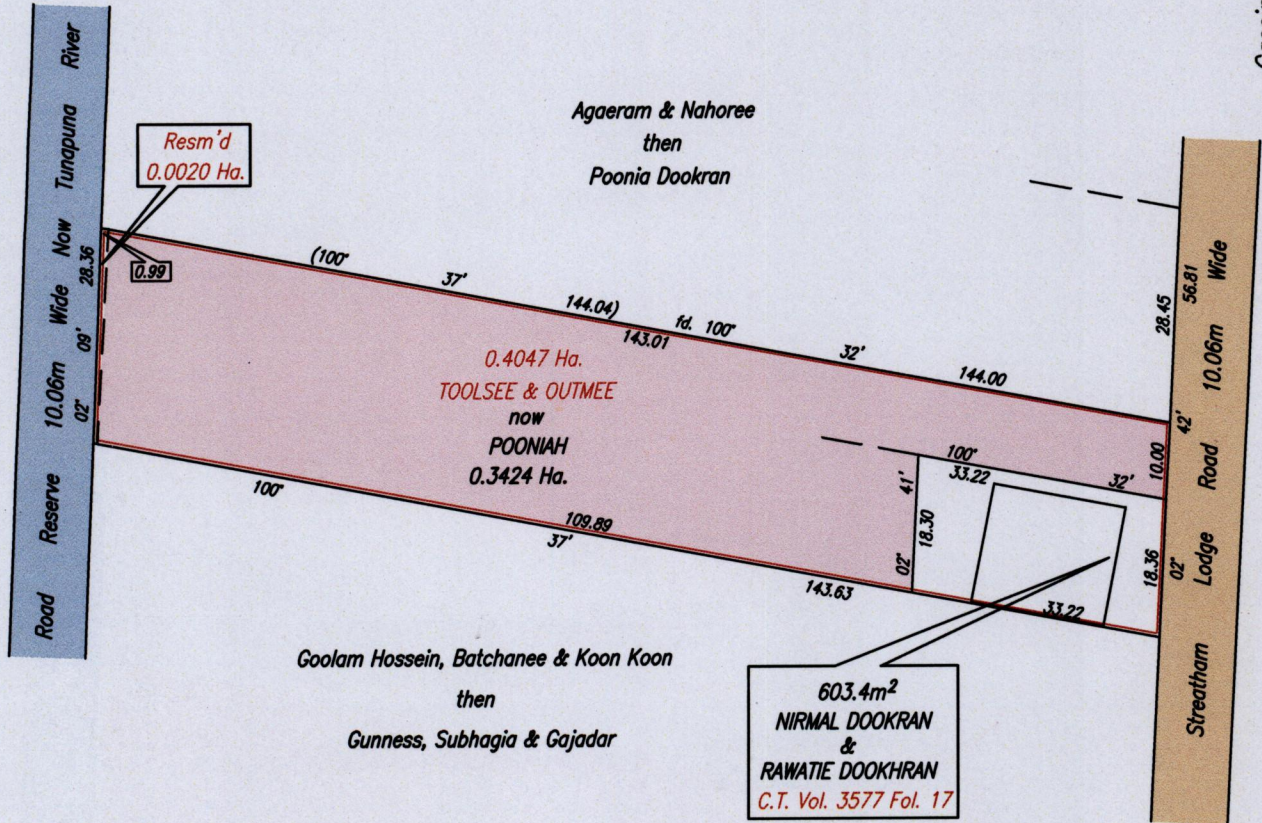

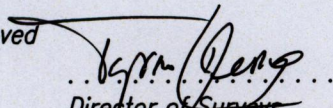
Approved 
 Director of Surveys
 2007.12.18

SCALE 1/1000
 Distances are in metres

Bearings are Cassini Grid based on Solar Observations

This is a true copy of a diagram of zero point four zero four seven hectare originally transferred to Toolsee & Outmee, showing a portion coloured pink and containing zero point three four two four hectare being the remainder after one previous transfer and one resumption of another portion of the land.

In accordance with Regulation 25 (1) of the Land Surveyors' Regulations 1998,
 I certify that this plan is correct.

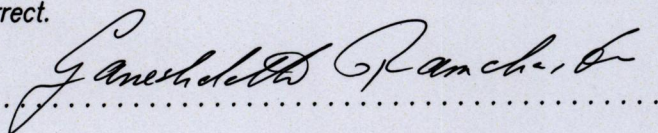
Entered on 

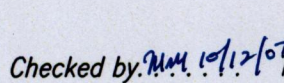
Checked by  Trinidad & Tobago Land Surveyor 2007



3

1020



now 1650/3
1A18/02
1385/02