

REMAINING PORTION

R.P.O Vol. 560 Fol. 177
 C.T. Vol. 3541 Fol. 399
 Vol. 5385 Fol. 85

Ward of Siparia. 26
 County of St. Patrick.
 Cadastral Sheet G.14.M. 64D
 3/c

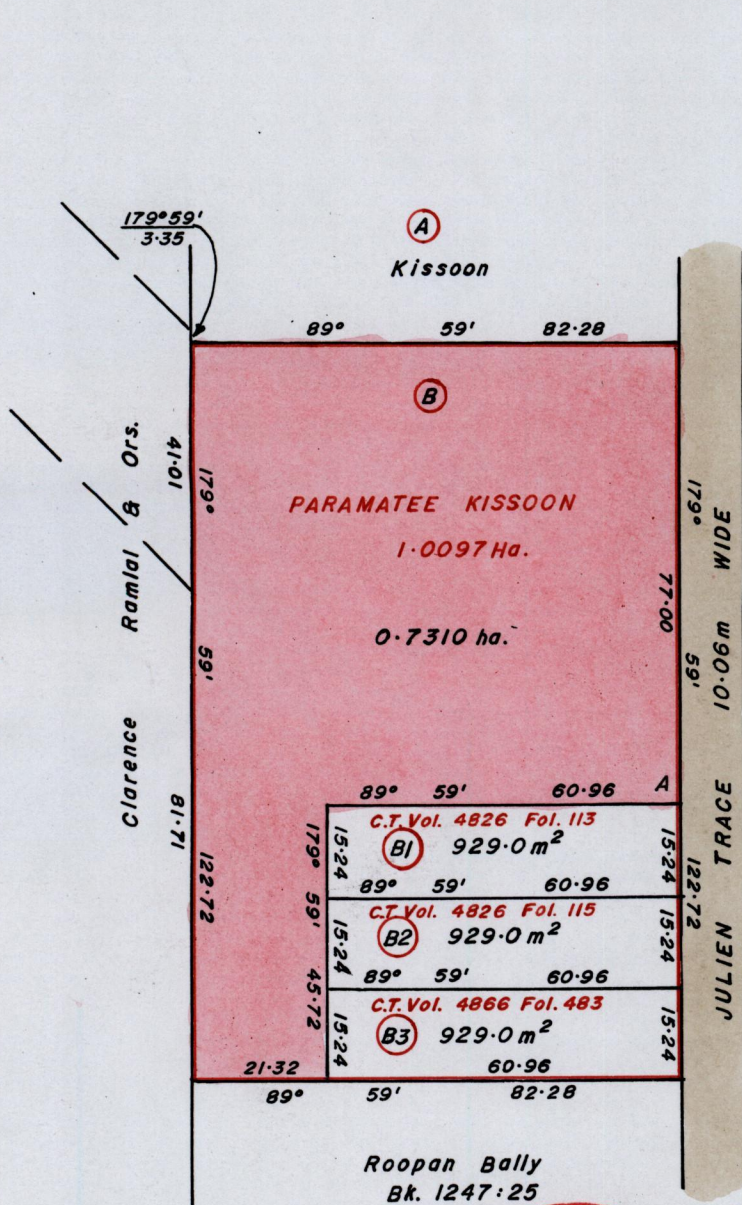

- B1— Sooklal Heeralal & Rambajan Jairam
- B2— Sooklal Heeralal & Rambajan Jairam
- B3— Sumatie Kissoon

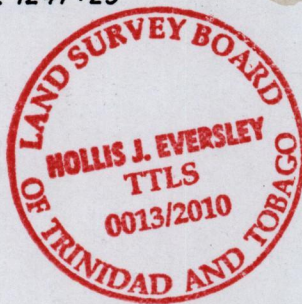

A
 1123291 mN, 675548 mE.
 U.T.M. 20, WGS 84 (+/-5.0m)
 GPS Handheld Direct Obs.

Bk. 1200 : 213
 " 1375 : 3

SCALE 1 : 1250.
 Distances are in METRES

Approved: *[Signature]*
 Director of Surveys. 2011.2.16

This is a true copy of a diagram of one point zero zero nine seven hectares, Originally transferred to PARAMATEE KISSOON showing a portion, Coloured pink and containing zero point seven three one zero hectares, being the remainder, after three (3) previous transfers of another portion of the land. In accordance with Reg. 25(1) of the Land Surveyors' Regulations 1998, I certify that this plan is correct.

Checked by *[Signature]* 15/2/11

Entered

[Signature]
 Trinidad and Tobago Land Surveyor..... 2010.

Original Bl. 1329: 211

REMAINING PORTION

R.P.O. Vol. 200 Fol. 177
C.E. Vol. 1341 Fol. 389
Hind of Siparia
County of St. Patrick
Cadastral Sheet G.14.M. 64D
36

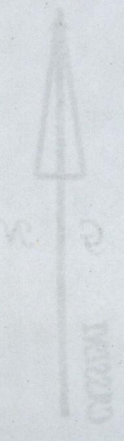

This is a true copy of a diagram of one point two zero nine seven hectares, originally transferred to PARANATEE KISSOON showing a portion colored pink and containing zero point seven three one hectares, being the remainder after three (3) previous transfers of another portion of the land in accordance with Reg. 25(1) of the Land Surveyors' Regulations 1998. I certify that this plan is correct.

Now 1650/26
1276/36