

1650

1650/22

22

R.P.O. Vol. 9
C.T. Vol. 1935
U.R.P.N.

Fol. 643
Fol. 85

24B
Cadastral Sheet B.24.B. 4/a
Borough of Arima
County of St. George
Vide Plan E.C. 162

Vol. 5437 Fol. 289

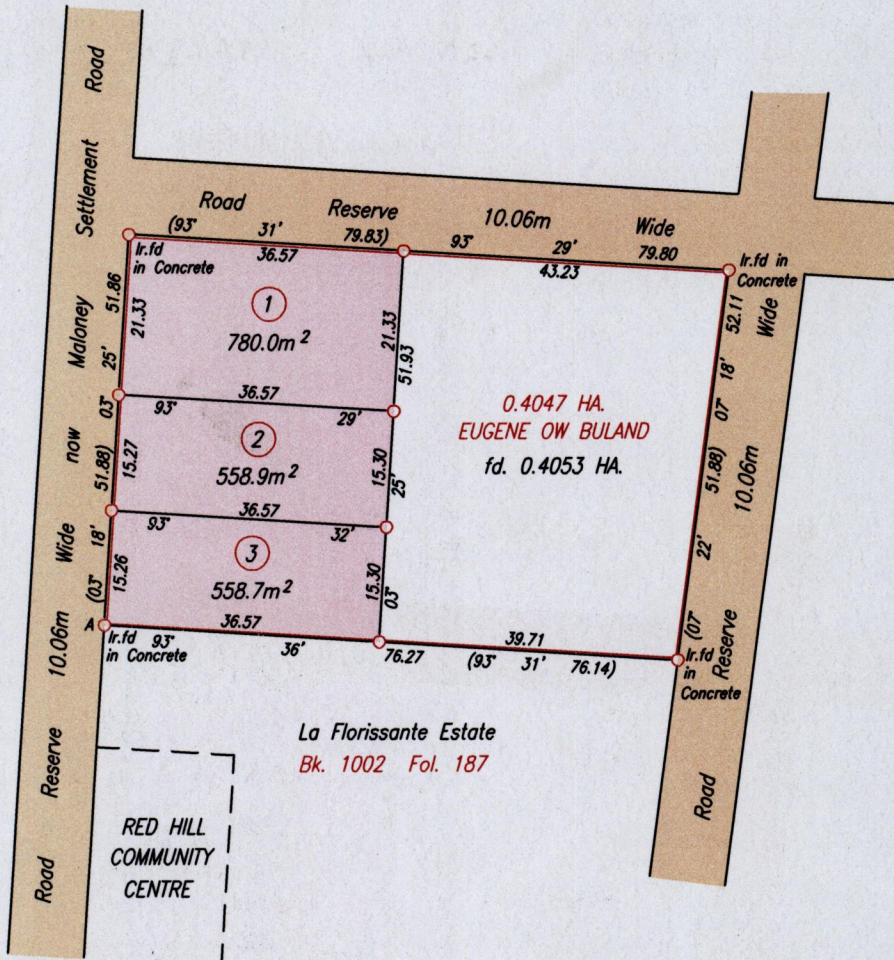
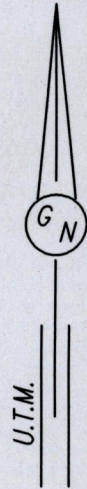

Approved

[Signature]
Director of Surveys 2011.12.14

Point A

Co-ordinates obtained by Hand Held G.P.S. (Nap. Datum)
Accuracy ± 4m
E 683791m
N 1174555m

SCALE 1/1000
Distances are in metres

Note: To obtain Cassini bearing + 18 minutes

○ Denotes Iron put except otherwise stated
Bearings are U.T.M. Grid based on Solar Observations

Plan of 3 Parcels of land coloured pink in the Borough of Arima
Containing together one thousand eight hundred and ninety seven point six square metres
Surveyed by me, with due authority, in April 2011
In accordance with Regulation 25 (1) of the Land Surveyors' Regulations 1998,
I certify that this plan is correct.

Entered on

[Signature]

Checked by *[Signature]* 8/12/11

Trinidad & Tobago Land Surveyor

25/11 2011

22

0201

| LOT No. | CT. VOLUME. & FOLIO | NAMES |
|---------|---------------------|---|
| 1 | 5437 fol. 299 | KIRK REGINALD ELLIS PETERS & NICOLA CRAWFORD-PETERS |
| 2 | 5500 fol. 225 | KENDALL GALINDO |
| 3 | 5481 fol. 259 | Avianne Boney. |



T395/81
NOW 1650/22