

165(1)

113

C.T. Vol. 5503 Fol. 217
R.P.O. Vol. 28 Fol. 563
C.T. Vol. 3304 Fol. 185

Cadastral Sheet G.B.N. 63C
Ward of Naparima. 3/c
County of Victoria.
Debe.

Ref. : Plan E.G. 114

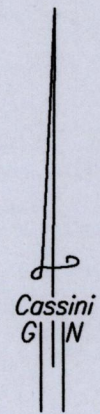
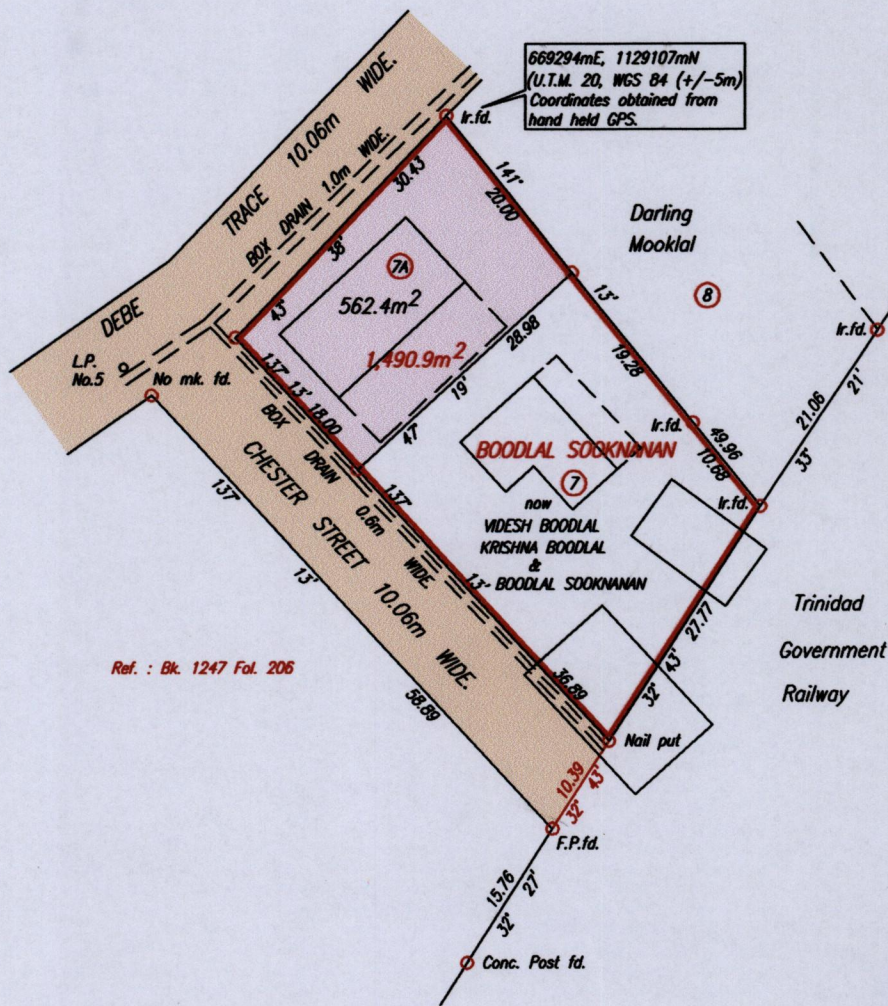

Ref. : Bk. 1247 Fol. 206



Approved *[Signature]*
Director of Surveys 2012.5.29

○ Denotes Iron put except otherwise stated.
Bearings are Cassini Grid based on Solar Observations.
SCALE 1:750
Distances are in Metres

PLAN of a Parcel of land coloured pink in the Ward of Naparima
Containing five hundred and sixty two point four square metres.
Surveyed by me, with due authority, in February, 2011
In accordance with Regulation 25(1) of the Land Surveyors' Regulations 1998,
I certify that this plan is correct.

Checked by *[Signature]* Winston Ramcharan

Entered Trinidad & Tobago Land Surveyor 10th May 2012

CT. VOL. 5503 FOL. 217 - VIDESH BOODLAL & MARSHA RAMDIAL BOODLAL

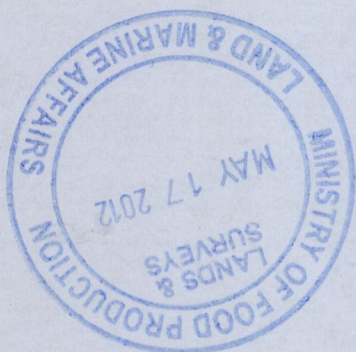

1438/22
Now 1650/113