

PROCESS ID# 50856

165(1)

111

R.P.O. Vol. 152 Fol. 185

Remaining Portion

Cadastral Sheet G.19.E. & F. 74A

C.T. Vol. 2835 Fol. 33

Ward of Siparia

Vol. 5507 Fol. 25

County of St. Patrick.

8 M.M.,

Penal Rock Road

Bk.1137 fol 211

Bk.724 fol 149

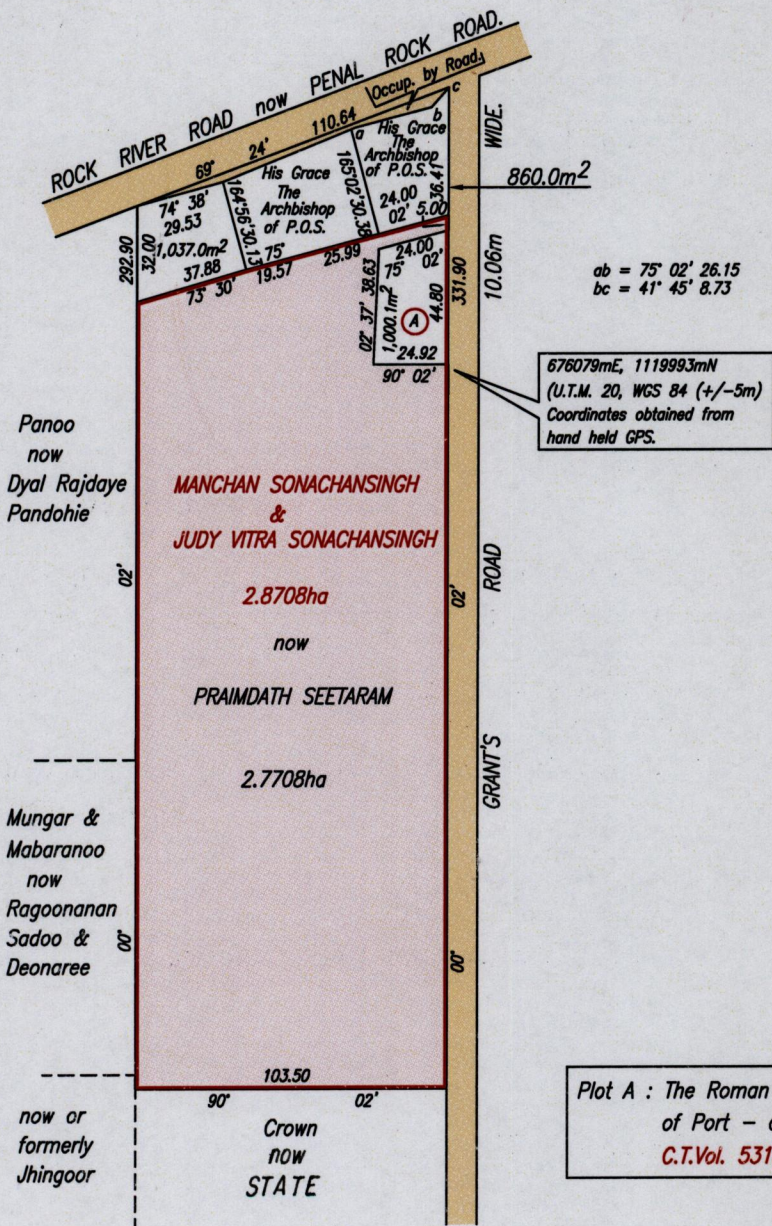

Approved

[Signature]
Director of Surveys 2012.5.29

SCALE 1:2500

Distances are in metres

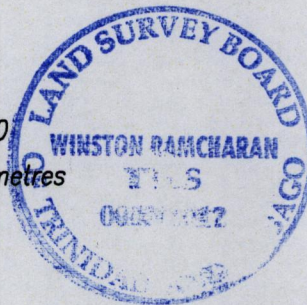

This is a true copy of a diagram of a Parcel of land in the Ward of Siparia Containing two point eight seven zero eight hectares originally transferred to MANCHAN SONACHANSINGH & JUDY VITRA SONACHANSINGH Showing a portion coloured pink and containing two point seven seven zero eight hectares being The remainder after one previous transfer of another portion of the land. In accordance with Regulation 25 (1) of the Land Surveyors' Regulations 1998, I certify that this plan is correct.

Checked by

[Signature] Winston Ramcharan

Entered on

Trinidad & Tobago Land Surveyor. 28th March 2012.

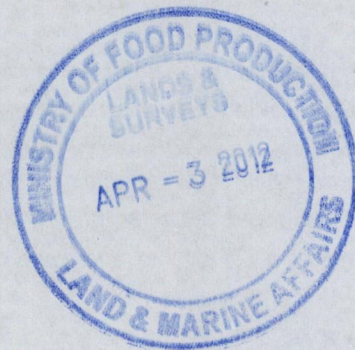

NO. 1650/1111
TA 33/33