

Process ID #110926
U.P.R.N No.

1649

173

Cadastral Sheet G.7.I 63A
Ward of Siparia 2/c, 3/b, 4/a
County of St. Patrick
PROVIDENCE ESTATE

A - 660,081mE, 1128,740mN
UTM ZONE 20, Naparima)
Direct Observation-GPS Hand held

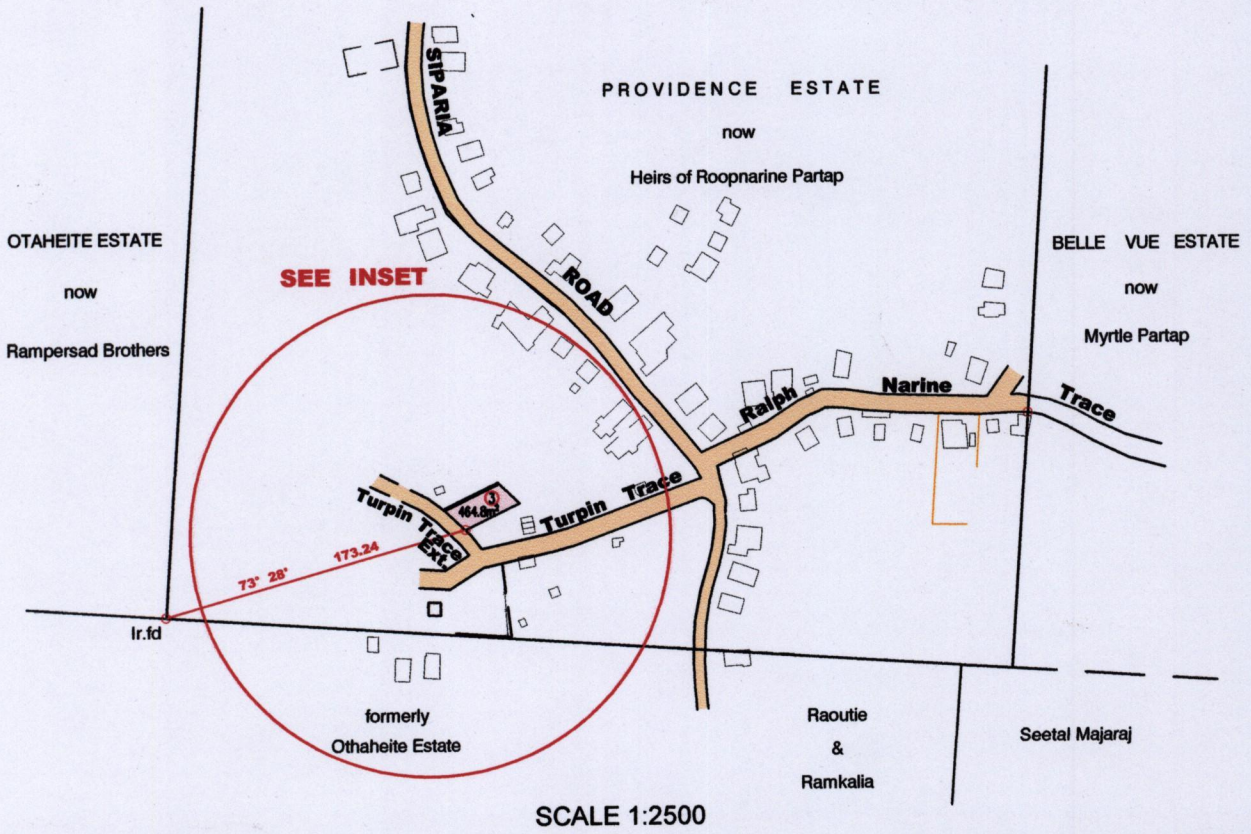

INSET

A - B	164° 45'	26.32
B - C	71° 46'	13.84

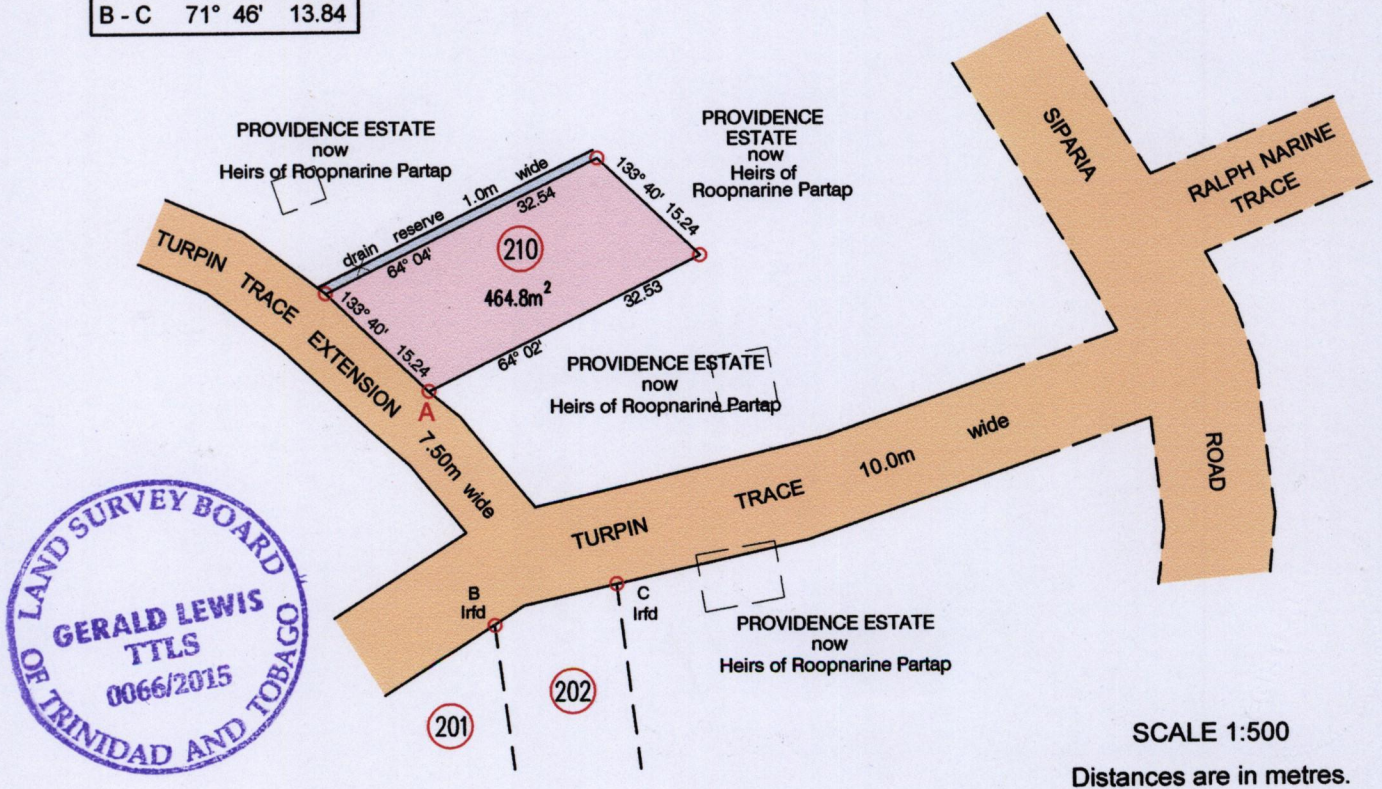

○ Denotes Iron put unless otherwise stated
Bearings are U.T.M Grid based on Solar Obs.

PLAN of a Parcel of land coloured pink in the **Ward of Siparia**.
Containing **four hundred and sixty four point eight hectares**

Surveyed by me, with due authority, in July 2015 at the request of **the Heirs of Roopnarine Partap and Roland Bachan**
Certified Correct in accordance with Regulation 25(1) of the Land Surveyors Regulations 1998

Entered by

MINISTRY OF FOOD PRODUCTION
LAND AND MARINE AFFAIRS
JUL 10 2015
#170 RR
Lands & Surveys Division

Trinidad & Tobago Land Surveyor 09/07/2015