

1649

165

U.P.R.N.

A - 661,493mE, 1131,371mN
UTM ZONE 20, Naparima (+/- 3.00M)
Direct Observation-GPS Hand held

Process ID #110896

Cadastral Sheet G.7.I., 63A
2/c

Ward of Siparia

County of St. Patrick

**BELLE VUE ESTATE
SOUTH TRUNK ROAD**

See Registered Deed No:
DE 2000501595784

Ref. Plan **J.M 147**

G.N.

U.T.M.

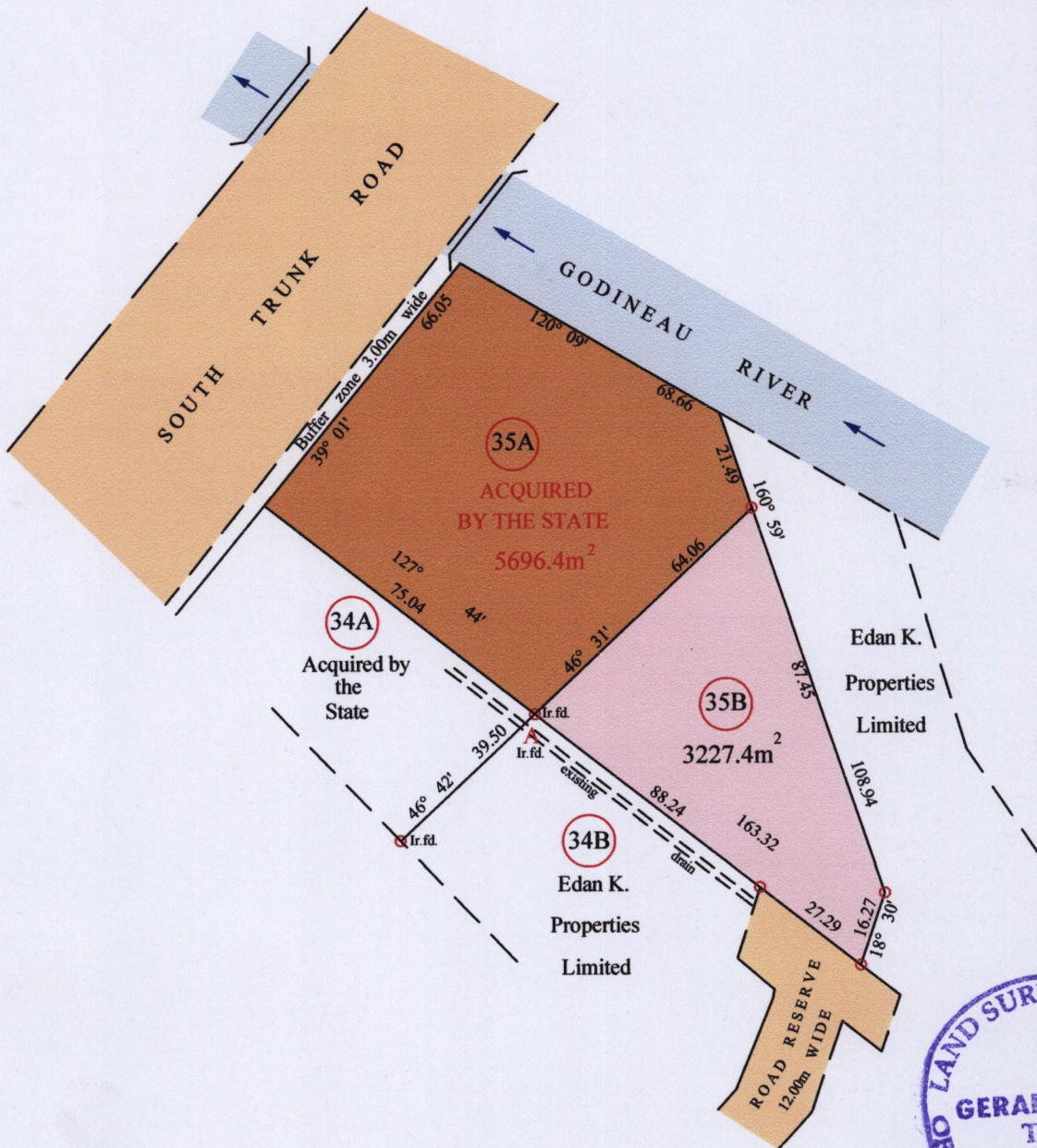

SCALE 1:1500

Distances are in Metres

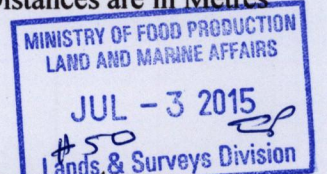

○ Denotes Iron Put unless otherwise stated

Bearings are U.T.M. Grid based on Solar Obs.

PLAN of 2 Parcels of land coloured Pink and Raw Sienna in the Ward of Siparia

Containing together eight thousand nine hundred and twenty three point eight square metres

Surveyed by me, with due authority, in May 2015 at the request of **Edan K. Properties Ltd.**

Certified Correct in accordance with Regulation 25(1) of the Land Surveyors Regulations 1998

Entered on

Gerald Lewis
Trinidad & Tobago Land Surveyor 28/06/2015