

U.P.R.N.

1649

162

A - 661,274mE, 1131,217mN  
UTM ZONE 20, Naparima (+/- 3.00M)  
Direct Observation-GPS Hand held

A - B 66° 26' 5.88

Process ID# 110882

Cadastral Sheet G.7.I., 63A  
2/c

Ward of Siparia

County of St. Patrick

**BELLE VUE ESTATE  
SOUTH TRUNK ROAD**

See Registered Deed No:  
**DE 2000501595784**

Ref. Plan **J.M 147**

G.N.  
U.T.M.

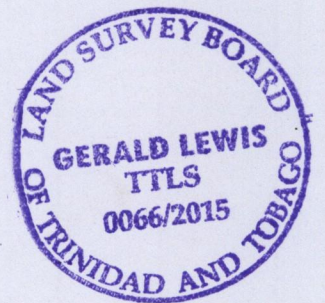
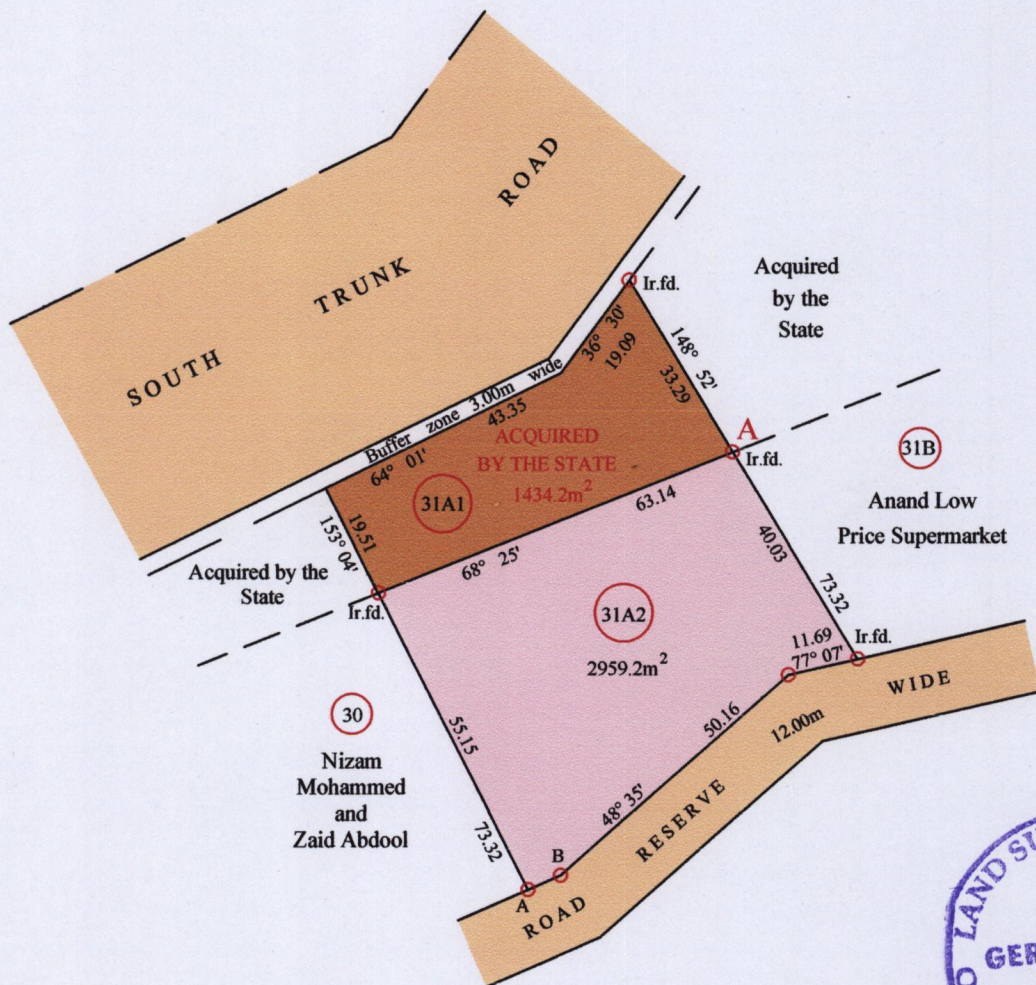

SCALE 1:1250

Distances are in Metres

○ Denotes Iron Put unless otherwise stated

Bearings are U.T.M. Grid based on Solar Obs.

PLAN of 2 Parcels of land coloured Pink and Raw Sienna in the Ward of Siparia

Containing together four thousand three hundred and ninety three point four square metres

Surveyed by me, with due authority, in May 2015 at the request of Edan K. Properties Ltd.

Certified Correct in accordance with Regulation 25(1) of the Land Surveyors Regulations 1998

Entered on .....

Trinidad & Tobago Land Surveyor *Gerald Lewis* 28/06/2015

