

Process SD# 109455

1649

Ward of Siparia

County of St. Patrick

123

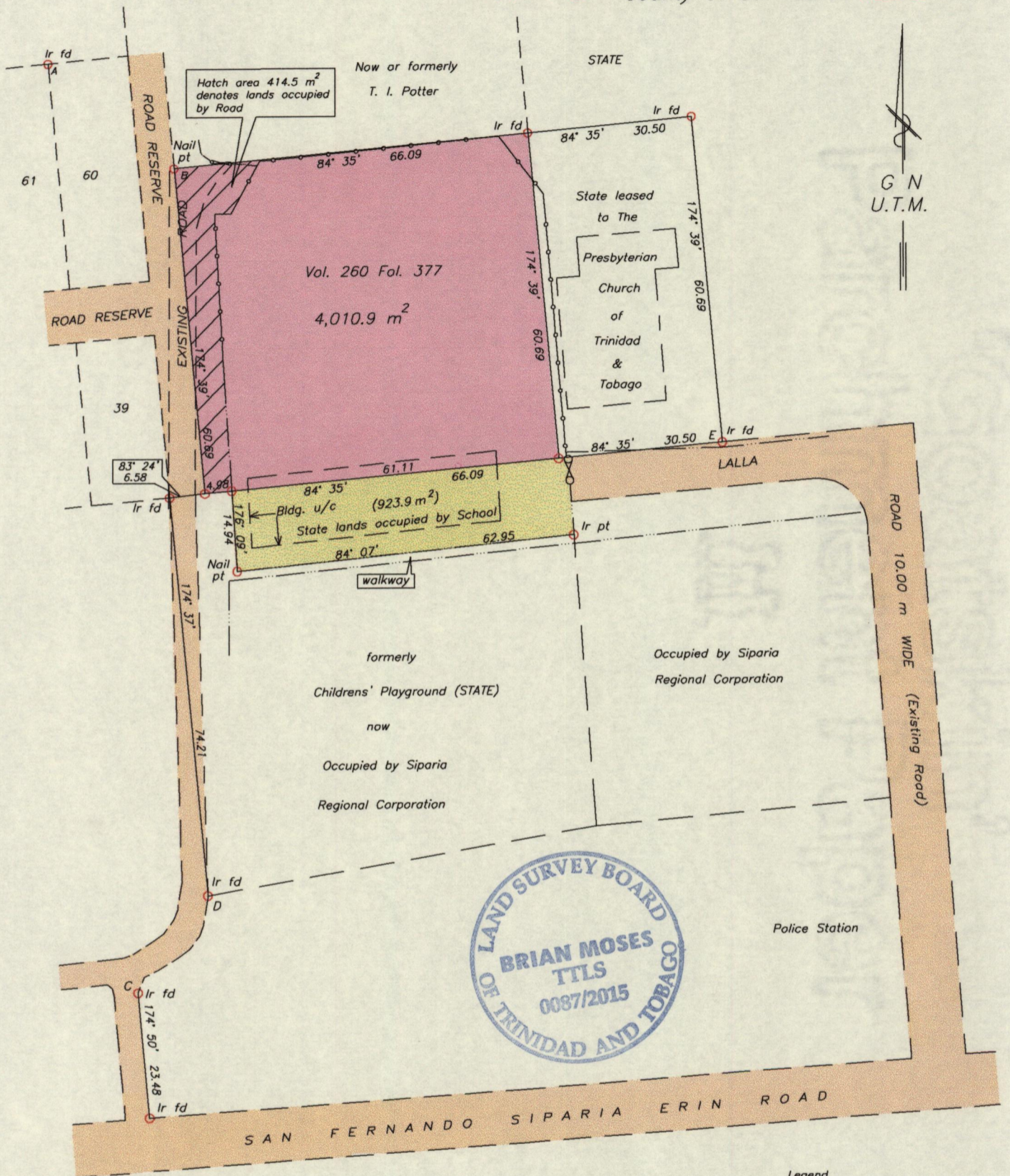

G N
U.T.M.

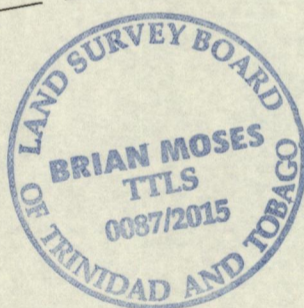

E - N 1121822
 E 663485
 Derived From Hand-Held GPS (+/-5 m)
 UTM Zone 20 Naparima Co-ordinates

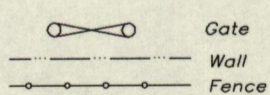

Legend

A - B	129° 51'	30.34
C - D	35° 45'	22.20

SCALE 1:1000
 Distances are in METRES

o Denotes No. mk pt unless otherwise stated
 Bearings are U.T.M. Grid based on Solar observations

PLAN of a Parcel of land coloured pink in the Ward of Siparia
 Containing four zero one zero point nine square metres
 Re-defined by me, with due authority, in April, 2015 for The Presbyterian Church of
 Trinidad and Tobago
 Certified Correct in accordance with Regulation 25 (1) of the Land Surveyors' Regulations 1998

Checked by
 Entered on
 Brian Moses
 Trinidad & Tobago Land Surveyor (T.T.L.S.)
 7th May 2015

