

Process ID# 109450

1649

Ward of Siparia

County of St. Patrick

Cadastral Sheet G 12 D 63.E. 1/b

121

G.N

U.T.M.

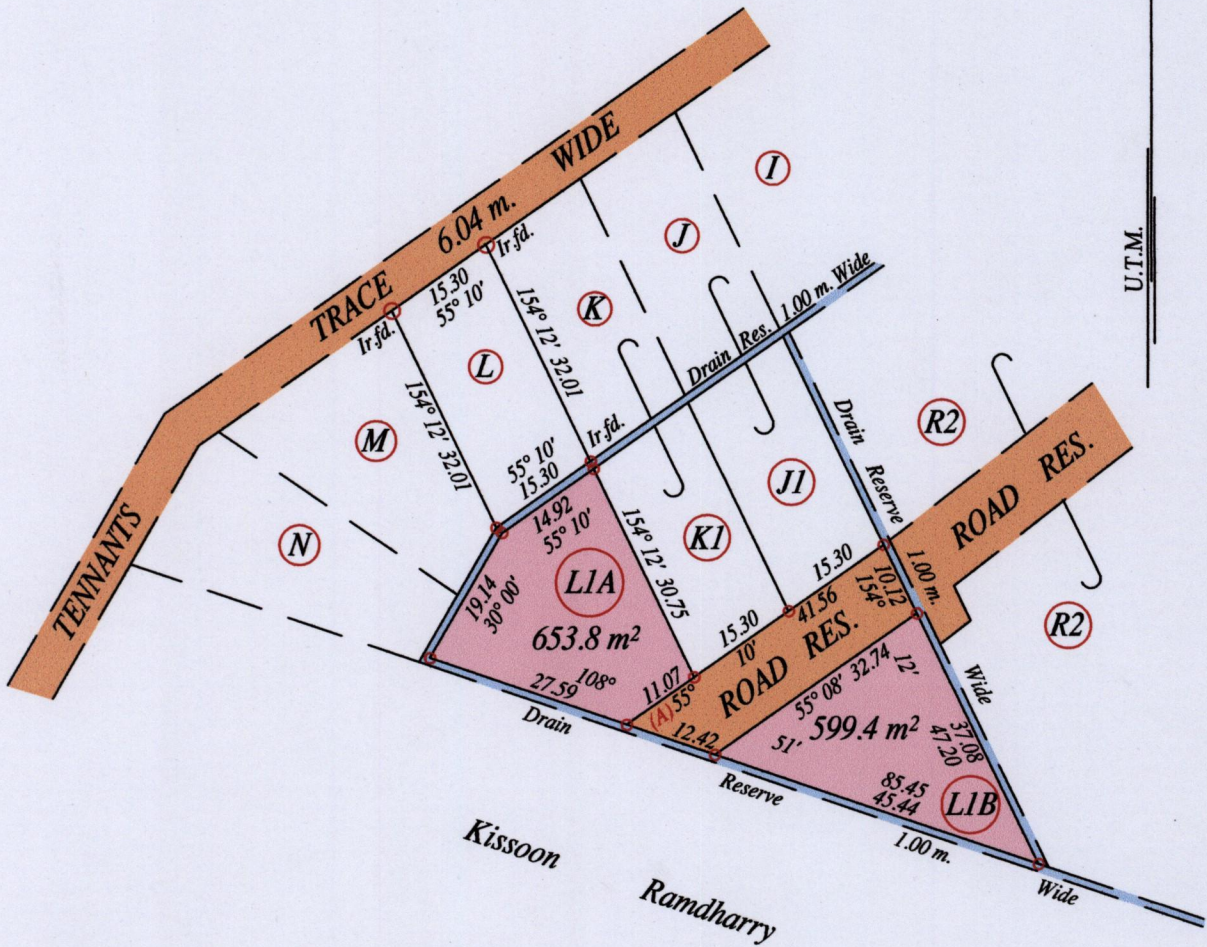

At Station (A)
 E: 665472 N: 1126615
 Hand Held GPS.
 Naparima Datum (+/-10m)
 UTM Zone 20.

Vide Bk. 945 fol. 26
 Vide Bk. 1182 fol. 9
 SCALE : 1:1000

o Denotes Iron put except stated otherwise.

Note: Bearings are U.T.M. grid based on solar observations Distances are in metres
 PLAN of 2 Parcels of land coloured pink in the Ward of Siparia
 Containing together one thousand two hundred and fifty three point two square metres
 Surveyed by me, with due authority, in April 2015 for Davanand Rampersad
 In accordance with Regulation 25 (1) of the Land Surveyors' Regulations 1998,
 Certified correct in accordance with Regulation 25 (1) of the Land Surveyors' Regulations 1998.

Checked by *Reynold Bhikarry*

Entered on Trinidad & Tobago Land Surveyor 1st MAY 2015

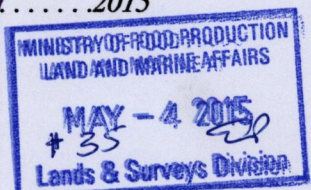

CL72