

Process JSH 109114

Cadastral Sheet G.7.M. 63A  
4/c

Ward of Siparia

County of St. Partick

Vide : Bk.878 Fol.28

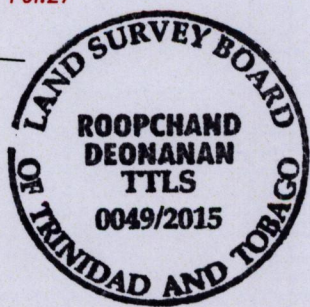
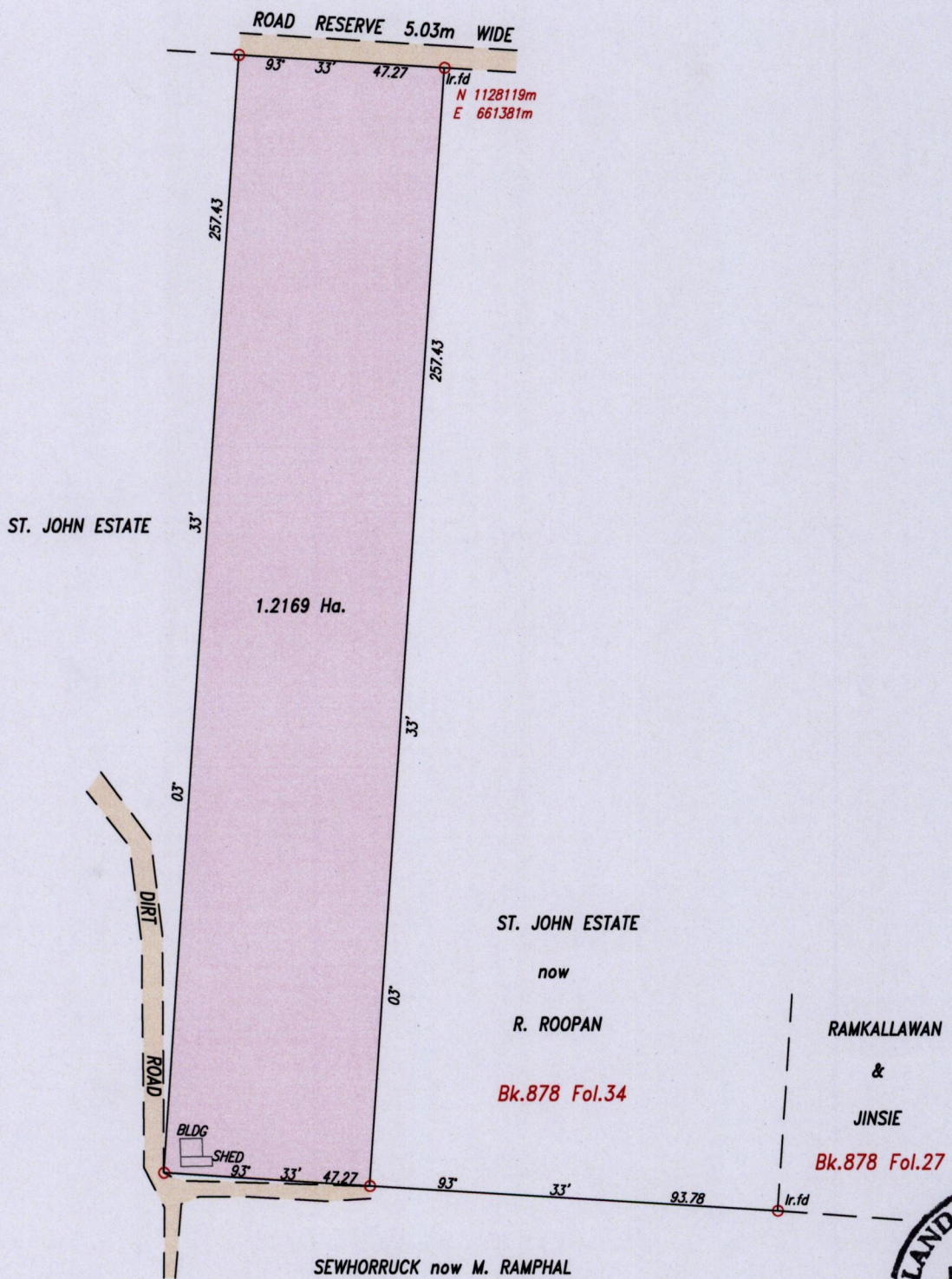
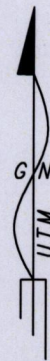

o Denotes Iron put except where otherwise stated  
Co-ordinates are Naparima/UTM, derived using Handheld GPS (+/-5m)  
Bearings are U.T.M. Grid based on Solar Observations

SCALE 1:1500

Distances are in metres

PLAN of a Parcel of land coloured pink in the Ward of Siparia  
Containing one point two one six nine hectare

Surveyed by me, with due authority, in April 2015 for S. Roopan-Boldeau

Certified Correct in accordance with Regulation 25 (1) of the Land Surveyors' Regulations 1998,

Checked by . . . . .

*Roopchand Deonanan*

Entered on . . . . .

Trinidad & Tobago Land Surveyor. . . . . 15th April 2015

PATH = ADA004 D:/DEO/S.ROOPAN-BOLDEAU DWG.

