

Process ~~SA~~ 109111
U.P.R.N.....

Address - Road Reserve,
LP#52 Saltmine Trace, Thick Village,
Fyzabad.

Cadastral Sheet G.12.I. 63D
4/a

Ward of Siparia
County of St. Patrick

Registered Deed#200500166999

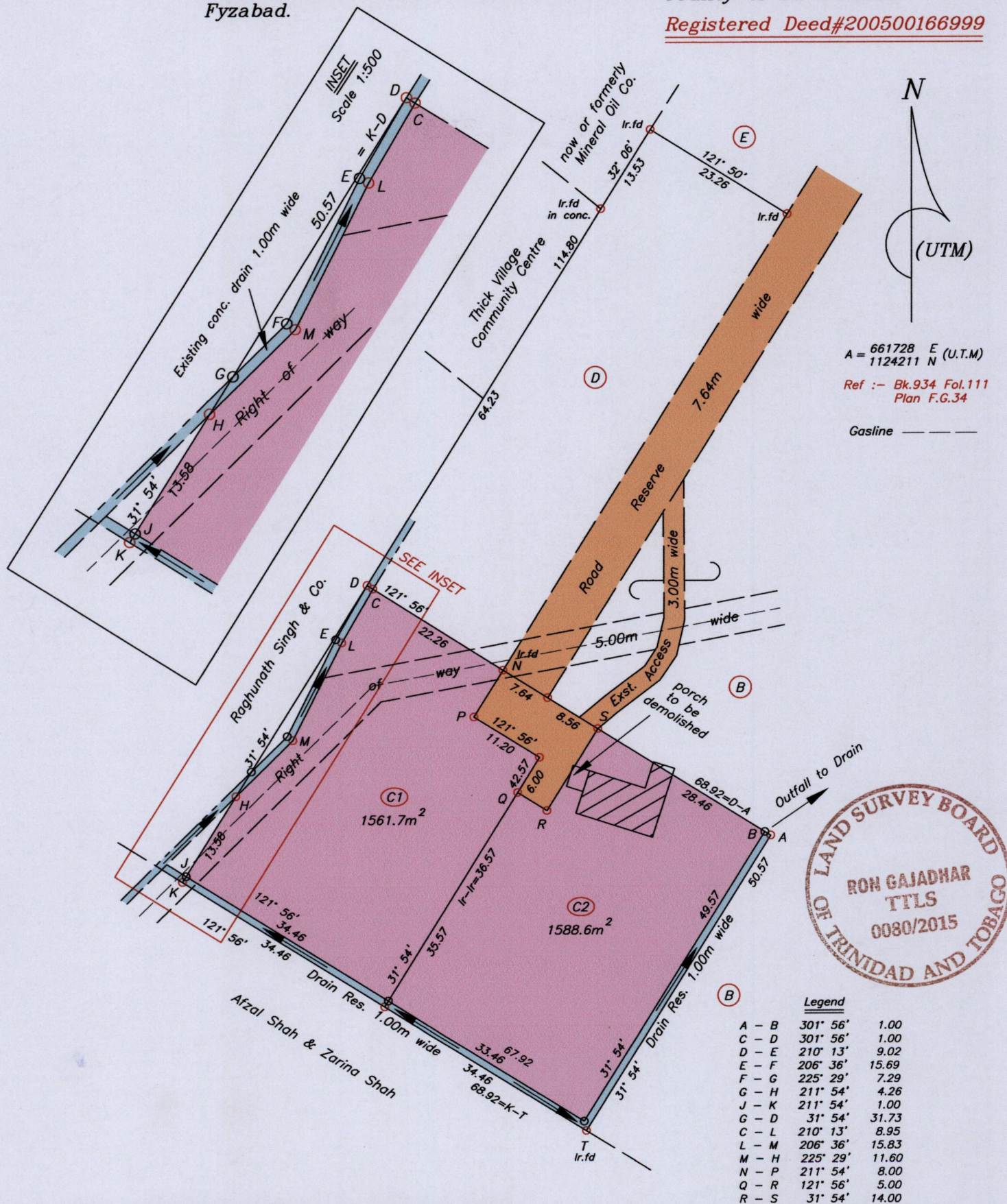

A = 661728 E (U.T.M)
1124211 N (U.T.M)

Ref :- Bk.934 Fol.111
Plan F.G.34

Gasline -----

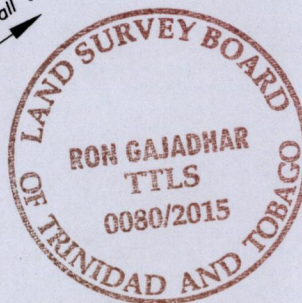

Legend

A - B	301° 56'	1.00
C - D	301° 56'	1.00
D - E	210° 13'	9.02
E - F	206° 36'	15.69
F - G	225° 29'	7.29
G - H	211° 54'	4.26
J - K	211° 54'	1.00
G - D	31° 54'	31.73
C - L	210° 13'	8.95
L - M	206° 36'	15.83
M - H	225° 29'	11.60
N - P	211° 54'	8.00
Q - R	121° 56'	5.00
R - S	31° 54'	14.00

Lot#	Name
C1	Silvan Soobrattie
C2	Hashmin Dipchan

SCALE 1: 750
Distances are in metres

Note - UTM (Nap-Zone 20) Coordinates obtained
from hand held GPS receiver
± 5.00m

- o Denotes no mark put
 - o Denotes Iron put except stated otherwise
- Note: Bearings are U.T.M. grid based on solar observations

Plan of 2 Parcels of land coloured pink in the Ward of Siparia.
Containing together three thousand one hundred and fifty point three square metres.
Surveyed by me, with due authority, in March 2015 for Silvan Soobrattie &
Hashmin Dipchan.

Certified correct in accordance with Regulation 25(1) of the Land Surveyors' Regulations 1998.

Checked by.....

Entered on.....

MINISTRY OF FOOD PRODUCTION
LAND AND MARINE AFFAIRS

APR 13 2015
134
Lands & Surveys Division

Trinidad & Tobago Land Surveyor..... 11/04/..... 2015
L.S.