

U.P.R.N.

A - 659,748mE, 1124,991mN
UTM ZONE 20, Naparima (+/- 4.00M)
Direct Observation-GPS Hand held

SORROSOTEE BLOCK

Bk: 454 Fol: 69

Process *JD* 109108

Cadastral Sheet G. 11. H., 63D
1/d

Ward of Siparia

County of St. Patrick

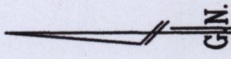

1649

112

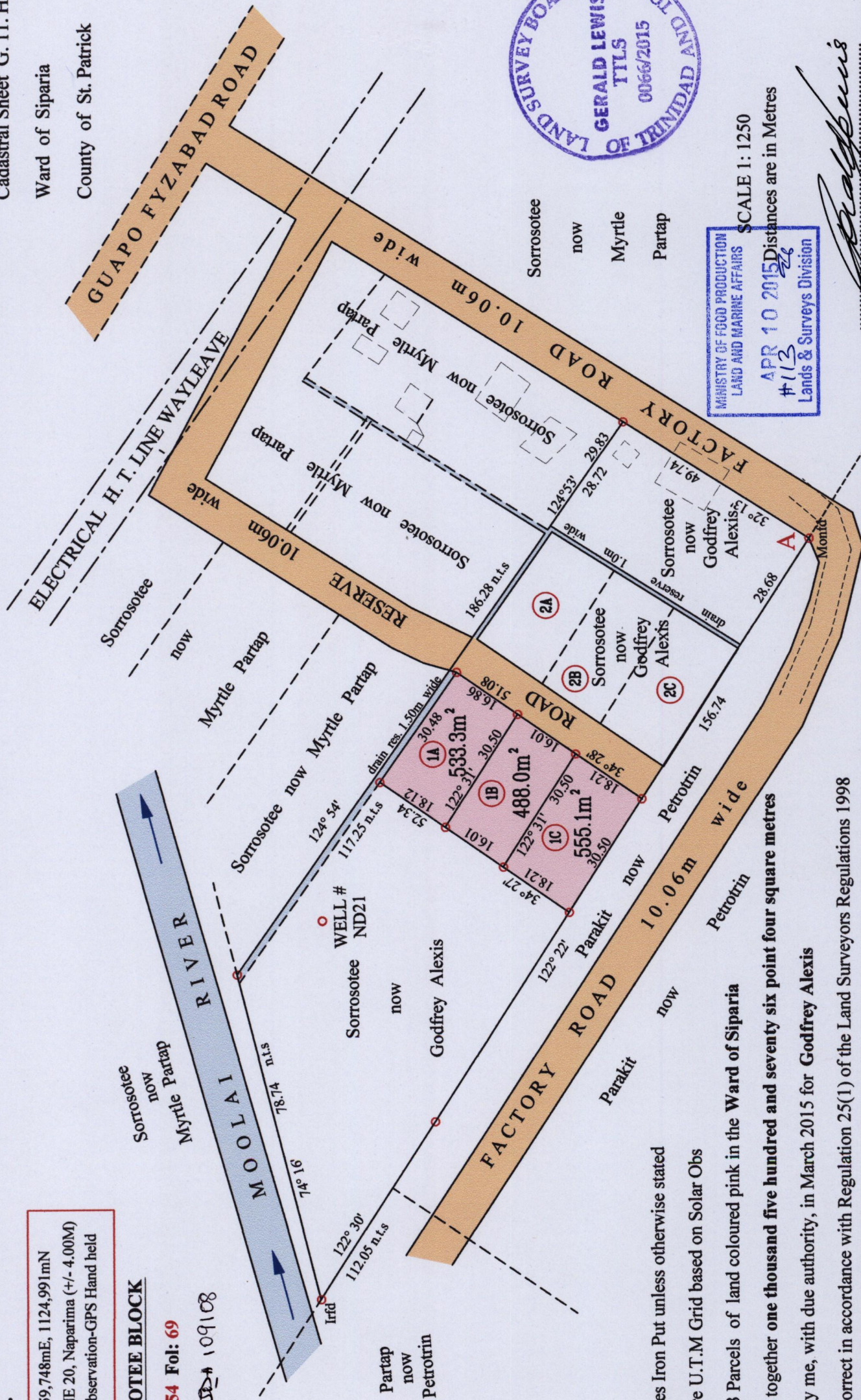

MINISTRY OF FOOD PRODUCTION
LAND AND MARINE AFFAIRS
SCALE 1: 1250
APR 10 2015 Distances are in Metres
#112
Lands & Surveys Division

○ Denotes Iron Put unless otherwise stated

Bearings are U.T.M Grid based on Solar Obs

PLAN of 3 Parcels of land coloured pink in the Ward of Siparia

Containing together one thousand five hundred and seventy six point four square metres

Surveyed by me, with due authority, in March 2015 for Godfrey Alexis

Certified Correct in accordance with Regulation 25(1) of the Land Surveyors Regulations 1998

Entered by

Gerald Lewis

Trinidad & Tobago Land Surveyor 15/03/2015