

R.D.# 4830/1976

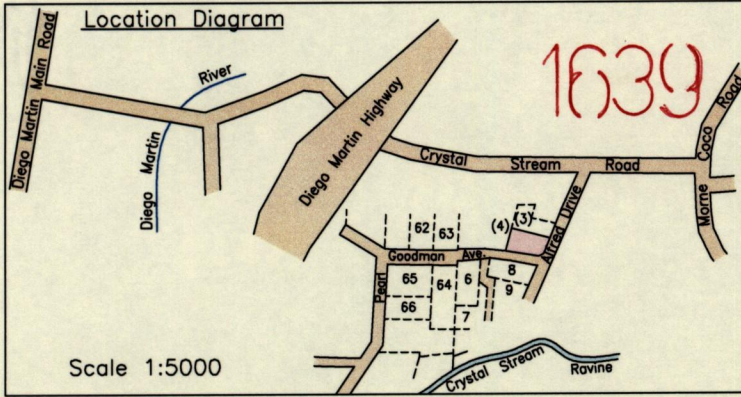

Cadastral Sheet $\frac{13D}{1/a}$ (A.14.P.)
 Ward of Diego Martin
 County of St. George
 Petit Valley

215

Process ID# 109509

G N U.T.M.

From	To	Bearing	Distance
b	c	3° 10'	14.28
c	d	91° 09'	3.69
a	e	152° 53'	7.40

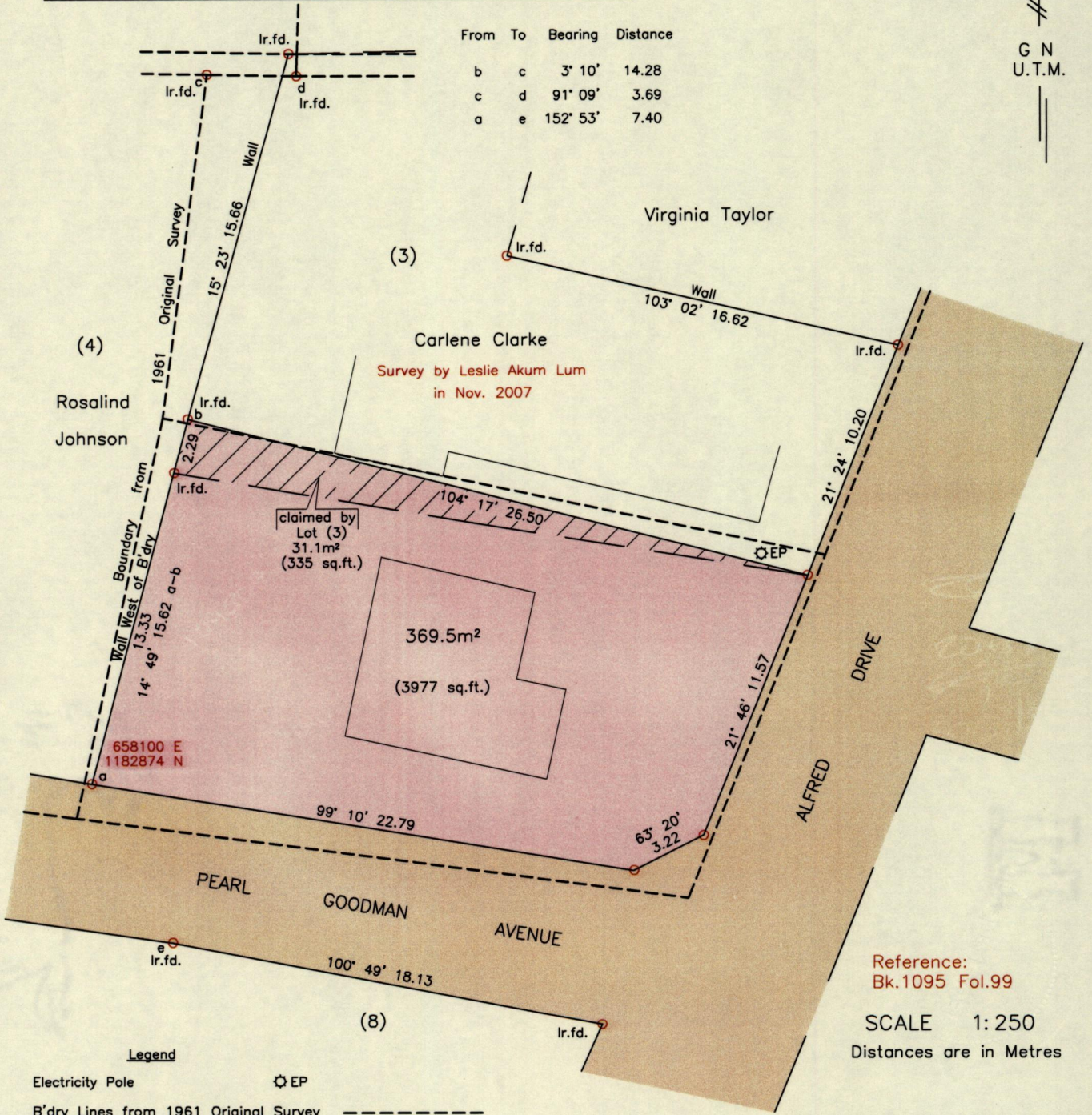

Legend

- Electricity Pole
- B'dry Lines from 1961 Original Survey

Notes: Denotes Ir.pt. unless otherwise indicated
 Bearings are U.T.M. Grid based on Solar Observations
 Original survey by Montague Fahey in Sep. & Oct. 1961 for Sydney Joseph
 Coordinates obtained using handheld GPS (UTM Zone 20, Naparima ± 5.0m)

PLAN of a parcel of land coloured pink in the Ward of Diego Martin
 Containing three hundred and sixty nine point five square metres
 Surveyed by me, with due authority, in April 2015 for Marilyn Mitchell-Richards
 Certified Correct in accordance with Regulation 25(1) of the Land Surveyors Regulations 1998

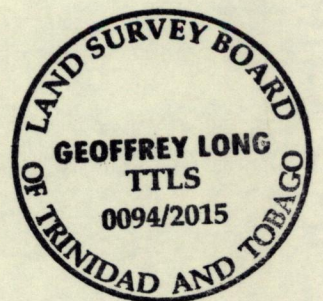

Checked by

Entered on

Geoffrey Long

 Trinidad and Tobago Land Surveyor, *18th May* 2015

