

1639

204

Process JD# 109395

Cadastral Sheet A15N. ^{13D}/_{2/b}
Ward of Diego Martin
County of St. George

Maraval

G N
U.T.M.

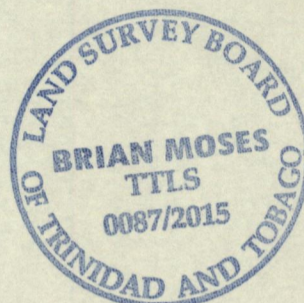
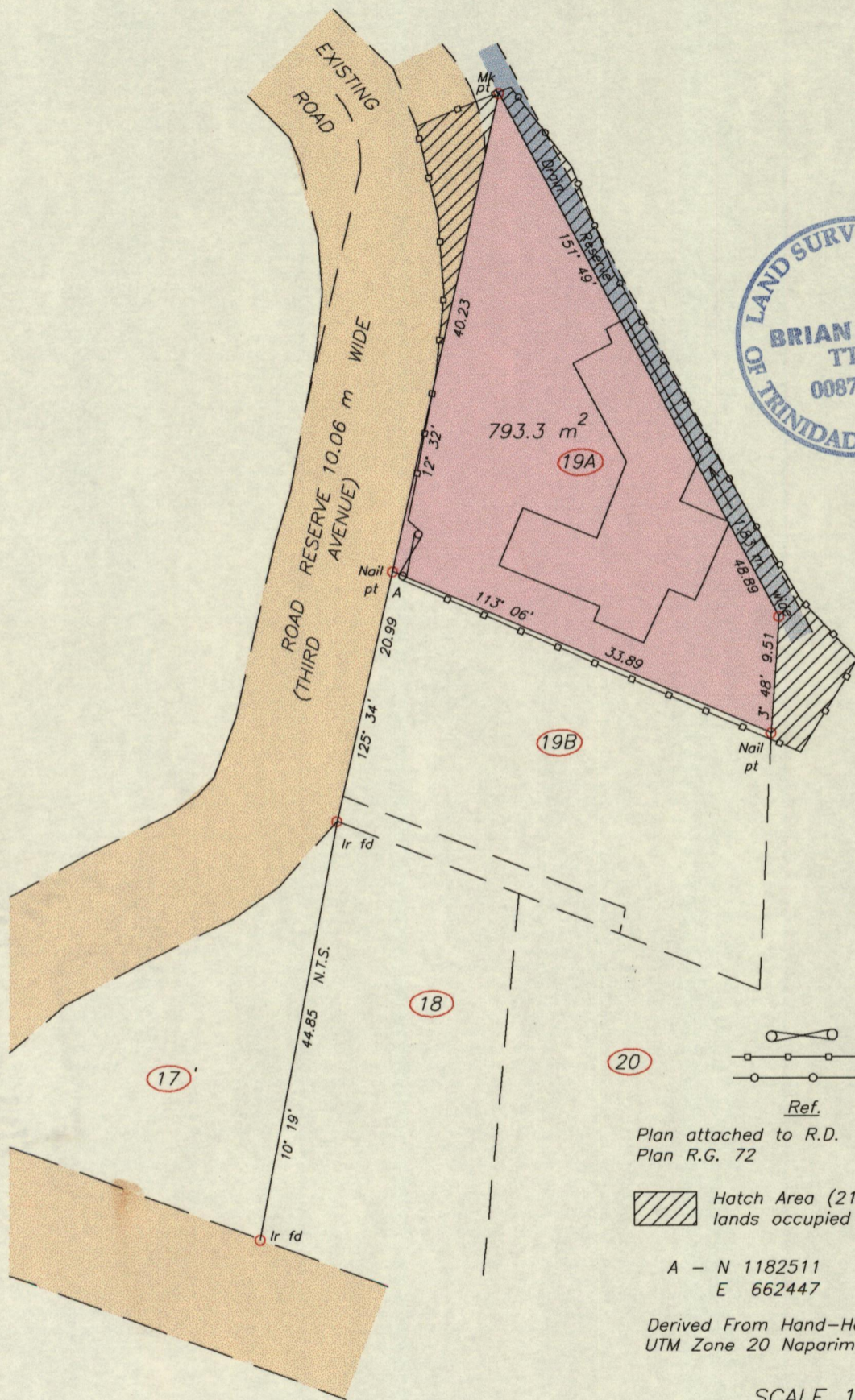

Now or Formerly
Ginger T.
Development
Company Ltd.

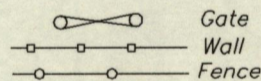

Ref.

Plan attached to R.D. 18377 of 1978
Plan R.G. 72

Hatch Area (2100 ft²) denotes
lands occupied by lot 19 A

A - N 1182511
E 662447

Derived From Hand-Held GPS (+/-5 m)
UTM Zone 20 Naparima Co-ordinates

SCALE 1:500

Distances are in METRES

o Denotes Iron put unless otherwise stated
Bearings are U.T.M. Grid based on Solar observations

PLAN of a Parcel of land coloured pink in the Ward of Diego Martin
Containing seven nine three point three square metres
Surveyed by me, with due authority, in April, 2015 for Jean-Maurice Ferdinand
Certified Correct in accordance with Regulation 25 (1) of the Land Surveyors'
Regulations 1998

Entered

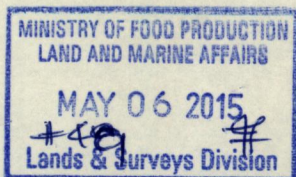

Brian Moses

Trinidad & Tobago Land Surveyor (T.T.L.S.)

4th May 2015