

1639

201

Process IDA 109146

U.P.R.N No.....

Cadastral Sheet A.15 J. 13A

Ward of Diego Martin

County of St. George

MARAVAL

Reg. Deed No.13969/1986

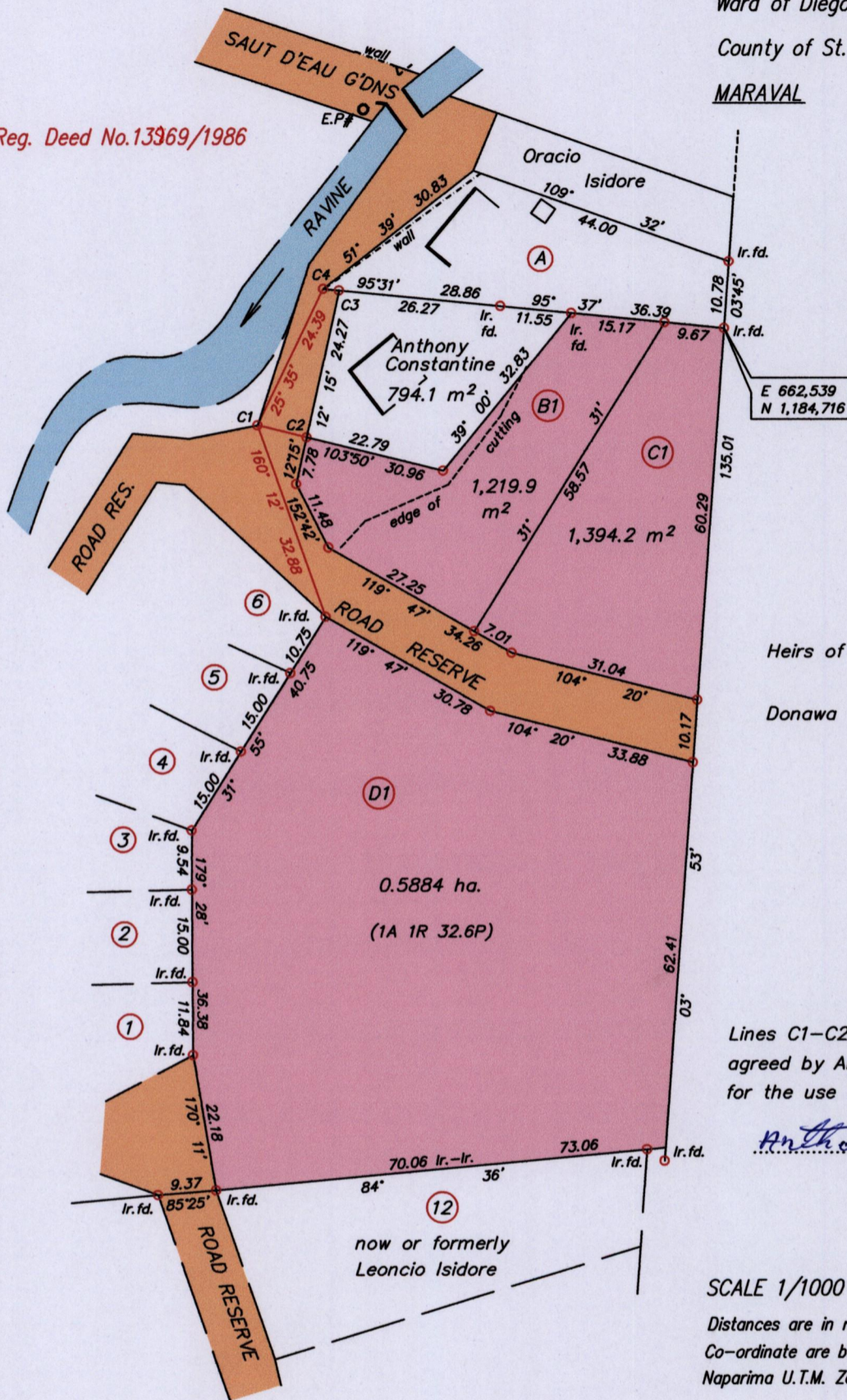

Heirs of Donawa

Lines C1-C2, C2-C3, C3-C4 and C4-C1 agreed by Anthony Constantine for the use of a Road Reserve

Anthony Constantine

SCALE 1/1000

Distances are in metres
Co-ordinate are based on hand held GPS
Naparima U.T.M. Zone 20 +/- 3.00m

Bearings are Cassini Grid based on Solar Observations

Note : To obtain U.T.M. bearings subtract 19 minutes

Plan of 3 Parcels of land coloured pink in the Ward of Diego Martin
Containing together zero point eight four nine eight hectare

Surveyed by me, with due authority in April 2012 for Oracio Isidore

Certify Correct in accordance with Regulation 25 (1) of the Land Surveyors' Regulations 1998

H. Somarsingh

Entered on..... Trinidad and Tobago Land Surveyor..... 17th April

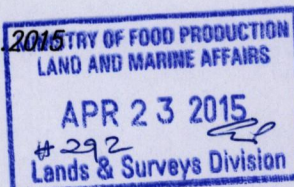
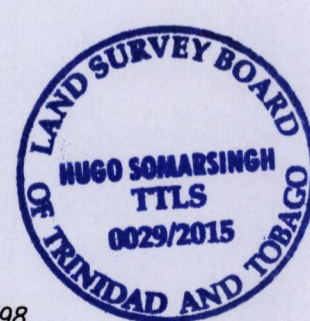

443