

1639

192

Process ID# 109135

12F

Location Diagram

Cadastral Sheet 2/d (A.19.C.)

Ward of Diego Martin  
County of St. George

Site T006J - WASA  
Westmoorings

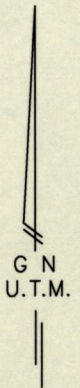
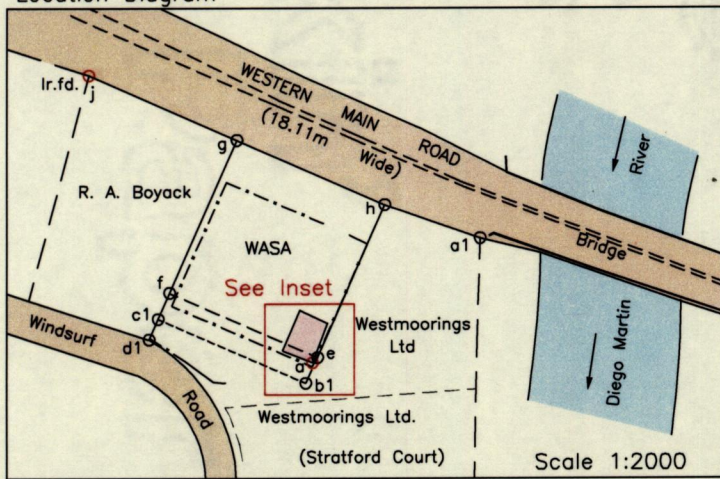

INSET

From	To	Bearing	Distance
c	d	113° 43'	8.47
d	e	113° 43'	0.78
e	h	23° 43'	44.20
g	h	113° 43'	42.67
f	e	113° 43'	42.67
f	g	23° 43'	44.20
h	a1	109° 18'	26.88
a	b1	198° 00'	5.80
c1	b1	113° 42'	42.55
b1	h	23° 50'	51.75
c1	d1	23° 42'	5.95
j	g	113° 48'	42.89

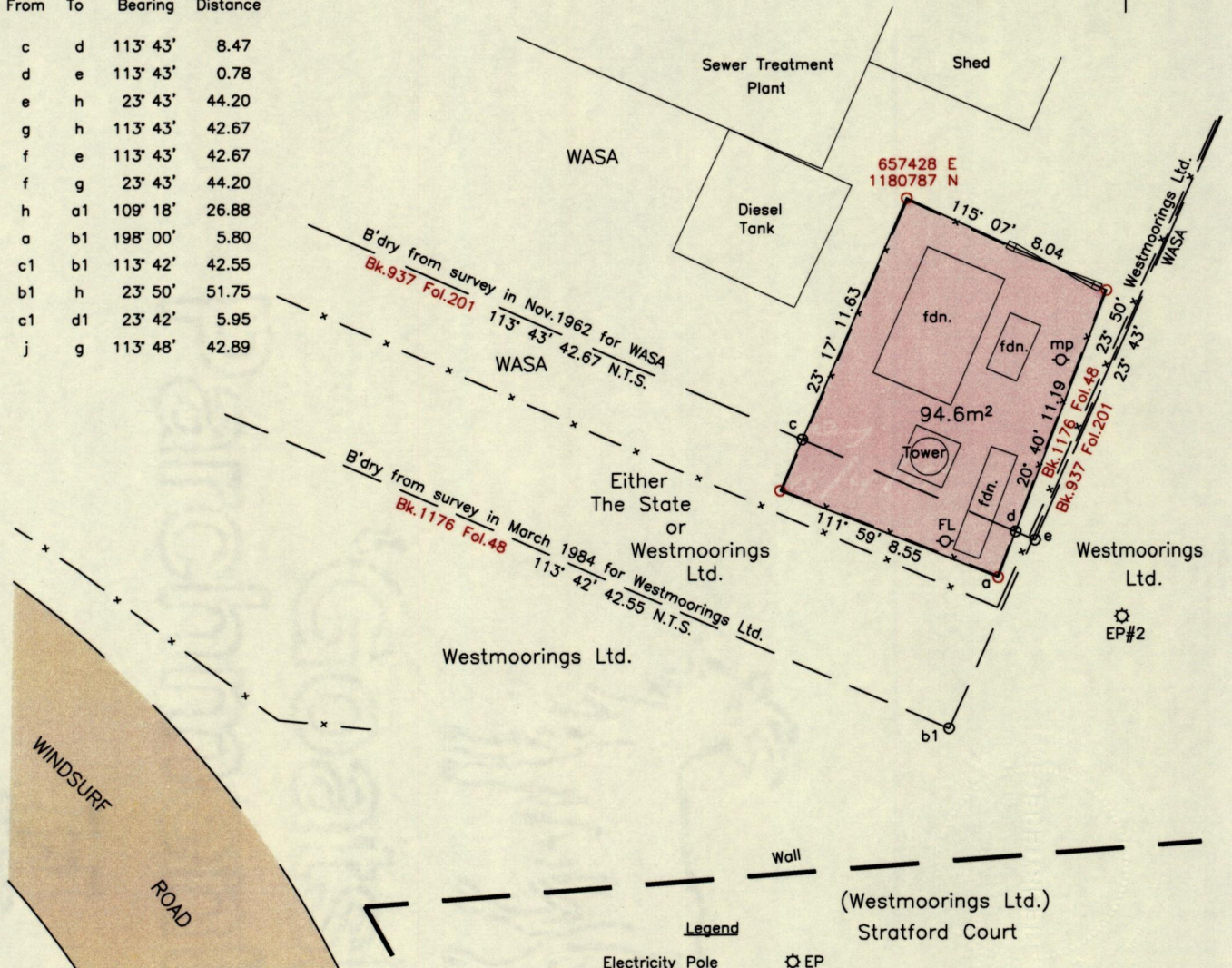

References:  
 Bk.937 Fol.201  
 Bk.1176 Fol.148  
 Bk.1104 Fol.180

**Legend**

Electricity Pole	⊙ EP
Meter Pole	⊙ mp
Flood Light	⊙ FL
Gate	⏏
Foundation	fdn.
Fence	— x — x —

SCALE 1:250  
 Distances are in metres

Notes: ○ Denotes Fence Post unless otherwise stated  
 ○ c,d,e,f,g,h,a1,b1,c1,d1 = No Mark put  
 Bearings are U.T.M. Grid based on Solar Observations  
 Previous survey by Ron Gajadhar in Jan. 2007 for Site Acquisition Services Ltd.  
 Coordinates obtained using handheld GPS (UTM Zone 20, Naparima ± 5.0m)

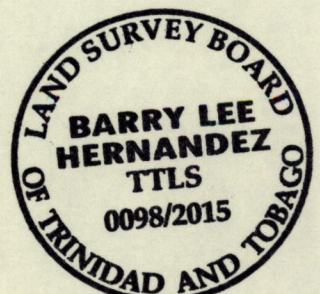

PLAN of a parcel of land coloured pink in the Ward of Diego Martin  
 Containing ninety four point six square metres  
 Surveyed by me, with due authority, in September 2014 for Digicel (Trinidad & Tobago) Ltd.  
 Certified Correct in accordance with Regulation 25(1) of the Land Surveyors Regulations 1998.

Checked by .....  
 Entered on .....  
 Trinidad and Tobago Land Surveyor, 15<sup>th</sup> Apr

