

1332

03

R.P.O. Vol. 46 Fol. 163
C.T. Vol. 3264 Fol. 33
Vol. 5117 Fol. 483

Cadastral Sheet G.12.G. $\frac{63D}{2/d}$, $\frac{63E}{1/c}$
Ward of Siparia
County of St. Patrick
Vide: Bk. 1163 Fol. 143

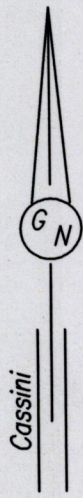
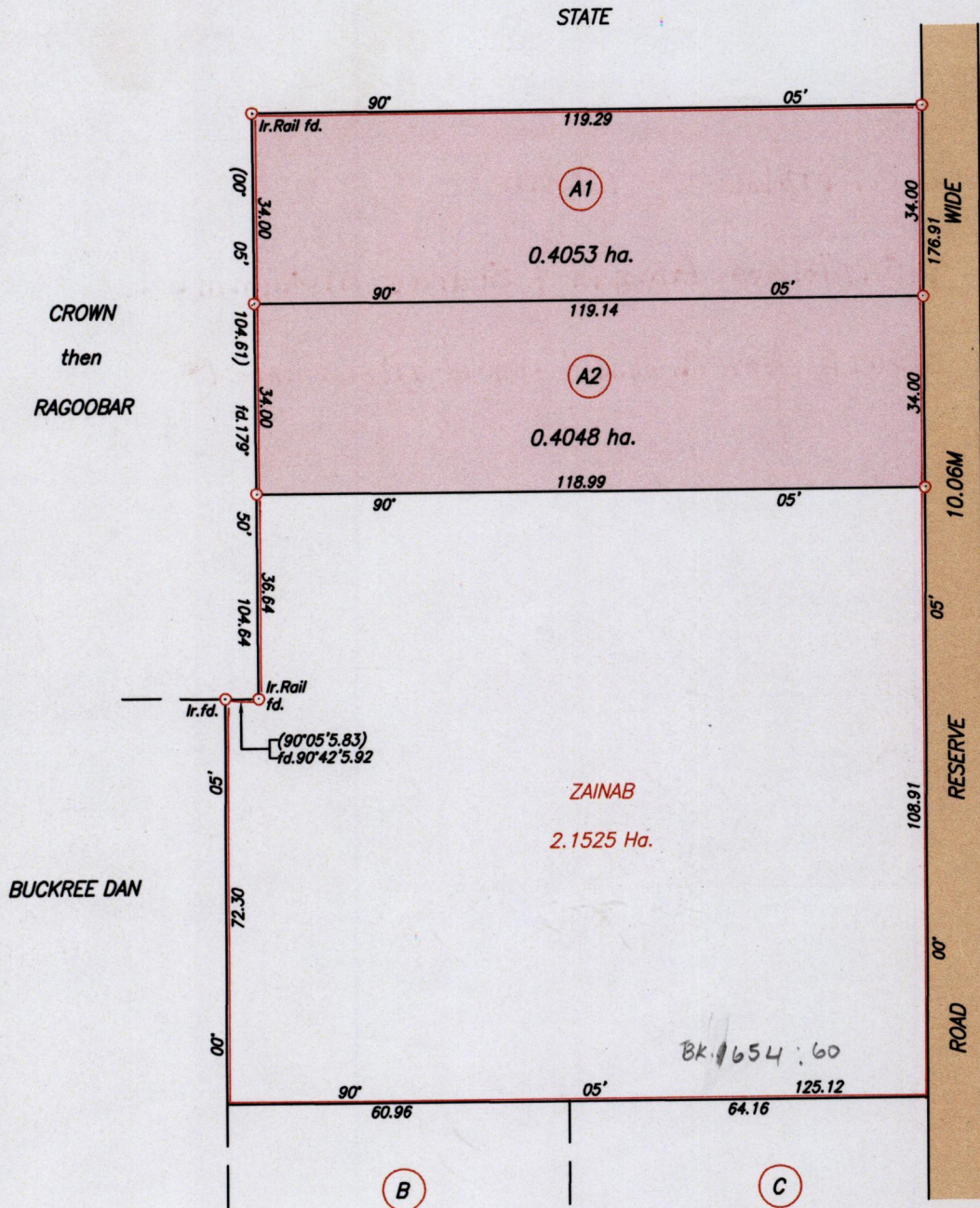

Orig - Bk. 1163:143

Approved *[Signature]*
Director of Surveys
25.01.2004

SCALE 1/1250
Distances are in metres

○ Denotes Iron put except otherwise stated
Bearings are Cassini Grid based on Solar Observations
Plan of 2 Parcels of land coloured pink in the Ward of Siparia
Containing together zero point eight one zero one hectare
Surveyed by me, with due authority, on March 16th. 2004
In accordance with Regulation 25 (1) of the Land Surveyors' Regulations 1998,
I certify that this plan is correct.



Entered on
Checked by *[Signature]* Trinidad & Tobago Land Surveyor 2007
Date 17/10/07 90/9

Lot No.	CT & Volume	NAME
A1	Vol 5117 Fol 489	Amzad & Sourav Mohammed.
A2	Vol 5117 Fol. 497	Arshad & Ameer Mohammed

