

1623

Ward of Turure

County of St. Andrew

Cadastral Sheet E 2 C, $\frac{25 F}{4d}$

1834

Process ID#109616

G N

U.T.M.

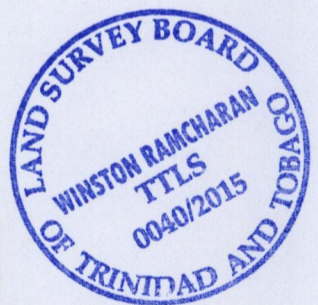
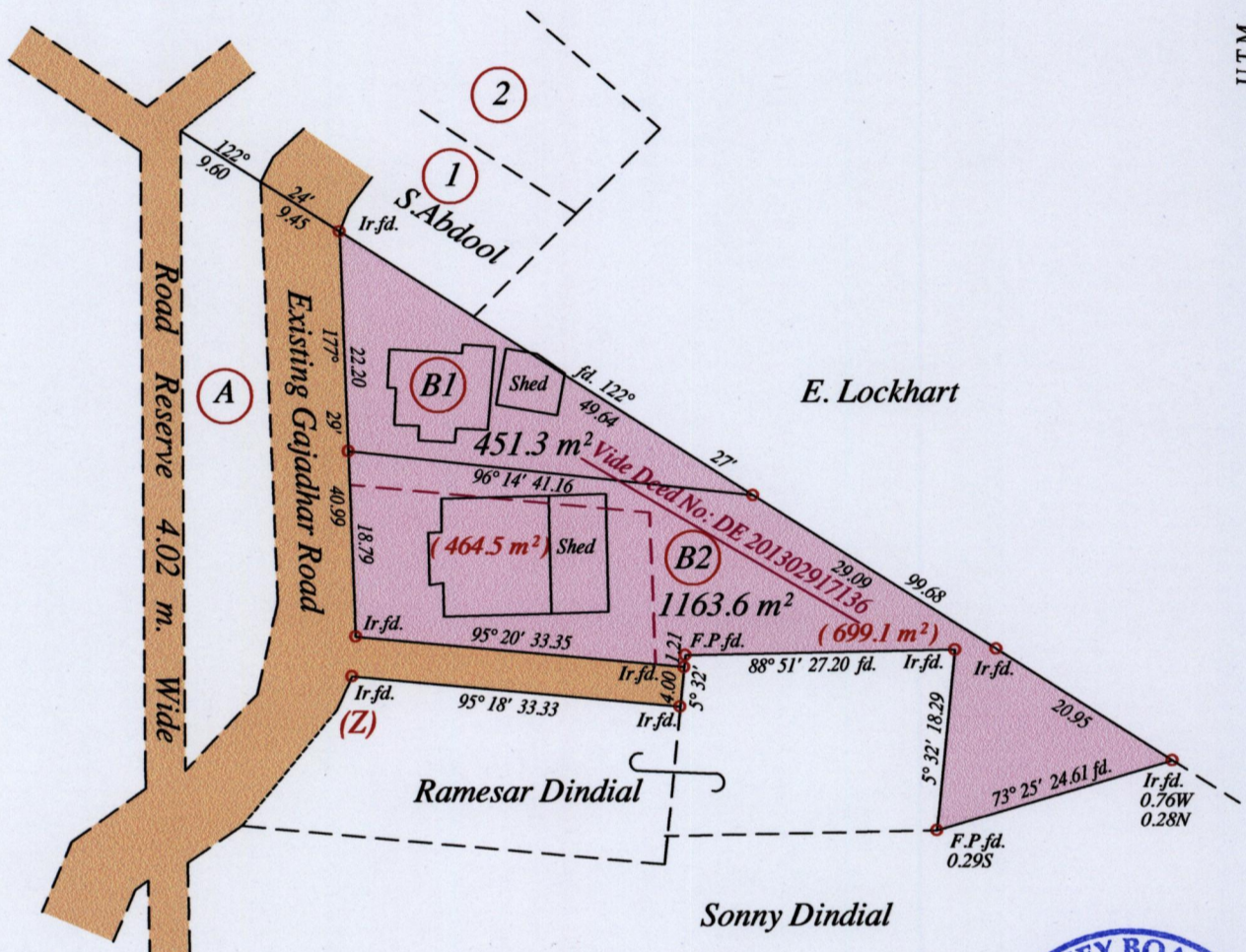

(Z) N: 1167810
 (Z) E: 707174
 Hand Held GPS.
 Naparima Datum (+/- 5m.)
 UTM Zone 20.

Vide Bk. 1212 fol. 12

o Denotes Iron put except stated otherwise.

SCALE : 1:750

Note: Bearings are U.T.M. grid based on solar observations

Distances are in metres

PLAN of 2 Parcels of land coloured pink in the Ward of Turure

Containing together one thousand six hundred and fourteen point nine square metres

Surveyed by me, with due authority, in May 2015 for (B1) Swaranjit Indar Dindial & (B2) Sonny Dindial

Certified correct in accordance with Regulation 25 (1) of the Land Surveyor's Regulations 1998.

Entered:

Winston Ramcharan

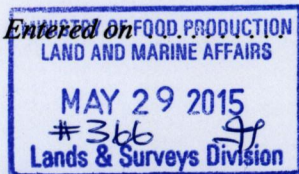

Trinidad & Tobago Land Surveyor 27th May... 2015

36P42CP