

1623

170

Process ID#109532

Cadastral Sheet C.18.E. <sup>16D</sup>/<sub>3/b</sub>

Ward of Matura.

County of St. Andrew.

Matura

G N  
U.T.M

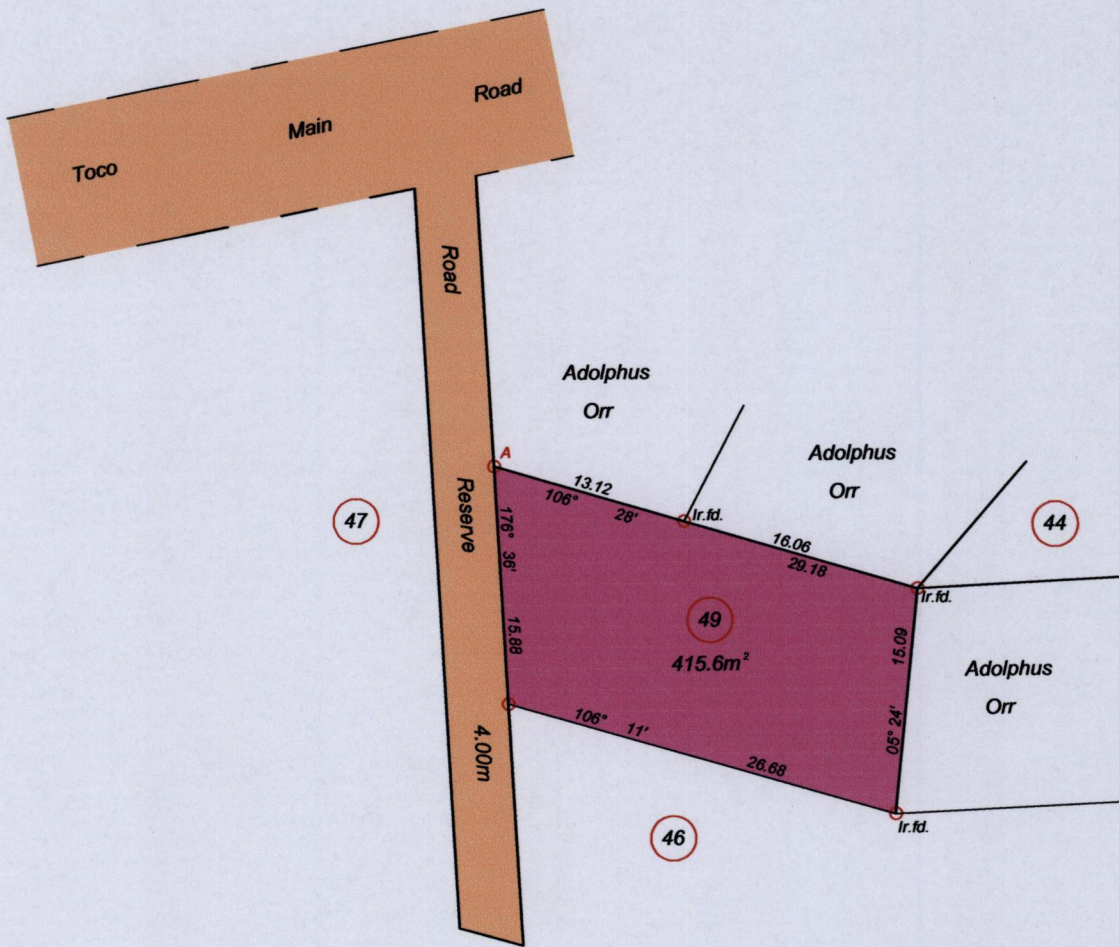

Ref: BK 1002 Fol 164

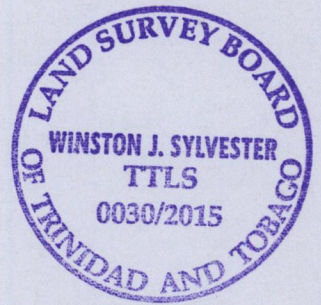

Note : Coordinates obtained by hand held G.P.S.

Naparima UTM Zone 20 (+/-) 5m A=E-711019 N-1180086

o Denotes iron put unless otherwise stated

SCALE: 1/500

Bearings based on solar observations .

Note : To obtain compass bearing add minutes Distances are in metres.

PLAN of a parcels of land coloured pink in the Ward of Matura.

Containing Four Hundred and Fifteen point Six square metres

Surveyed by me, with due authority, in May 2015 for Joyce Ross

Certified Correct in accordance with Regulation 25 (1) of The Land Surveyors Regulation 1998.

Entered:

*[Handwritten signature]*

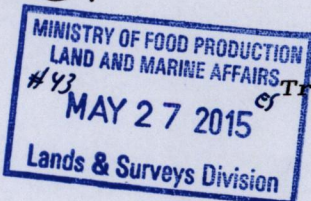

Trinidad & Tobago Land Surveyor 26-5-2015