

Process ID# 109130

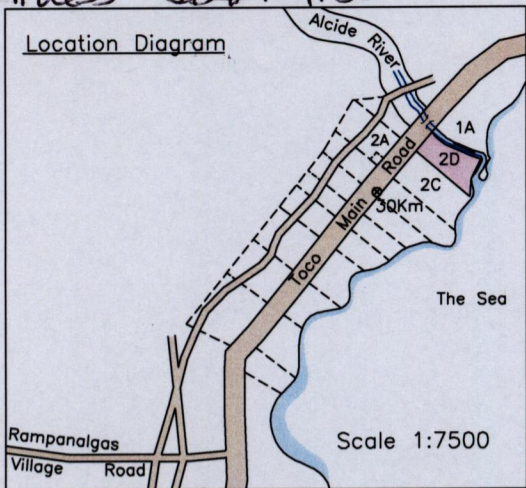

16C  
 Cadastral Sheet 1/d C.14.B.  
 Ward of Matura  
 County of St. Andrew  
 Rampanalgas

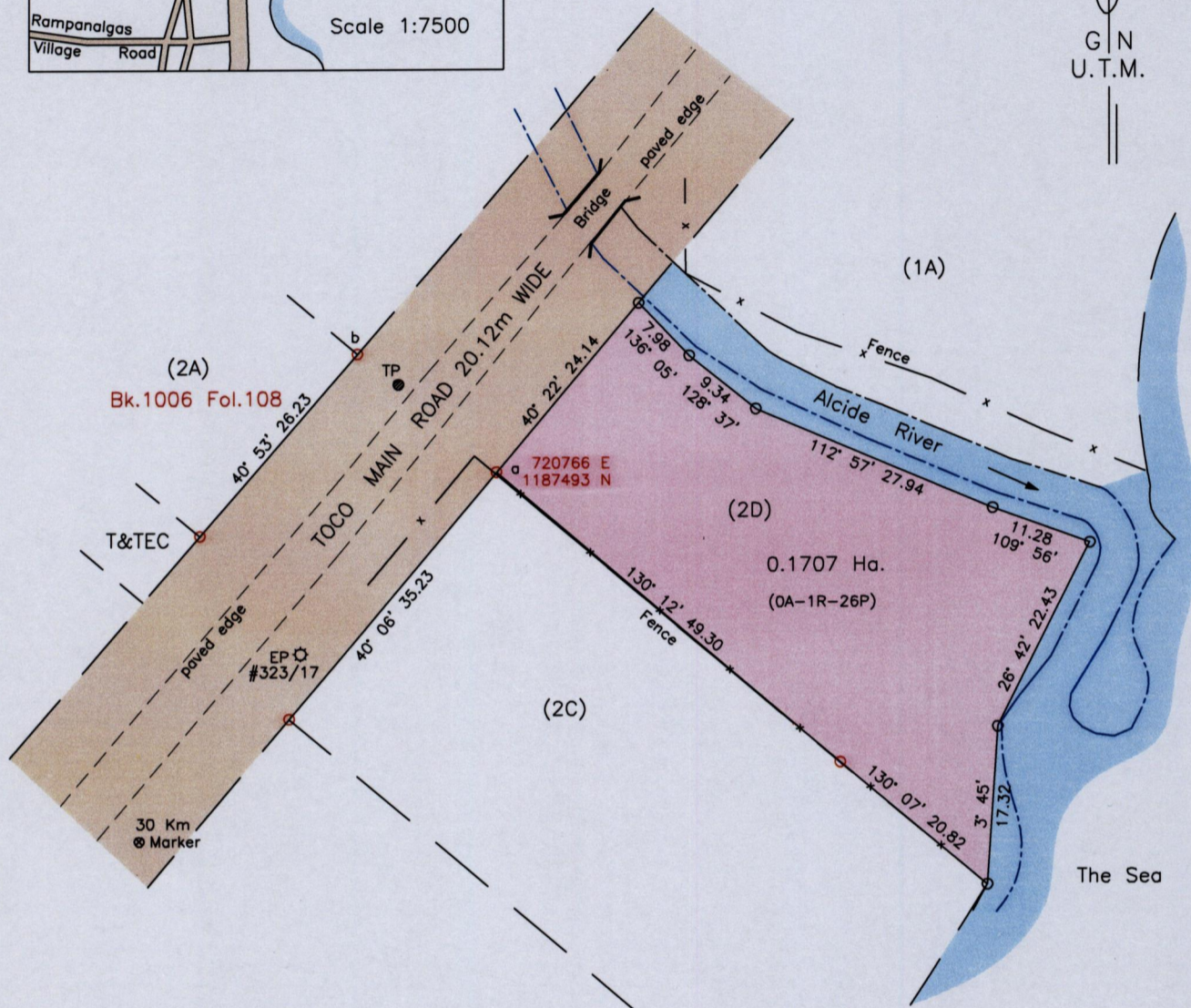
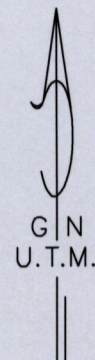

Legend

References:  
 PLAN C.N.113  
 PLAN X.D.18

- Electricity Pole      ⚡ EP
- Telephone Pole      ● TP

SCALE 1:750  
 Distances are in METRES

- Notes:
- Denotes Ir.f.d. unless otherwise indicated
  - Denotes No Mark put
  - Boundary along the Alcide River was acquired using 3.7m offset from center
  - Bearings are U.T.M. Grid based on Solar Observations
  - Coordinates obtained by handheld GPS (UTM Zone 20, Naparima ± 5.0m)

PLAN of a parcel of land coloured pink in the Ward of Matura  
 Containing zero point one seven zero seven hectares  
 Surveyed by me, with due authority, in April 2015 for John Jeremie  
 Certified Correct in accordance with Regulation 25(1) of the Land Surveyors Regulations 1998.



Checked by .....

Entered on .....

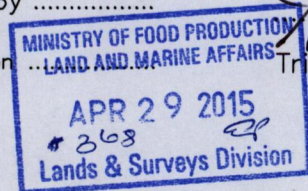

*John de Sormeaux*

Trinidad and Tobago Land Surveyor, 27<sup>th</sup> April 2015.