

Process JD4109128

Ward of Turure

County of St. Andrews

Vide Plan P.G.86

Bk.1288 fol.44

G N Cassini

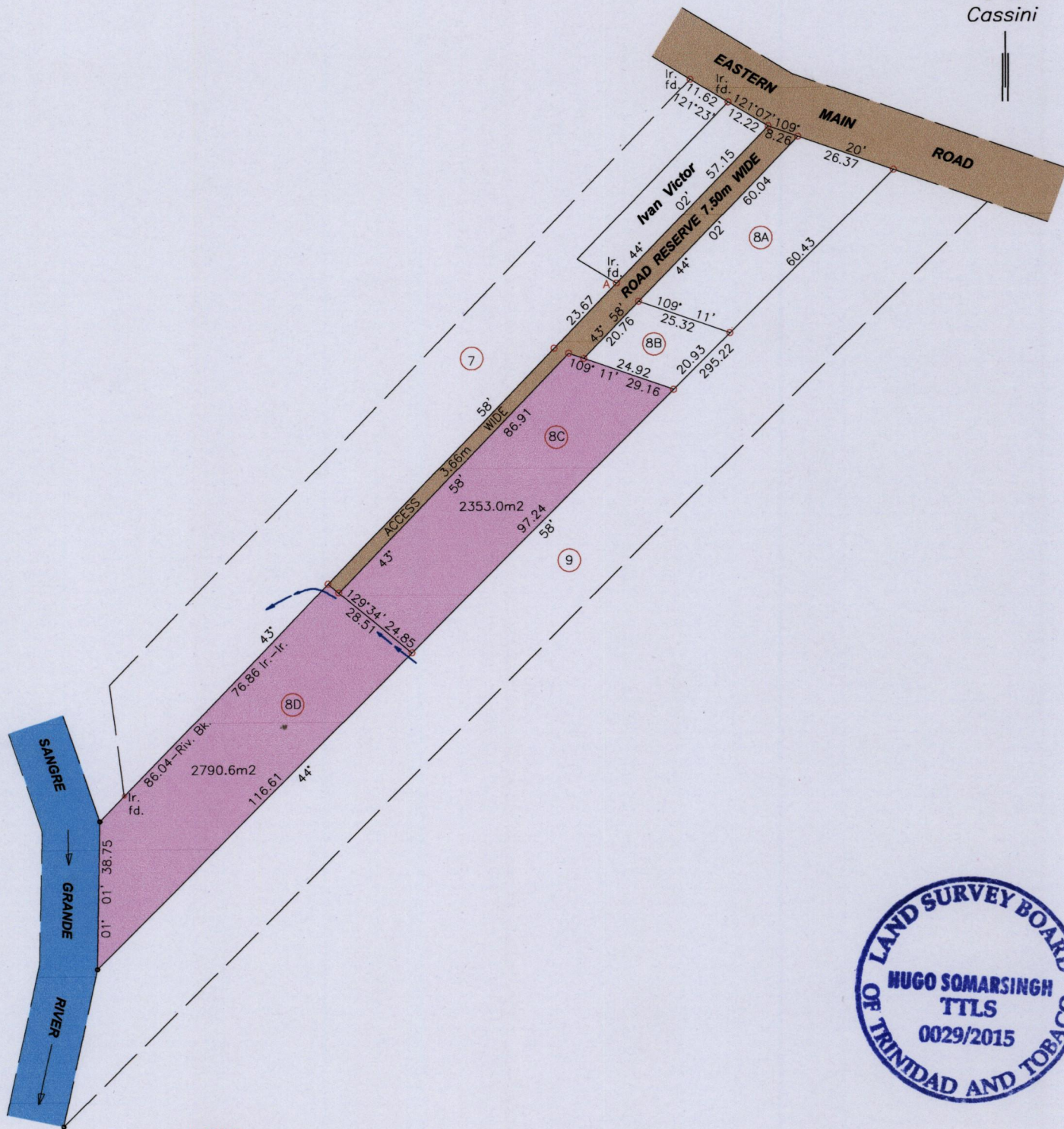

A-N 1168906
A-E 706213



Coordinates are obtained by hand held G.P.S. W.G.S. 84 U.T.M. Zone 20 (±) 5m.

SCALE 1:1500

Distances are in METRES

- Denotes Iron put unless otherwise stated
- Bearings are Cassini Grid based on Solar observations
- To obtain compass bearings subtract/add minutes.

PLAN of 2 Parcels of land coloured pink in the Ward of Turure. Containing together zero point five one four four hectares. Surveyed by me, with due authority, in January, 2015 for Certified correct In accordance with Regulation 25 (1) of the Land Surveyors' Regulations 1998,

Hugo Somarsingh T.T.L.S.

Trinidad & Tobago Land Surveyor 28th April 2015

Entered

