

No 25406

Vol. 4987 Fol. 225

R.P.O. Vol. 92.

Fol. 137.

C.T. Vol.

Fol.

Ward of Tamana.

County of St. Andrew.

Cadastral Sheet E. I. Q

35B  
17d

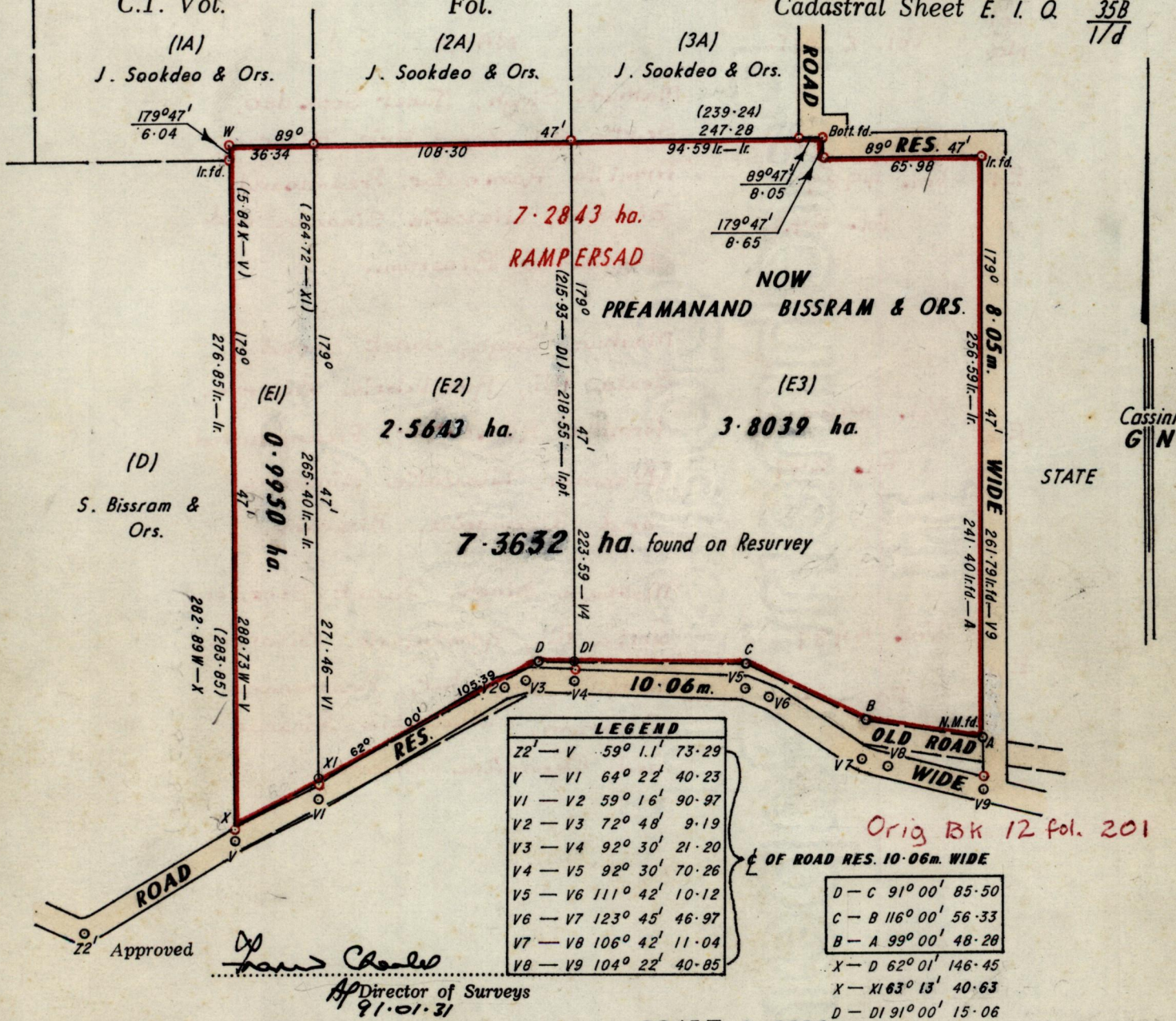

o Denotes Iron put except otherwise stated.

Note: To obtain compass bearings add/minutes

SCALE 1:2500.

Distances are in metres.

PLAN of 3 Parcels of land coloured pink in the Ward of Tamana.

Containing together seven point three six three two hectares.

Surveyed by me, with due authority, in September 1989.

I certify that I have complied with rule 76 under section 14(2)(d) of the Land Surveyors' Ordinance 1952, and that this plan is correct.

Checked by *[Signature]* *[Signature]*

Entered ..... Land Surveyor, Trinidad 10<sup>th</sup> October 1989 and Tobago



Rampersad

7.2843 ha

Red

Original Survey Bk 12 Fol. 201

7.41715 ha  
found on Resurvey  
Black

| Lot No. | Vol. & c.T.           | NAME  |
|---------|-----------------------|---|
| E1      | Vol. 4987<br>Fol. 243 | Mathura Singh, Janet Sookdeo,<br>Seeta Ali, Ramdularie Bissram,<br>Armilla Ramoutar, Preamanand<br>Bissram, Lilawatie Sinanan and<br>Deonarine Bissram. |
| E2      | Vol. 4987<br>Fol. 247 | Mathura Singh, Janet Sookdeo,<br>Seeta Ali, Ramdularie Bissram,<br>Armilla Ramoutar, Preamanand<br>Bissram, Lilawatie Sinanan<br>and Deonarine Bissram. |
| E3      | Vol. 4987<br>Fol. 249 | Mathura Singh, Janet Sookdeo,<br>Seeta Ali, Ramdularie Bissram,<br>Armilla Ramoutar, Preamanand<br>Bissram, Lilawatie Sinanan<br>and Deonarine Bissram. |