

Vol. 5139 Fol. 117

C.T. Vol. 2690 Fol. 33

C.T. Vol. 3639 Fol. 167B

U.P.R.N. No.:

Ward of Savana Grande

County of Victoria

Cadastral Sheet G.14.D. & H. $\frac{64D}{2/b, 2/d}$

Consolidated Plan Filed in Vol. 2690 Fol. 31

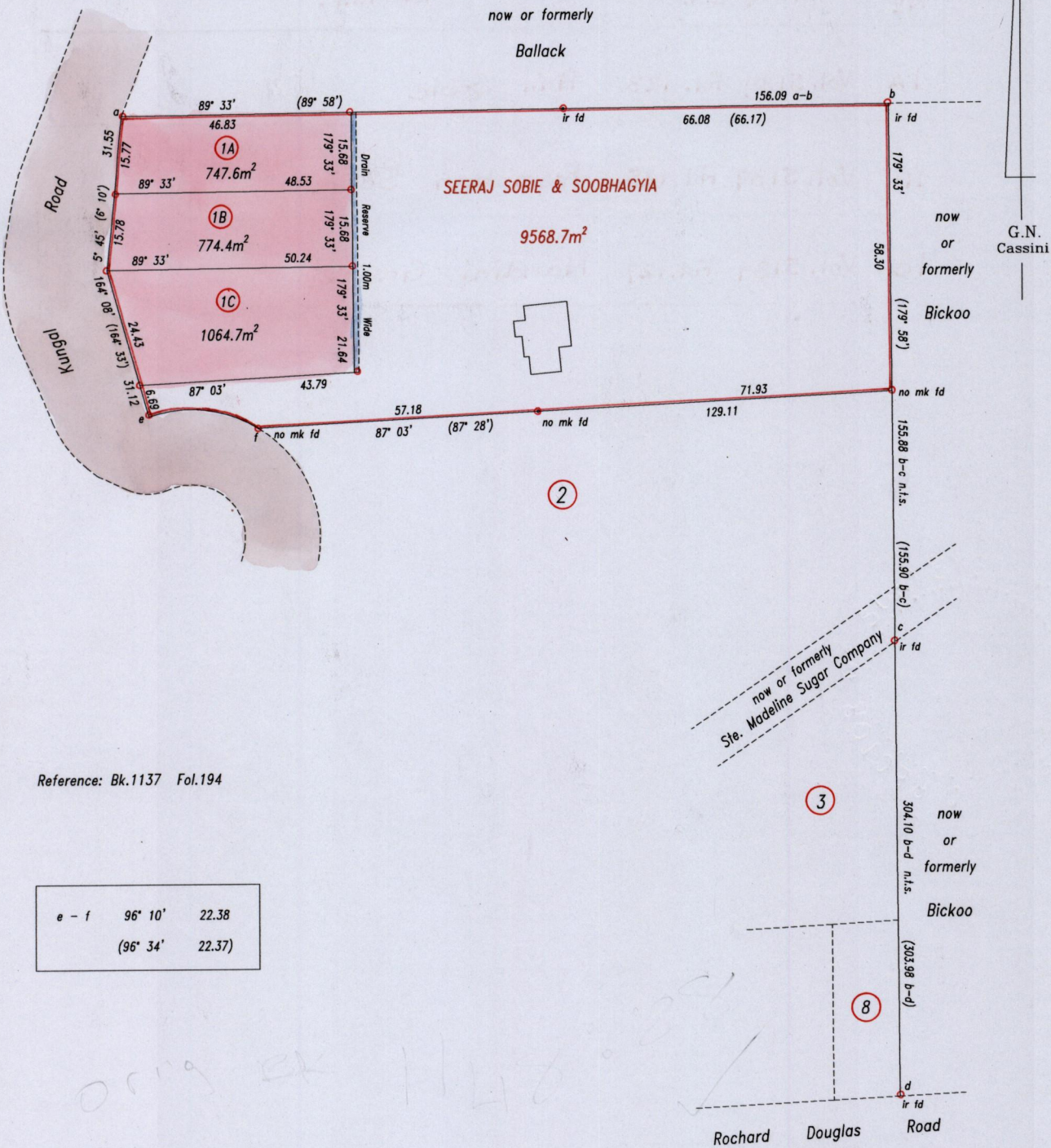

Reference: Bk.1137 Fol.194

e - f	96° 10'	22.38
	(96° 34')	22.37

Approved

Lynn Roopchand
 Director of Surveys
 2006-5-5

Bearings are Cassini Grid based on Solar Observations

PLAN of 3 parcels of land coloured pink in the Ward of Savana Grande
 Containing together two thousand five hundred and eighty six point seven square metres
 Surveyed by me, with due authority, in March 2004

In accordance with Regulation 25(1) of the Land Surveyors' Regulations 1998, I certify that this plan is correct.

Checked by *Helv 1/5/06*
 Entered

L. A. Roopchand
 Trinidad & Tobago Land Surveyor 20/4/2005

SCALE 1: 1250

Distances are in metres

○ Denotes iron put except otherwise stated

Orig BK. 1148 : 88

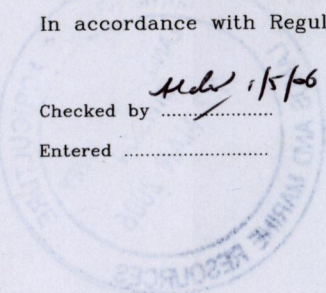

Lot No	Vol. & C.T.	NAMES.
1A	Vol. 5139 Fol. 123	Anil Sobie
1B	Vol. 5139 Fol. 125	Premchan Sobie
1c	Vol. 5139 Fol. 127	Nandini Gosine



1358/277