

R.P.O. Vol. 1804 Fol. 45

Vol. 5121 Fol. 135

Cadastral Sheet B.24.L. $\frac{24C}{3/d}$

County of St. George
Borough of Arima

Industrial
Development
Corporation

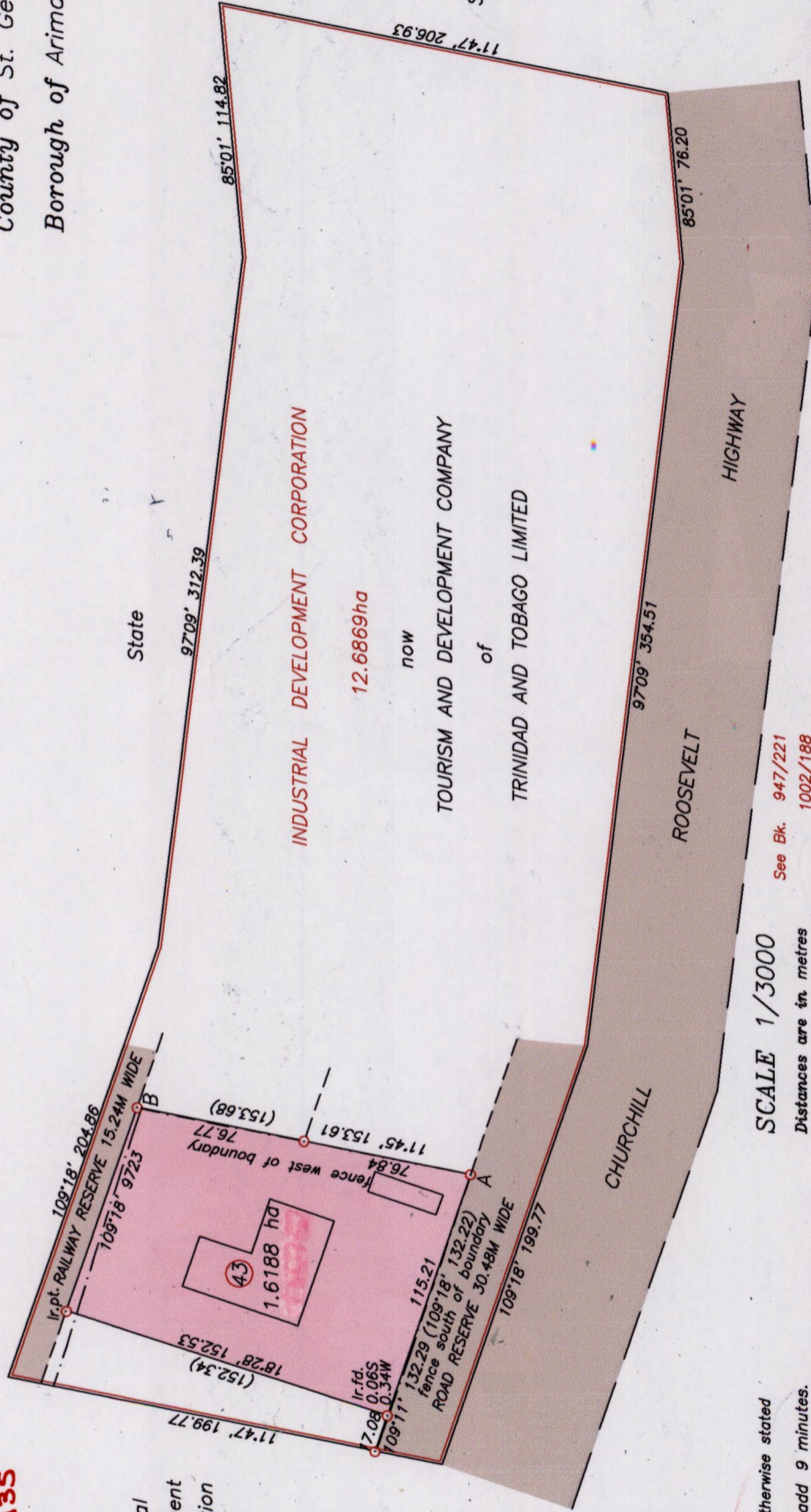

G N
Cassini

State

State

INDUSTRIAL DEVELOPMENT CORPORATION

12.6869ha

now

TOURISM AND DEVELOPMENT COMPANY

of

TRINIDAD AND TOBAGO LIMITED

ROOSEVELT

HIGHWAY

CHURCHILL

SCALE 1/3000

See Bk. 947/221

1002/188

Distances are in metres

Approved *Yvonne Gens*
Director of Surveys
2007 04 30

--- wire fence
○ denotes iron found except where otherwise stated
Note: To obtain compass bearings add 9 minutes.

PLAN of a Parcel of land coloured Pink in the Borough of Arima

Containing one point six one eight eight hectares

Surveyed by me, with due authority, in February 2007

In accordance with Regulation 25 (1) of the Land Surveyors' Regulations 1998,

I certify that this plan is correct.

Checked by *Justin Baptiste* 2/14/07

Entered..... Trinidad & Tobago Land Surveyor..... 15th March 2007



Orig - Bk. 1002:188

1332

96

Original Bk. 1002:188

