

Cadastral Sheet E.2.1. 35C  
1/b  
Ward of Turure  
County of St. Andrew

Wide Plan R.H.101  
Bk.1179 Fol.9  
Bk.171 Fol.8

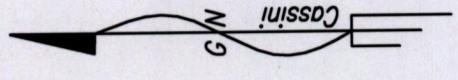

REMAINING PORTION

R.P.O. Vol. 67 Fol. 533  
C.T. Vol. 1894 Fol. 57  
Vol. 5094 Fol. 147

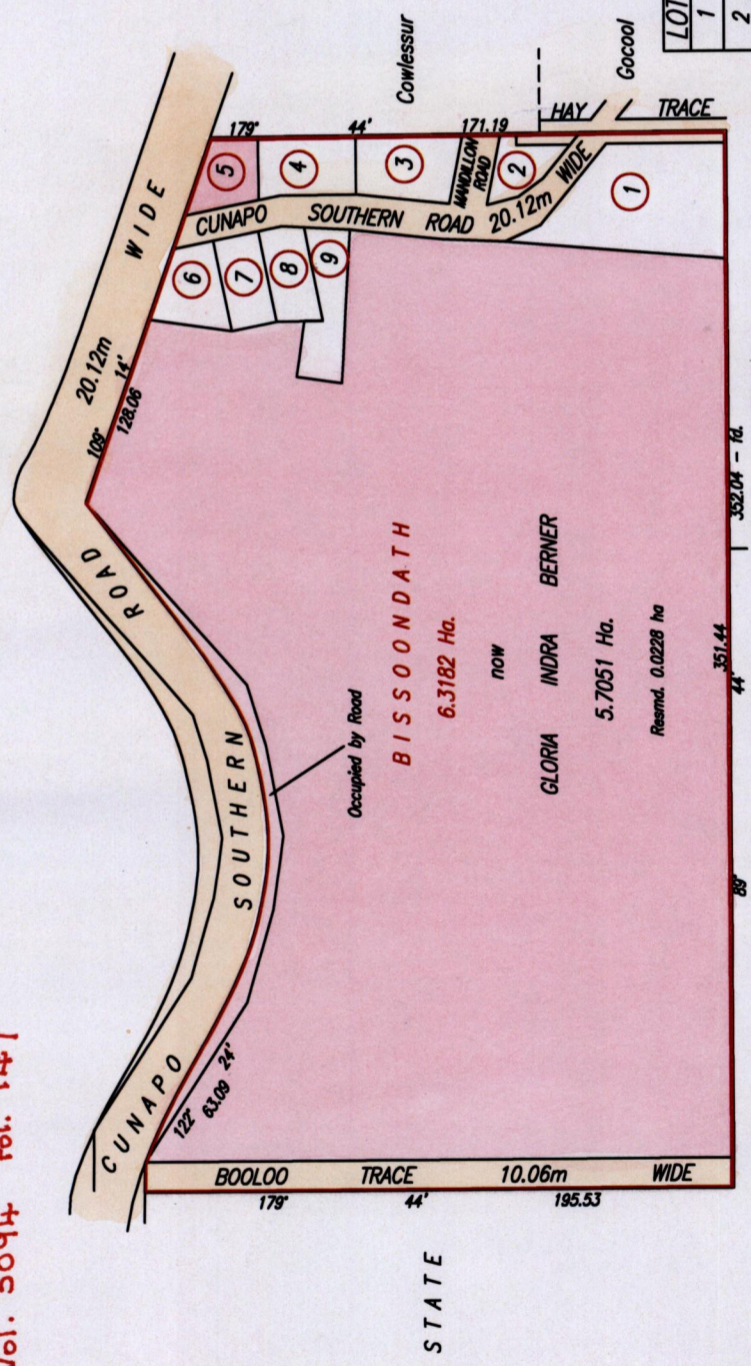

| LOTS | NAMES  | C.T. Vol. | Fol. | AREAS                  |
|------|--|-----------|------|------------------------|
| 1    | Yashwantee Khadan Joseph                         | 3134      | 45   | 2,083.7 m <sup>2</sup> |
| 2    | Sewak Baran                                      | 3121      | 317  | 355.8 m <sup>2</sup>   |
| 3    | Rose J. Baksh                                    | 4915      | 383  | 711.9 m <sup>2</sup>   |
| 4    | Sherry Ann Mc Donald Joseph & Christopher Joseph | 4637      | 315  | 637.8 m <sup>2</sup>   |
| 6    | Gatka Sharma & Lita Ramdial                      | 4219      | 325  | 549.4 m <sup>2</sup>   |
| 7    | Winnie Portillo                                  | 2964      | 337  | 464.5 m <sup>2</sup>   |
| 8    | Simbhoo Ramoutar                                 | 2947      | 291  | 471.9 m <sup>2</sup>   |
| 9    | Halima Baksh and Sanardar Rampersad              | 4372      | 357  | 628.0 m <sup>2</sup>   |

SCALE 1:2500

Distances are in metres

Orig - Bk. 171:8

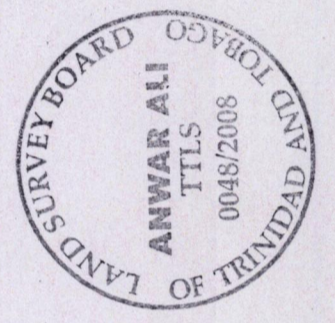

Approved .....  
Director of Surveys  
2008-9-9

Bearings are based on Solar Observations

This is a true copy of a diagram of six point three one eight two hectares originally, transferred to Bissoondath showing a portion coloured pink containing five point seven zero five one hectares being the remainder after eight transfers and one resumption of another portion of the land.

In accordance with Regulation 25 (1) of the Land Surveyors' Regulations 1998, I certify that this plan is correct.

Checked by: *[Signature]*

Entered on .....  
Trinidad & Tobago Land Surveyor,  
PAUL C. DRUMMOND/MARTIN BERNER 11-06-2008 DMC.  
11th June 2008.

Original 1179:9

