

g-h	62° 06'	1.20
h-i	62° 06'	0.53
i-k	131° 55'	3.88
h-j	131° 55'	3.96
k-m	156° 37'	6.46
j-l	156° 37'	5.58
g-n	159° 33'	4.33

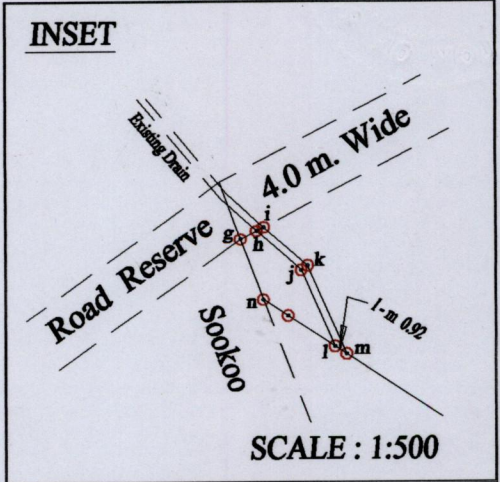

Vide Plan J.A.162

See PLAN D.K.29

Approved *[Signature]*
 Director of Surveys
 2005-01-05

o Denotes Iron put except stated otherwise.

Note: Bearings are cassini grid based on solar observations

SCALE : 1:1000
 Distances are in metres

PLAN of a Parcel of land coloured pink in the Ward of Pointe-a-Pierre
 Containing seven hundred and ninety five point one square metres
 Surveyed by me, with due authority, in January 2005
 In accordance with Regulation 25 (1) of the Land Surveyors' Regulations 1998,
 I certify that this plan is correct.

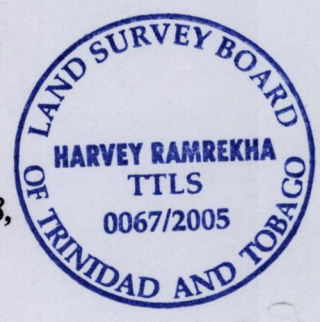

Checked by *[Signature]* 3/1/05 *[Signature]*

Entered on Trinidad & Tobago Land Surveyor 2005

ORIGINAL PLAN J.A. 162

MINISTRY OF AGRICULTURE
LAND AND SURVEY
DIVISION
- 7 NOV 2005
LANDS AND MARINE RESOURCES

12/11/05
2554

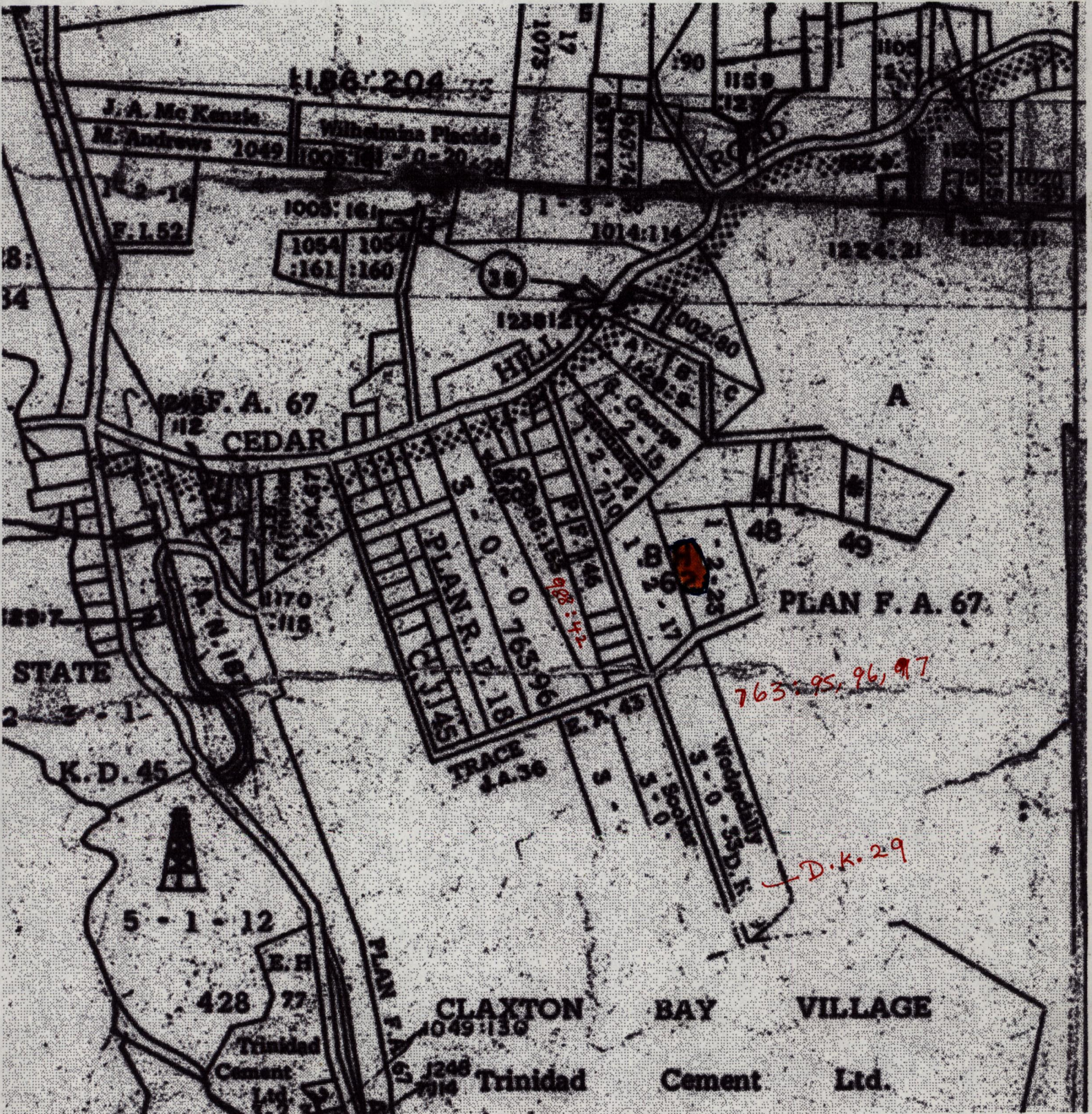

43.E
4/d

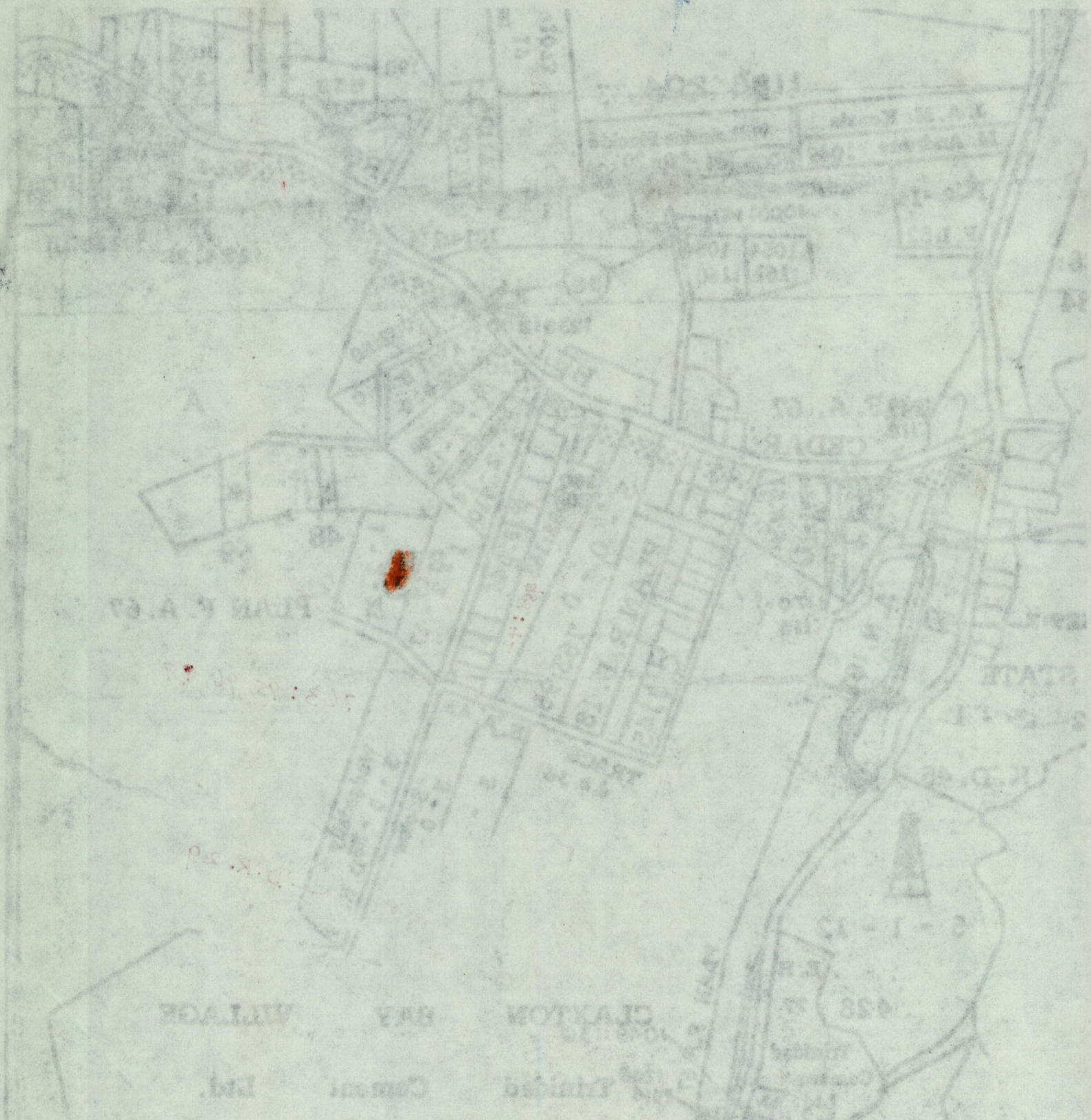

PLAN F. A. 63

113.42.19.71

113.42.19.71

VILLAGE

HAY

CLAYTON

111

Common

the British

4/19
137
F