

R.P.O Vol. 113 Fol. 41
C.T. Vol. 2828 Fol. 443
Vol. 5109 Fol. 179

Ward of Siparia.
County of St. Patrick.
Cadastral Sheet G.12.H. 63E
2/c

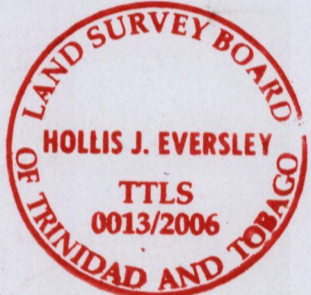
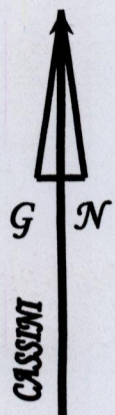
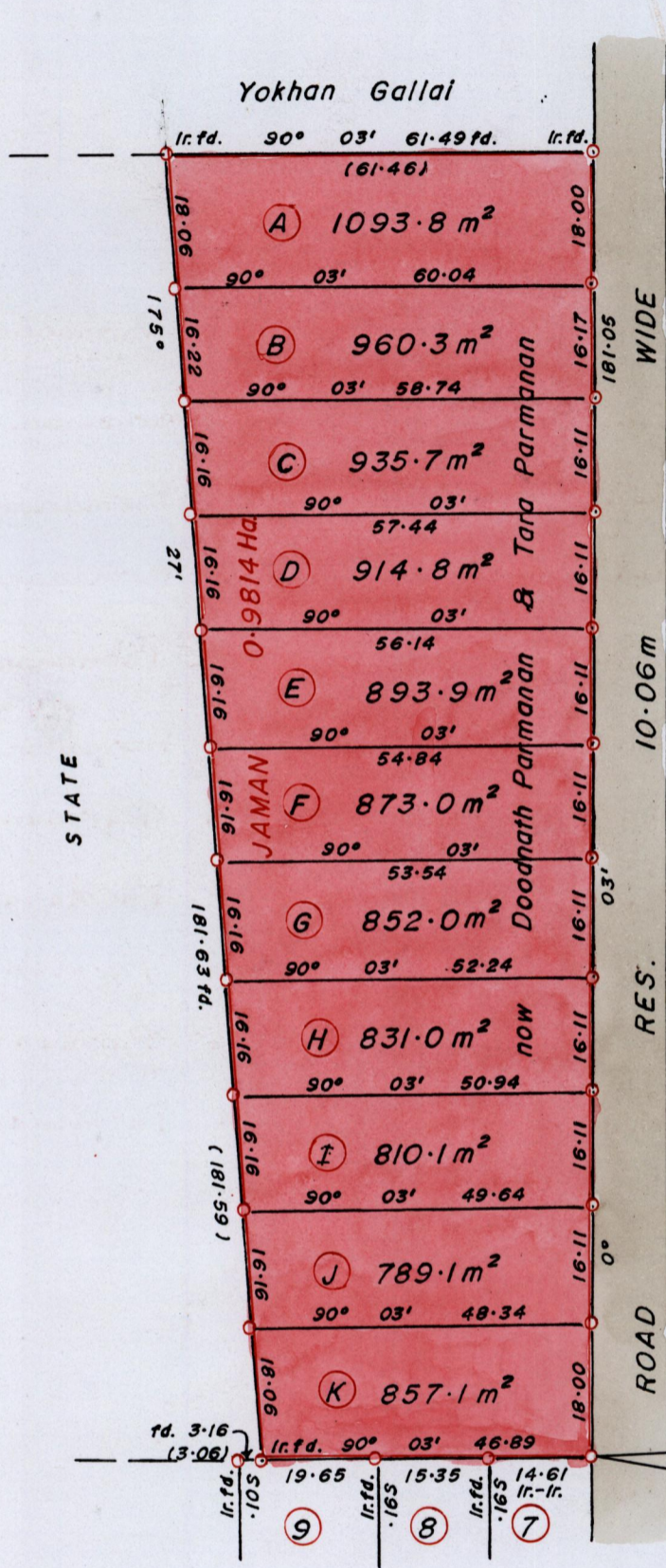

1124912 mN, 666810 mE
UTM 20, WGS 84 (+/- 5.0m)
GPS Direct Obs.

Bk. 1137:200 - Orig Survey

Approved.....
Director of Surveys.
2009. 01.15

SCALE 1 : 1000.
Distances are in METRES

○ Denotes Iron Put except otherwise stated
Bearings are Cassini Grid based on Solar Observations.

PLAN of 11 Parcels of land coloured in PINK in the Ward of Siparia.
Containing together zero point nine eight one one hectare.
Surveyed by me, with due authority, in January 2006.
In accordance with Reg. 25(1) of the Land Surveyors' Regulations 1998,
I certify that this plan is correct.

Checked by
Entered

Trinidad and Tobago Land Surveyor..... 2006.

Lot. No.	Vol. & C.T.	NAMES.
A.	Vol. 5149 Fol. 49	Doodnath & Tara Parmanan
B.	Vol. 5149 Fol. 55	Doodnath & Tara Parmanan
C.	Vol. 5149 Fol. 61	Doodnath & Tara Parmanan
D.	Vol. 5149 Fol. 67	Doodnath & Tara Parmanan
E.	Vol. 5149 Fol. 73	Doodnath & Tara Parmanan
F.	Vol. 5149 Fol. 79	Doodnath & Tara Parmanan
G.	Vol. 5149 Fol. 185	Doodnath & Tara Parmanan.
H.	Vol. 5149 Fol. 91	Doodnath & Tara Parmanan.
I.	Vol. 5149 Fol. 97	Doodnath & Tara Parmanan
J.	Vol. 5149 Fol. 103	Doodnath & Tara Parmanan.
K.	Vol. 5149 Fol. 109	Doodnath & Tara Parmanan.

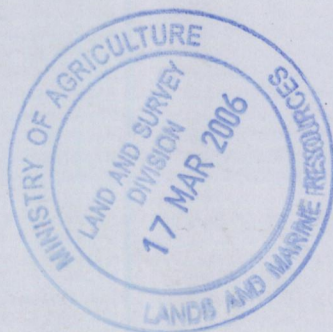

1127/176