

Vol. 5043 Fol. 247

R.P.O Vol. 28 Fol. 437  
C.T. Vol. 2541 Fol. 151  
Ref: Bk. 1005 Fol. 165

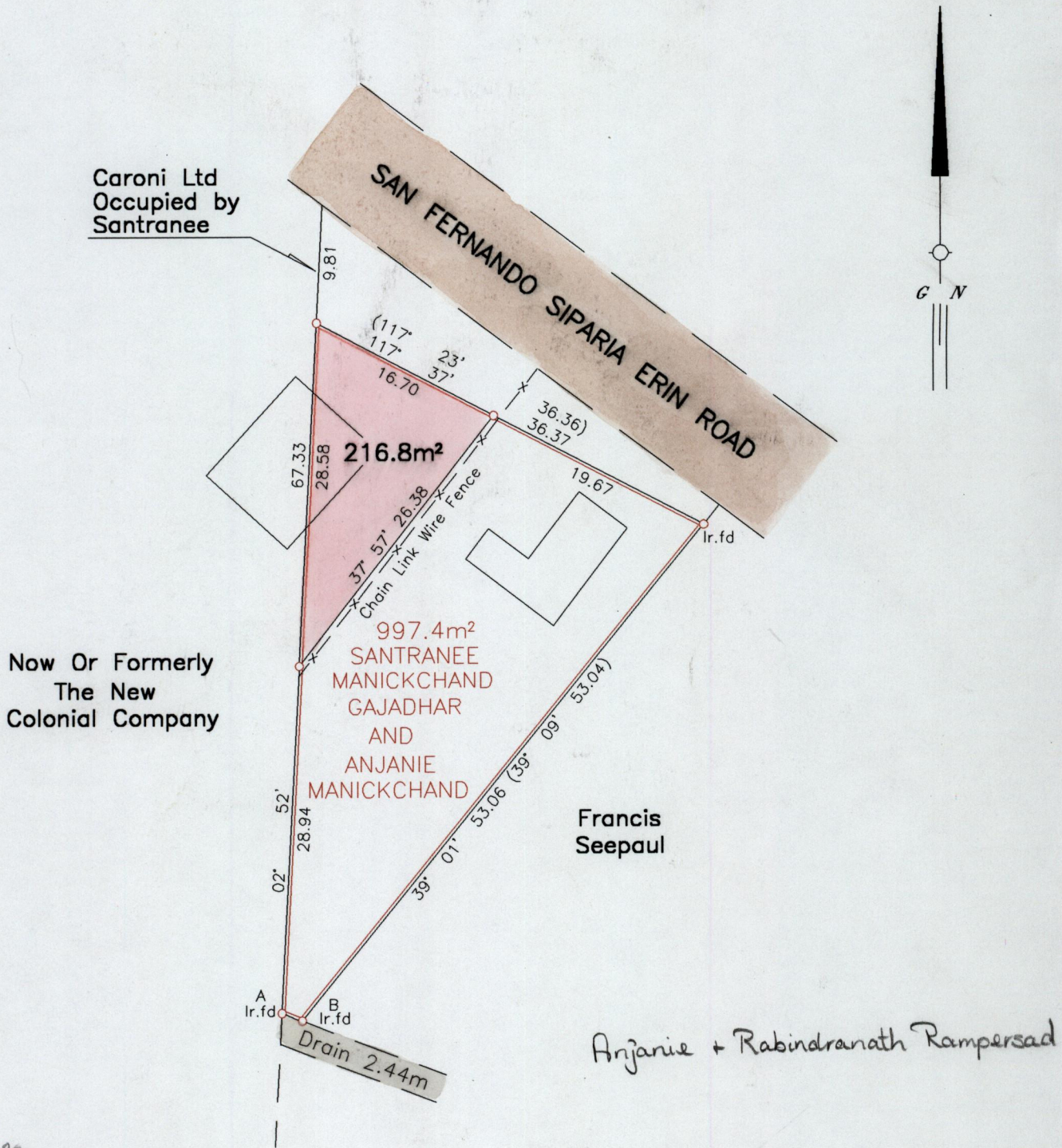

Now Or Formerly  
The New  
Colonial Company

MEJ  
13-12-02

Approved: *[Signature]*  
Director of Surveys

Orig - BK. 1110 : 214

A-B 110° 36' 1.81 (A-B 106° 44' 1.83)

SCALE 1/500

Distances are in Metres

○ Denotes Iron put except otherwise stated

Bearings are Cassini Grid based on Solar Observations

Plan of a Parcel of land coloured pink in the Ward of Naparima

Containing two hundred and sixteen point eight square metres

Surveyed by me with due authority, on 30th March 1999

In accordance with Regulation 25 (1) of the Land Surveyors' Regulations 1998,

I certify that this plan is correct.

Checked by: *[Signature]* 5/12/02

*[Signature]*

Entered..... Trinidad & Tobago Land Surveyor November 22, 2002

Path=C:\Sdsk\proj\teddy



Central Sheet T.S. 10  
State of Michigan  
County of Wayne

SAN FERNANDO SPIRIA ERMI ROAD

18.70  
18.70  
18.70

18.70

SCALE 1/200

Distances are in Meters

1871/194

4 DEC 2002  
Lands and  
Surveys  
Division

1871/194