

No

24253

R.P.O. Vol. 43
C.T. Vol. 2387
Vol. 4598 Fol. 217

Fol. 601
Fol. 235

Ward of Savana Grande
County of Victoria
Cadastral Sheet G·10·N· $\frac{64B}{4/d}$

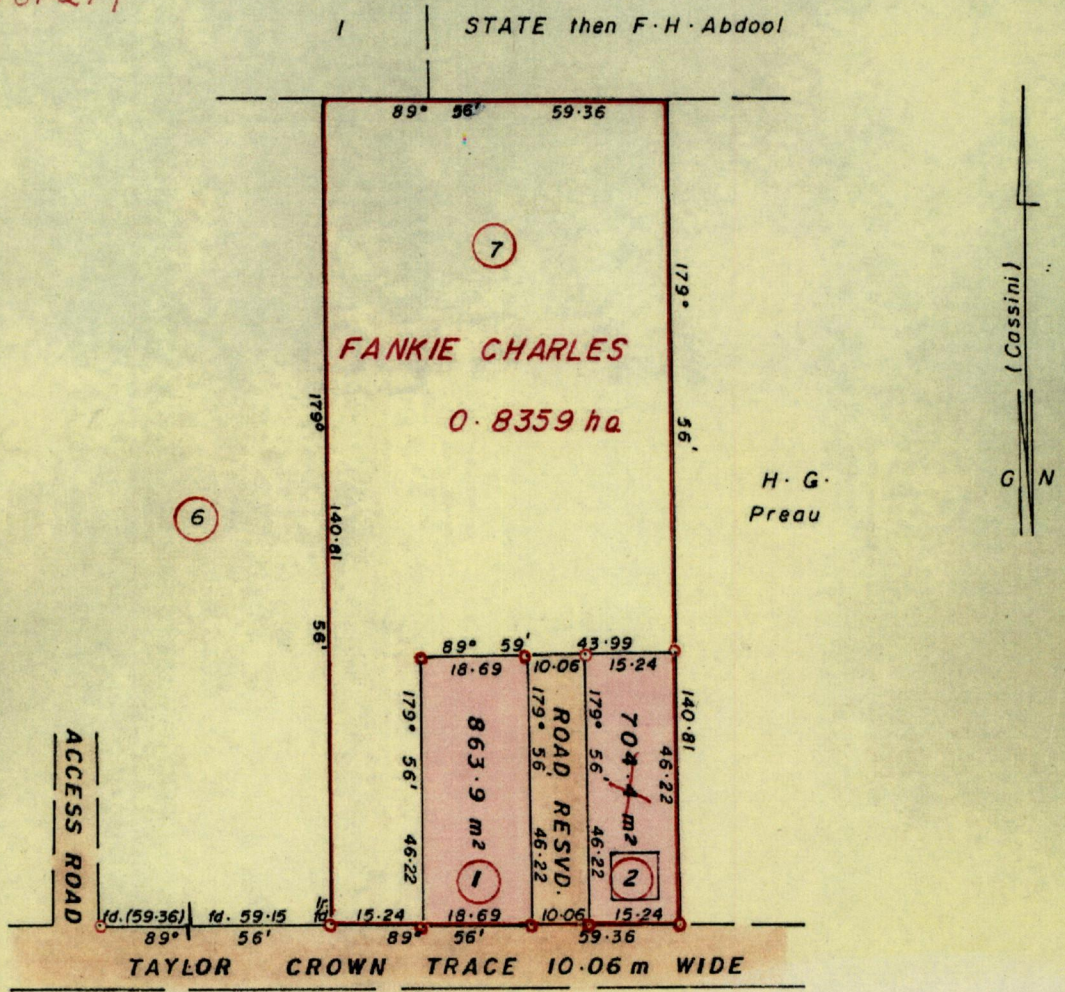

Orig - Bk. 980 : 70

Approved

Alton...
Director of Surveys
88.12.21

Iron out at all corners except stated otherwise
SCALE 1:1250

Note: To obtain compass bearings add/subtract 4 minutes Distances are in metres
PLAN of $\frac{2}{4}$ Parcel of land coloured pink in the Ward of Savana Grande
Containing together one thousand five hundred and sixty eight point three sq. metres
Surveyed by me, with due authority, in MAY 1988

I certify that I have complied with rule 76 under section 14(2)(d) of the
Land Surveyors' Ordinance 1952, and that this plan is correct.

Checked by *SP 20/12/88* *Minister Ram...*
Entered Land Surveyor, Trinidad 21st May 1988

