

R.P.O. Vol. 205 Fol. 75
C.T. Vol. 1315 Fol. 419
Vol. 5142 Fol. 107
Original Survey: Bk. 415 Fol.157

Ward of Siparia
County of St. Patrick
Cadastral Sheet $\frac{74A}{1/c\&3/a}$ (G.19.E)

Ref: Bk. 1273 Fol. 61
Bk. 707 Fol. 169

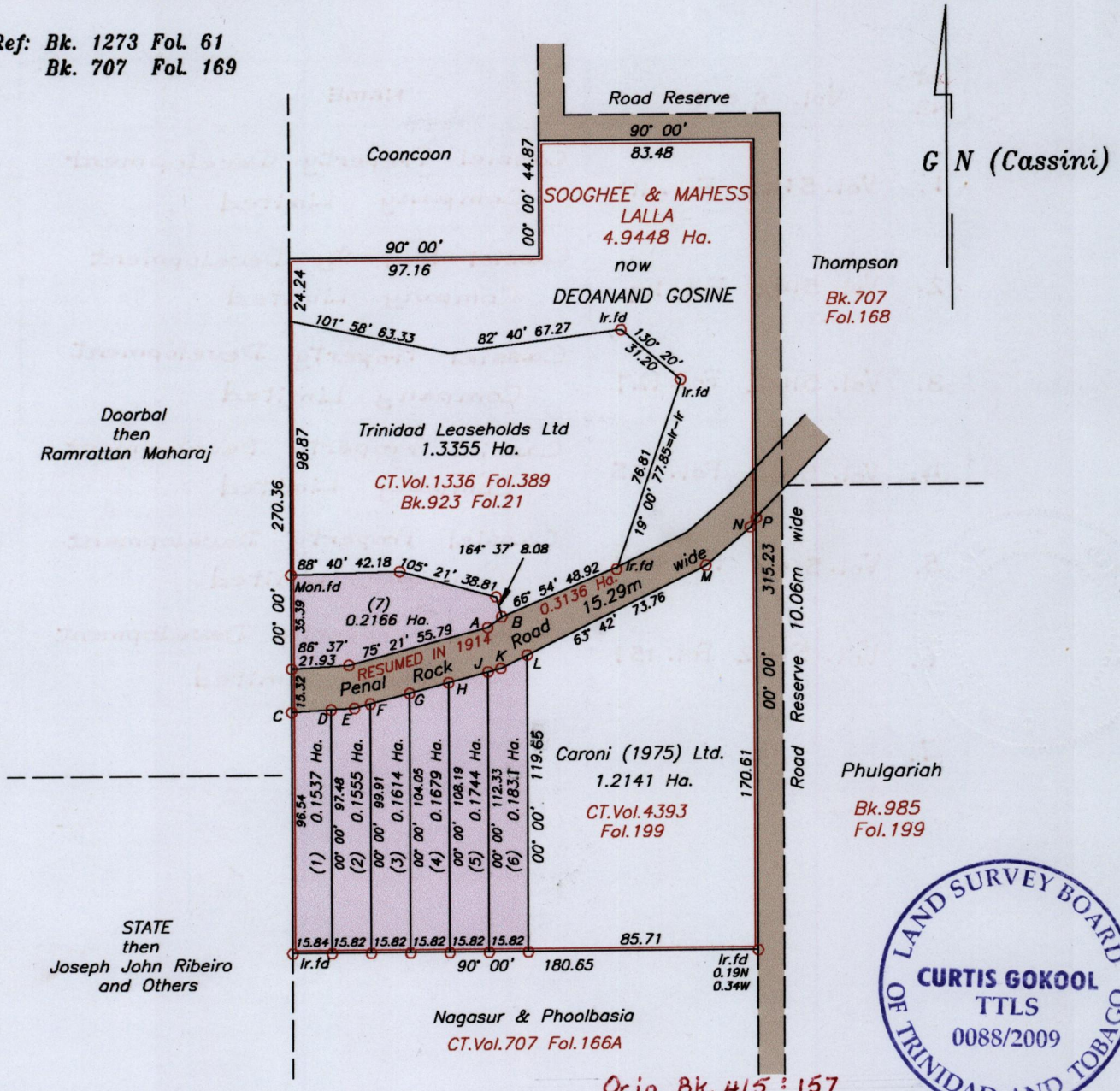

Orig Bk. 415 : 157

C= N1119195 (U.T.M)
E 674912

A-B	63° 42'	6.55
C-D	86° 37'	15.88
D-E	86° 37'	8.46
E-F	75° 21'	7.62
F-G	75° 21'	16.35
G-H	75° 21'	16.35
H-J	75° 21'	16.35
J-K	75° 21'	2.19
K-L	63° 42'	15.28
M-N	49° 27'	22.76
N-P	33° 18'	4.17

Approved *[Signature]*
 Director of Surveys
 2009.5.18

Notes: U.T.M 20 Naparima (GPS +/- 3.0m)
 ○ Denotes Iron put unless otherwise stated
 Bearings are Cassini Grid based on solar observations

SCALE 1 : 2500
 Distances are in METRES

PLAN of 7 Parcels of land coloured pink in the Ward of Siparia.
 Containing together one point two one two six hectares.
 Surveyed by me, with due authority, in Dec 2001 & Feb 2009.
 In accordance with Regulation 25 (1) of the Land Surveyors' Regulations 1998,
 I certify that this plan is correct.

Checked by *[Signature]* *[Signature]*
 Entered on Trinidad and Tobago Land Surveyor February 12 2009

500

Lot No	Vol. & c.T.	NAME
1.	Vol. 5142 Fol. 111	Cassiel Property Development Company Limited
2.	Vol. 5142 Fol. 119	Cassiel Property Development Company Limited
3.	Vol. 5142 Fol. 127	Cassiel Property Development Company Limited
4.	Vol. 5142 Fol. 135	Cassiel Property Development Company Limited
5.	Vol. 5142 Fol. 143	Cassiel Property Development Company Limited
6.	Vol. 5142 Fol. 151	Cassiel Property Development Company Limited
7.		

