

Process ID# 110023

1564

Cadastral Sheet I.17. & I.22.  $\frac{1F}{6/c}$   
Ward of Tobago  
Parish of St. Patrick

DIAMOND ESTATE

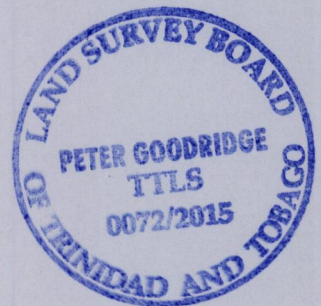
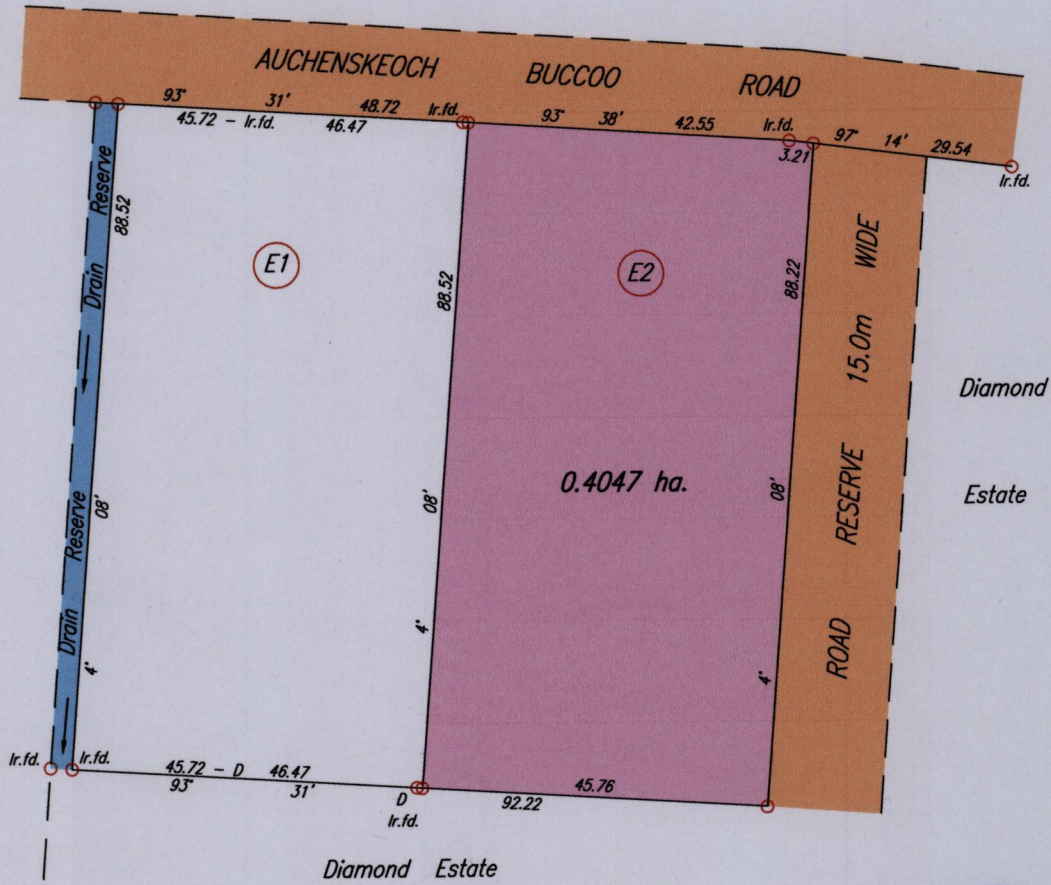

Coordinates of D (I.r.f.d.): 0743027mE, 1235460mN  
U.T.M. 20, WGS 84 (+/-4.00m)  
G.P.S (Direct Observation)

SCALE 1:1000

Distances are in METRES

o Denotes Iron put except where otherwise stated

Bearings are U.T.M. Grid based on Solar Observations

PLAN of a Parcel of land coloured pink in the Ward of Tobago

Containing zero point four zero four seven hectares

Surveyed by me, with due authority, in March 2015 for Auchenskeoch Ltd.

Certified Correct in accordance with Regulation 25 (1) of The Land Surveyors Regulations 1998,

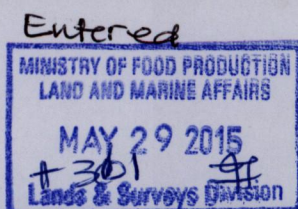

*[Signature]* TTLS

Trinidad & Tobago Land Surveyor  
C:\LESS 2015\TOBAGO\BISHOP,RICK sub.dwg. 26th May 2015  
FILE NO : TB046&TB074

460