

1564

Cadastral Sheet I.17.

83

Process SA 110015

Ward of Tobago

Parish of St. Andrew

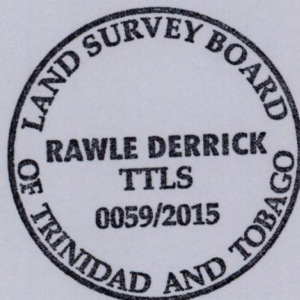
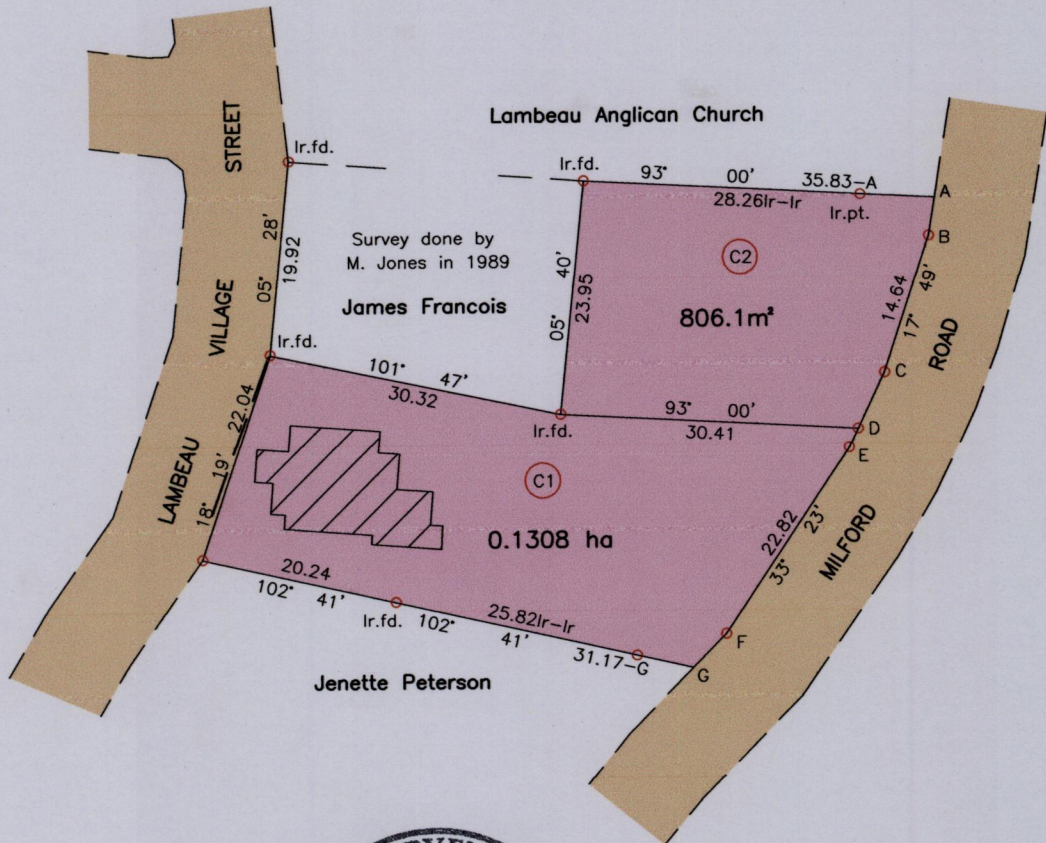
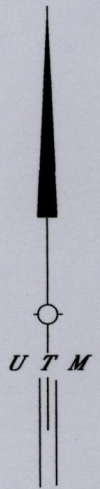

Ir.pt.=D:-N:1235433m  
E:745047m  
UTM 20, NAP Datum ± 7m  
GPS (Hand Held)

|            |               |
|------------|---------------|
| Wall Fence | ---           |
| A-B        | 188° 55' 3.92 |
| C-D        | 205° 10' 6.34 |
| D-E        | 205° 10' 2.12 |
| F-G        | 224° 09' 4.82 |

SCALE 1/750

Distances are in Metres

○ Denotes Iron put except otherwise stated  
Bearings are UTM Grid based on Solar Observations  
Plan of two Parcels of land coloured pink in the Ward of Tobago  
Containing together zero point two one one four hectare  
Surveyed by me with due authority, in October 2014 for Cyril Collier  
Certified Correct in accordance with Regulation 25 (1) of the  
Land Surveyors Regulations 1998.

*Rawle Derrick*

Entered..... Trinidad & Tobago Land Surveyor *May 24*.....2015

