

Cadastral Sheet I.12.N
Ward of Tobago
Parish of St. David
PENTLAND

AMENDED SURVEY PLAN

IC
4/a

LEGEND

From To	Bearing	Distance
R1 - S1	128° 01'	21.67
R2 - S1	128° 01'	21.23
S1 - S2	15° 05'	9.38
S2 - S3	97° 38'	10.09

LEGEND

From To	Bearing	Distance
R0 - R1	39° 04'	11.39
R1 - R2	39° 04'	1.00
R3 - R4	69° 59'	8.36
R5 - R7	131° 51'	8.93
R7 - R8	156° 01'	13.46
R8 - R9	139° 20'	4.19
R9 - R10	127° 32'	4.65
R10 - L	105° 51'	4.85
L - R11	89° 26'	4.13
R11 - R12	160° 39'	4.64
R13 - R14	88° 22'	3.09
R14 - R15	97° 00'	3.56
R15 - R16	105° 22'	3.60
R16 - R17	109° 24'	9.78
R18 - R19	125° 01'	5.31
R19 - R20	145° 55'	5.78
R20 - R21	167° 52'	6.31
R21 - R22	180° 20'	5.61
R22 - R23	187° 11'	13.53
R23 - R24	168° 41'	8.84
R24 - R25	149° 51'	1.75
R24 - LP	33° 50'	1.21
R21 - R22	146° 31'	7.96
R23 - R24	162° 47'	2.36
R24 - R25	301° 37'	7.75
R26 - R27	284° 10'	1.28
R28 - R29	301° 37'	7.06
T1 - T2	299° 04'	4.02
T2 - T3	29° 04'	1.00
T3 - T4	119° 04'	3.99
T4 - T5	115° 35'	2.82
T1 - T6	115° 35'	1.01
T7 - T8	134° 07'	8.09
T8 - T9	96° 32'	1.13
T9 - T10	150° 29'	2.43
T9 - T6	33° 52'	20.92
T11 - T14	152° 36'	1.02
T12 - T13	229° 50'	11.31
T14 - T15	152° 36'	3.90
T16 - T17	112° 34'	8.59
T17 - T18	82° 52'	5.38
W1 - W2	134° 07'	5.19
W2 - W3	167° 47'	5.74

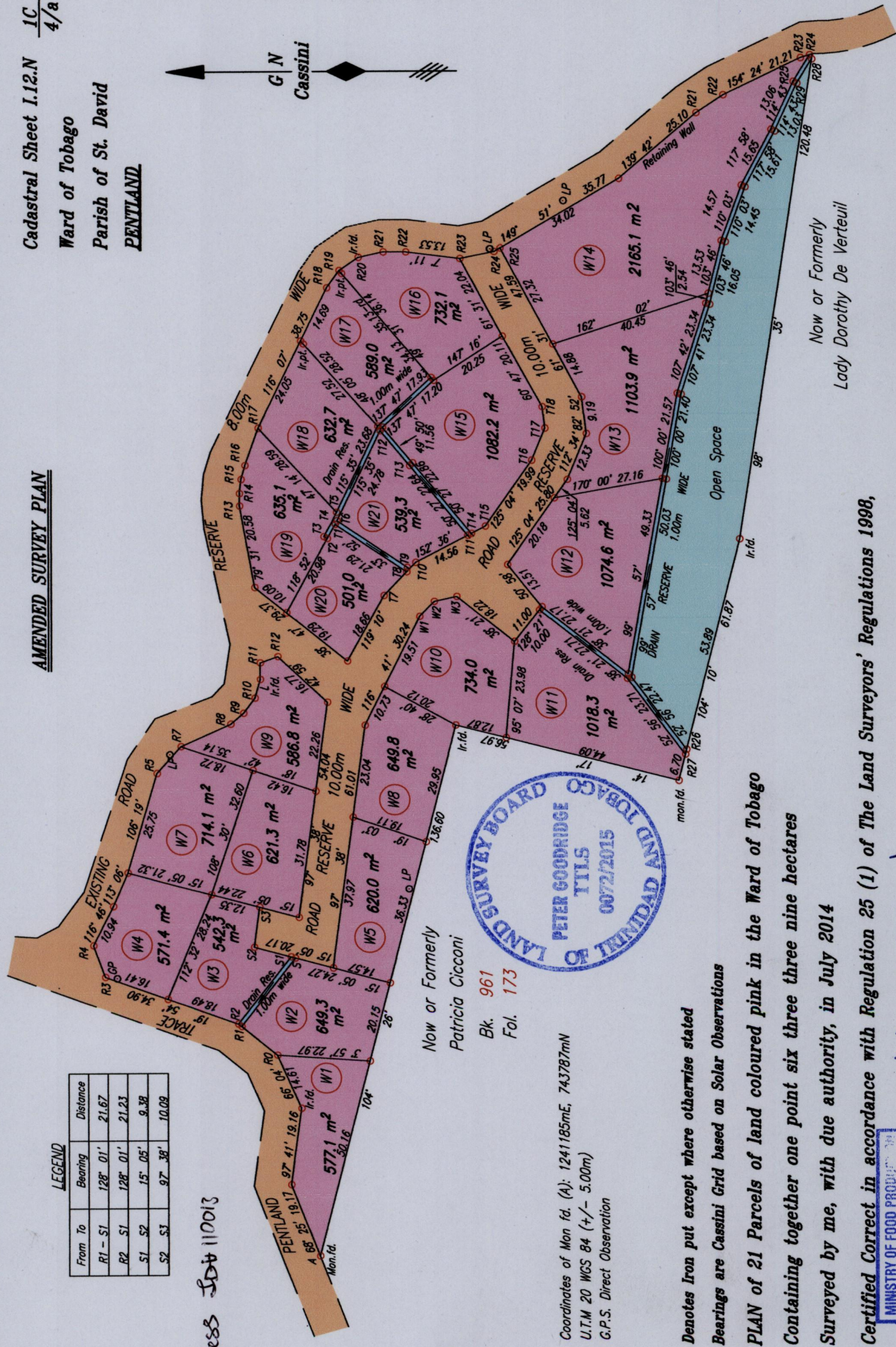
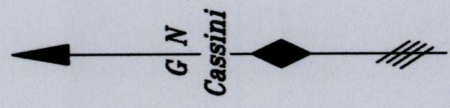

Now or Formerly
Patricia Cicconi
Bk. 961
Fol. 173

Coordinates of Mon fd. (A): 1241185mE, 743787mN
U.T.M 20 WGS 84 (+/- 5.00m)
G.P.S. Direct Observation

○ Denotes Iron put except where otherwise stated
Bearings are Cassini Grid based on Solar Observations

PLAN of 21 Parcels of land coloured pink in the Ward of Tobago
Containing together one point six three three hectares
Surveyed by me, with due authority, in July 2014

Certified Correct in accordance with Regulation 25 (1) of The Land Surveyors' Regulations 1998,

MINISTRY OF FOOD PRODUCTION, LAND AND MARINE AFFAIRS
MAY - 5 2015
 #22
 Lands & Surveys Division

[Signature]

.....TTLS

Trinidad & Tobago Land Surveyor
C:\LESS 2014\TOBAGO\WARNER\ALLAN.OFF.PENTLANDS TRACE.PLYMOUTH.dwg FILE NO: TH100
2015
Entered: 6/2/15

Now or Formerly
Lady Dorothy De Verteuil
SCALE 1:1250
Distances are in METRES