

1504

{ } ()

U.P.R.N.....

Process ID# 110005

Cadastral Sheet 1.12.M ^{1C}/_{1/d/4}
Ward of Tobago
Parish of St. David
PLYMOUTH

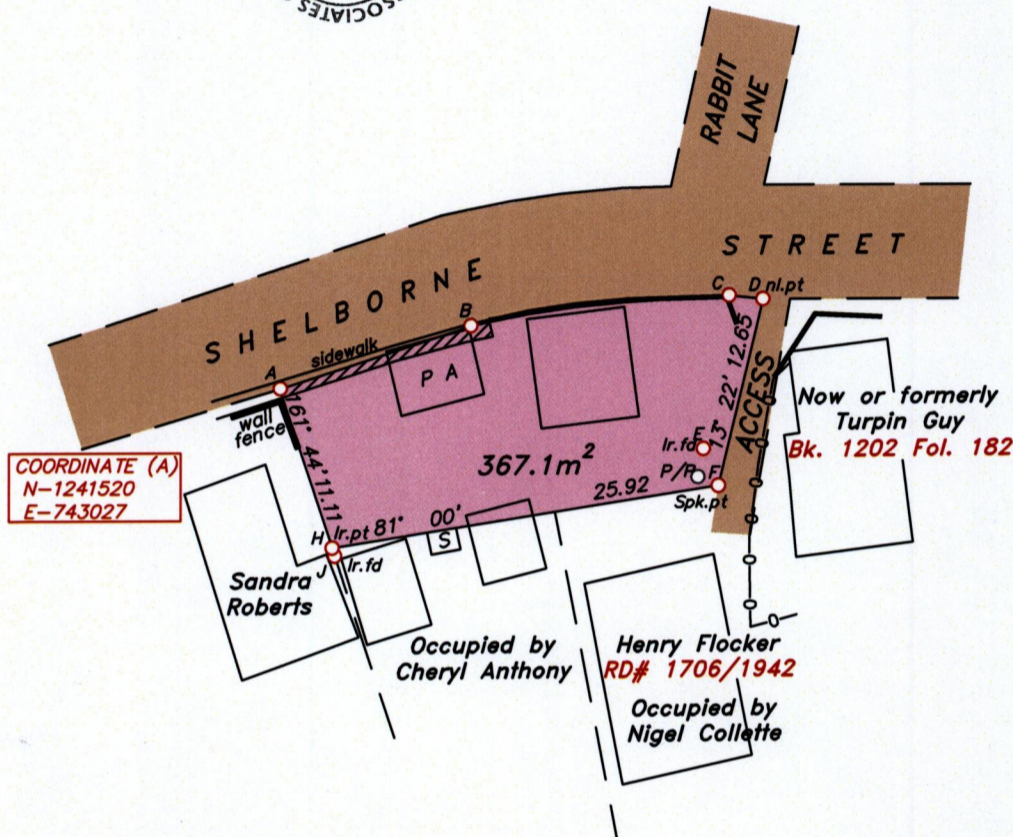

- dwelling house
- parlour
- outdoor oven
- occupied by road 10.1m²
- retaining wall
- galvanize fence
- power pole(P/P)

LEGEND		
LINE	BEARING	DISTANCE
A-B	72°01'	13.30
B-C	83°31'	17.24
C-D	96°02'	2.24
E-F	157°51'	2.64
E-P/P	191°12'	1.89
H-J	162°37'	0.56

Note- UTM Zone 20 (WGS 84) Coordinates obtained from hand held GPS receiver
± 5.00m



○ Denotes nail found, except otherwise stated.

SCALE 1:500

Bearings are U.T.M grid based on solar observations
Distances are in metres

PLAN of a parcel of land coloured pink in the Ward of Tobago.
Containing three hundred and sixty seven point one square metres.
Surveyed by me, with due authority on 28th April 2015 for Moulda George.
Certified Correct in accordance with Regulation 25 (1) of the Land Surveyors Regulations 1998.

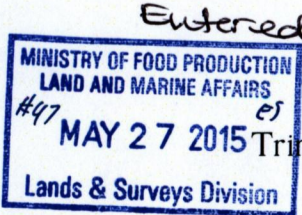

Entered
L. Antonio
26th May 2015
Trinidad & Tobago Land Surveyor.....2015.

