

1564

65

U.P.I.N. No.

Cadastral Sheet $\frac{2G}{2/d}$, I.17.D.

Process ID 109966

Ward of Tobago

Parish of St. George

"SOUTH PHASE I
ADELPHI ESTATE, MASON HALL"

Grid North
U.T.M.

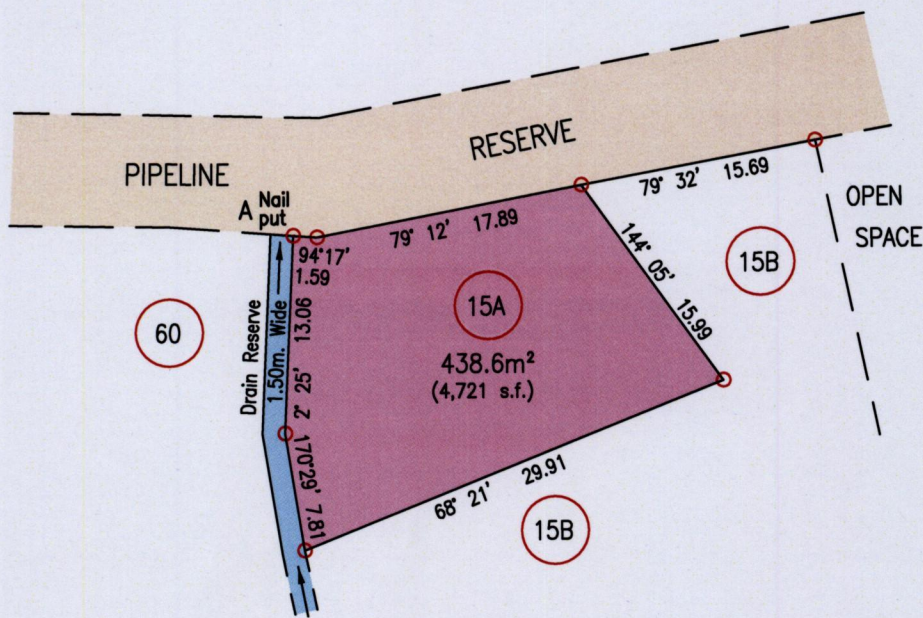

A	E 749346
	N 1240428

Reliability Error ± 5.0 m.
 Coordinates are UTM Zone 20, Naparima 1955 from
 Garmin GPSmap 60CSx Handheld GPS Receiver



SCALE 1:500
 Distances are in Metres

- Bearings are U.T.M. Zone 20 Grid based on Solar Obs.
- Denotes Iron Found unless otherwise stated
- Plan of a Parcel of land coloured pink in the Ward of Tobago
 Containing four hundred and thirty eight point six square metres
 Surveyed by me, with due authority, in May 2015 for The Tobago House of Assembly
 Certified correct in accordance with Regulation 25(1) of the Land Surveyors Regulations 1998.

Entered

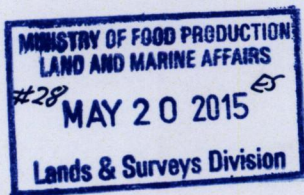

[Signature]

Trinidad & Tobago Land Surveyor 20th May 2015