

1564

63

U.P.I.N. No.

Cadastral Sheet $\frac{2J}{3/a}$, I.18.L.

Process ~~109955~~ 109955

STUDLEY PARK

Ward of Tobago

Parish of St. George

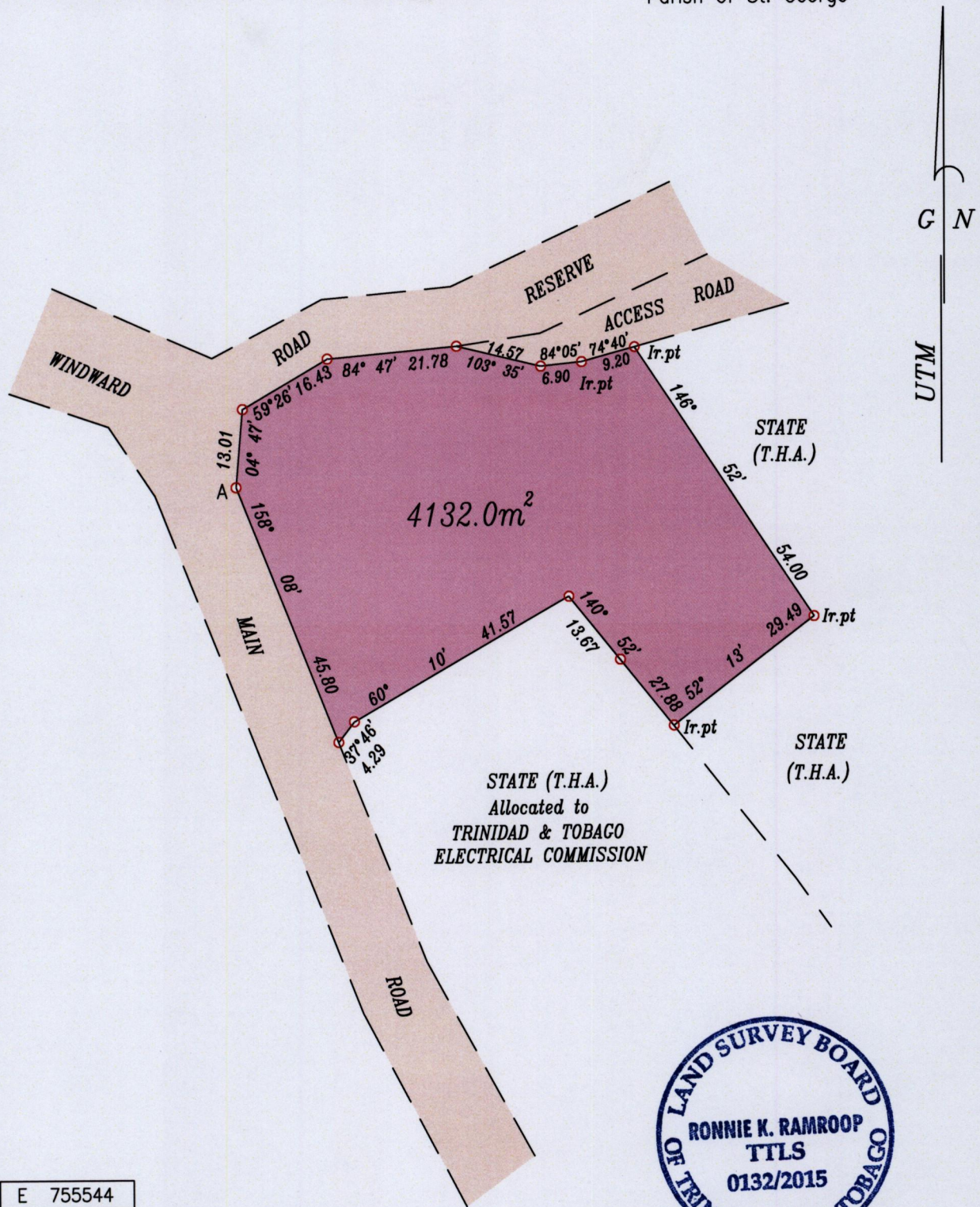

A	E 755544
	N 1238025

Reliability Error \pm 5.0 m.

Coordinates are U.T.M. Zone 20, Naparima 1955
Obtained from Handheld GPS Receiver

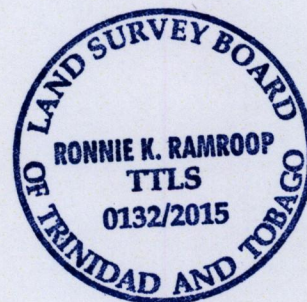

SCALE 1:1000

Distances are in metres

Bearings are grid based on solar observations

○ Denotes Iron Found except otherwise stated

Plan of a Parcel of land coloured pink in the Ward of Tobago.

Containing four thousand one hundred and thirty two point zero square metres.

Surveyed by me with due authority, in November 2014 for the Tobago House of Assembly.

Certified correct in accordance with Reg. 25(l) of the Land Surveyors Regulations 1998.

Entered

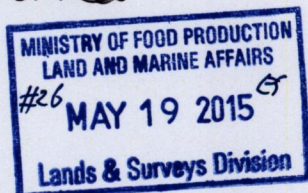

Ramroop

 Trinidad and Tobago Land Surveyor 19th MAY 2015