

1564

60

U.P.I.N. No.

Cadastral Sheet  $\frac{2J}{2/b}$ , I.19.B.

Process SD# 109813

Ward of Tobago

"COMMERCIAL PARK, GOLDSBOROUGH"

Parish of St. Mary

LINE	BEARING	DIST.
A - B	166° 29'	4.24

Grid North  
U.T.M.

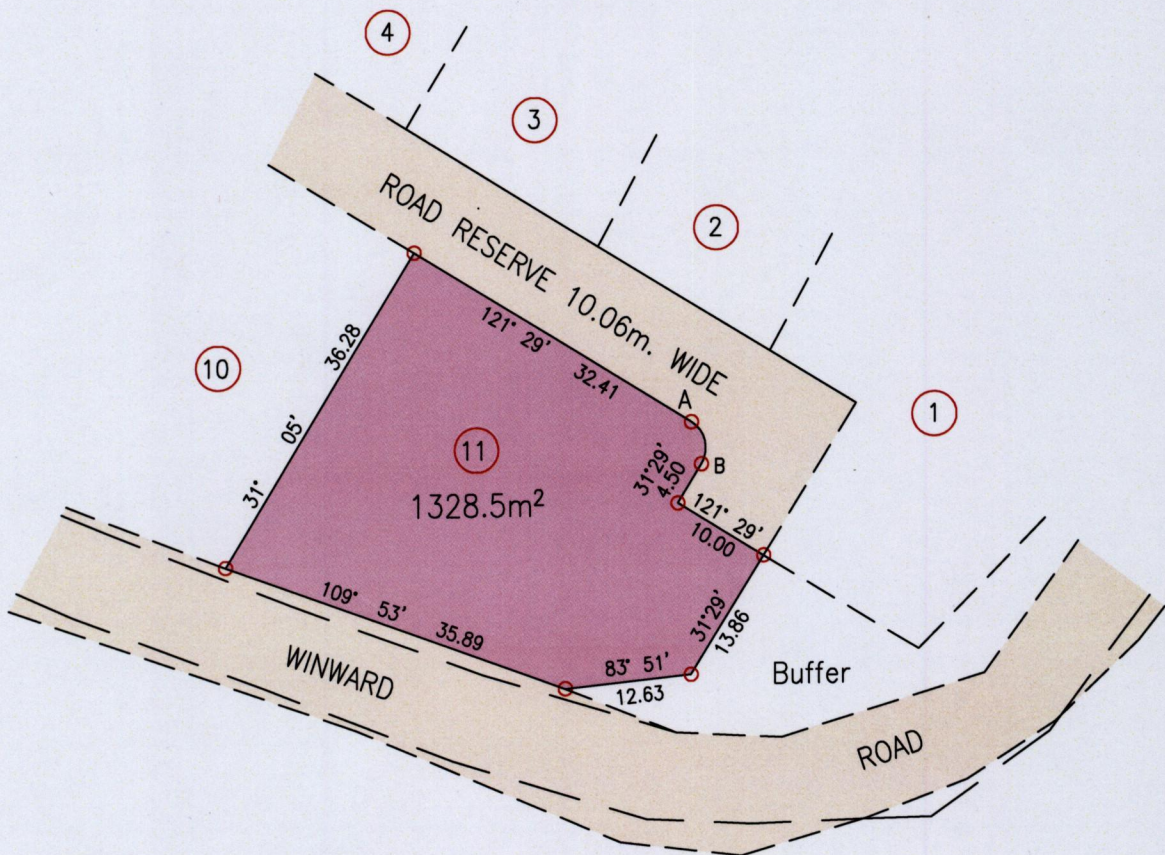

E	758823.44
N	1240194.56

Reliability Error  $\pm$  5.0 m.  
Coordinates are U.T.M. Zone 20, Naparima 1955  
Obtained from Handheld GPS Receiver



SCALE 1:750  
Distances are in Metres

- Bearings are U.T.M. Zone 20 Grid based on Solar Obs.
- Denotes Iron Put unless otherwise stated
- Plan of a Parcel of land coloured pink in the Ward of Tobago Containing one thousand three hundred and twenty eight point five square metres Surveyed by me, with due authority, in January 2015 for The Tobago House of Assembly Certified correct in accordance with Regulation 25(1) of the Land Surveyors Regulations 1998.

Entered  
MINISTRY OF FOOD PRODUCTION  
LAND AND MARINE AFFAIRS  
#23 MAY 19 2015  
Lands & Surveys Division

*Ramroop*

Trinidad & Tobago Land Surveyor ..... 19<sup>th</sup> May 2015