

Process ID#109381

WOODLANDS

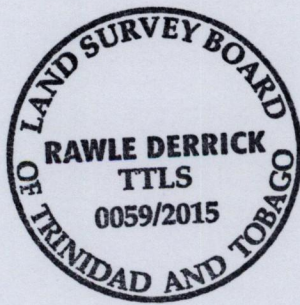
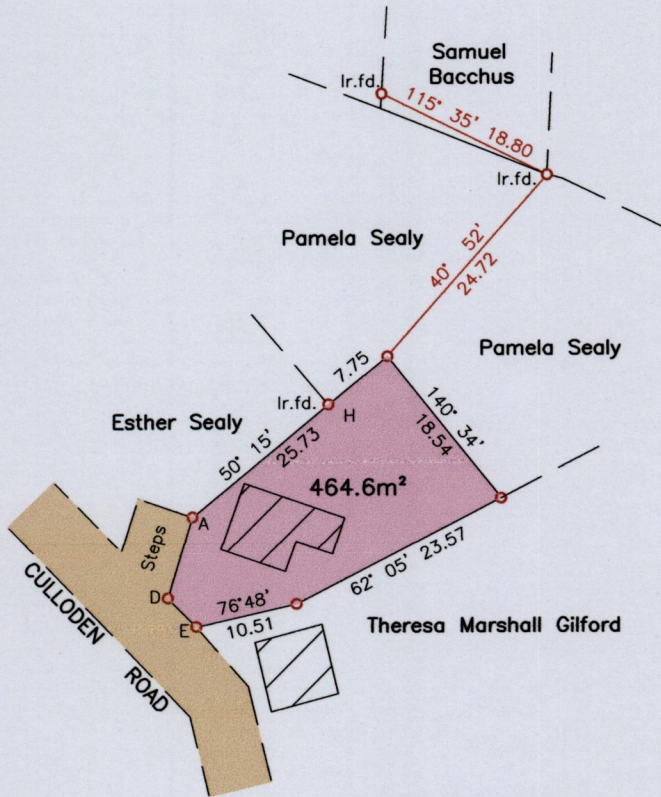

Ir.fd.=H:- N:1243737m
E:747987m
UTM 20, NAP Datum ± 7m
GPS (Hand Held)

E-D 315° 06' 4.14
D-A 16° 09' 8.71

SCALE 1/750

Distances are in Metres

o Denotes Iron put except otherwise stated
Bearings are UTM Grid based on Solar Observations
Plan of a Parcel of land coloured pink in the Ward of Tobago
Containing four six four point six square metres
Surveyed by me with due authority, in March 2009 for Maurice Taylor
Certified Correct in accordance with Regulation 25 (1) of the
Land Surveyors Regulations 1998.

Entered..... Rawle Derrick.....

Trinidad & Tobago Land Surveyor April 04 2015

368

