

1564

1600

U.P.I.N. No.

Cadastral Sheet $\frac{2G}{3/d/1}$, I.17.K.

R.D. No. 20517 of 1998

Ward of Tobago

Process JD#111334

Parish of St. Andrew

"PLYMOUTH ROAD, SCARBOROUGH"

Vide
Bk. 1140:175

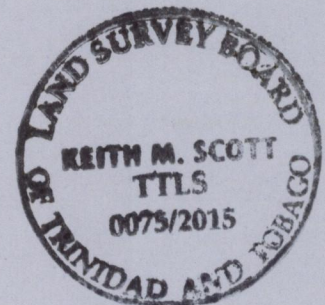
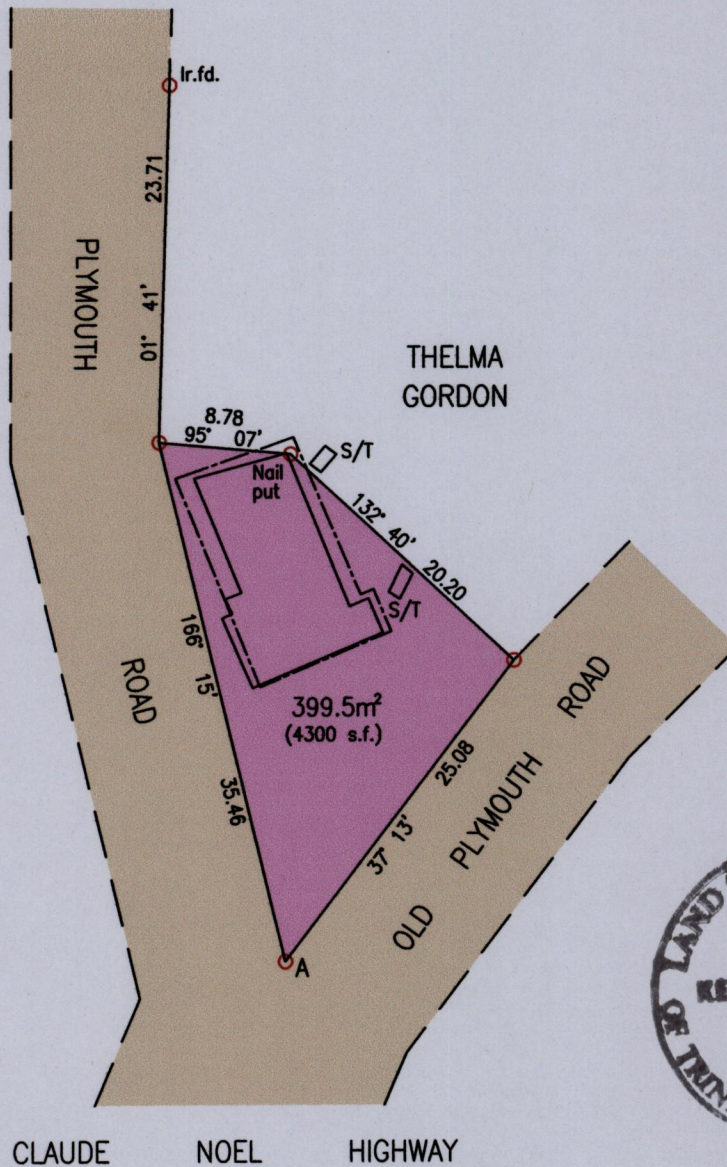
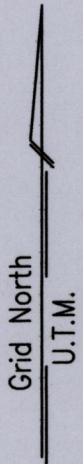

SCALE 1:500

Distances are in Metres

----- Denotes Building Eave
S/T - Denotes Septic Tank

A	E	746831.99
	N	1237617.33

Reliability Error ± 5.0 m.

Coordinates are U.T.M. Zone 20, WGS 1984 from Handheld GPS Receiver

Bearings are U.T.M. Zone 20 based on Solar Obs.

○ Denotes Iron Found unless otherwise stated

Plan of a Parcel of land coloured pink in the Ward of Tobago

Containing three hundred and ninety nine point five square metres

Surveyed by me, with due authority, in February 2015 for Ancil Carter

Certified correct in accordance with Regulation 25(1) of the Land Surveyors Regulations 1998.

Entered on Trinidad & Tobago Land Surveyor *15th July* 2015

