

1563

88

Process Jd#111003

CONDOMINIUM SCHEME - La Baja Heights - Maracas Valley

Cadastral Sheet 13F  
4/b (B.17.H.)  
Ward of Tacarigua  
County of St. George

Inset NOT TO SCALE

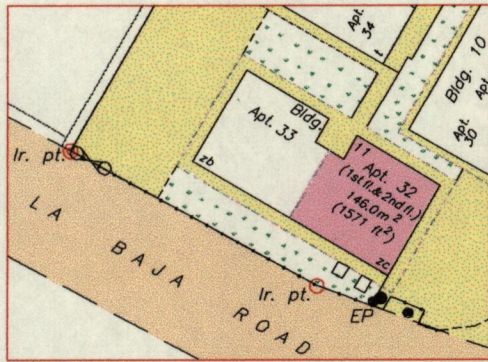

LA BAJA HEIGHTS  
MARACAS VALLEY

now or formerly  
De Four

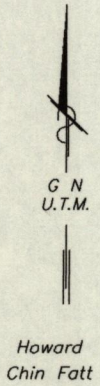

now  
or formerly  
C. H.  
Von Deible

Ronald  
Chang

Henry  
Harry

See  
Inset

\* See Floor Plans for details

- Apts.
- Pool
- Road
- Ravine
- Grassed Areas
- Carpark, Driveway, Walkway Steps & Paved Areas
- Parking under Bldg. 11

- Metre Box
- MH Manhole (Electrical)
- EP Electricity pole
- Gate
- Wall
- Fence
- Drain

○ Denotes Iron found unless otherwise stated  
Bearings are U.T.M. Grid based on Solar observations

Location Plan of Apt. 32 Bldg. 11 of a Condominium Scheme coloured pink in the Ward of Tacarigua  
Containing one hundred and forty six point zero square metres (Floor Area)  
Surveyed by me, with due authority, in May-Nov., 2005, Feb.-June, 2010 & May-June & Oct, 2013 & June, 2015 for La Baja Heights Ltd.  
Certified Correct in accordance with Regulation 25 (1) of the Land Surveyors Regulations 1998.

Entered

*Brian Moses*  
Trinidad & Tobago Land Surveyor (T.T.L.S.)  
20th July 2015

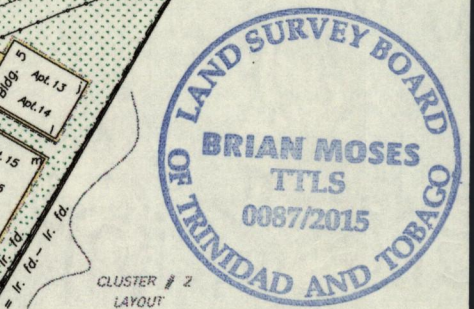

CLUSTER # 2  
LAYOUT  
Howard  
Chin Fatt

Building Ties

a - K	138° 32'	45.86
b - K	152° 35'	31.17
c - K	161° 23'	25.34
d - K	194° 35'	17.38
e - K	118° 37'	41.53
f - k	123° 11'	24.27
g - K	123° 19'	20.31
h - K	170° 10'	4.66
j - K	207° 51'	132.88
l - K	207° 39'	122.23
m - K	207° 37'	118.45
n - K	207° 06'	97.26
o - K	197° 15'	95.54
p - K	194° 37'	76.82
r - k	206° 05'	93.46
s - k	205° 08'	74.96
t - k	126° 45'	72.19
u - k	142° 33'	77.62
v - k	144° 58'	79.23
w - k	151° 34'	83.34
x - k	124° 47'	58.71
y - k	141° 49'	63.00
z - k	144° 24'	64.20
za - k	157° 34'	73.65
zb - k	115° 32'	81.51
zc - k	114° 08'	62.88
k - zb	115° 32'	81.51
k - zc	114° 08'	62.88

k - N 1179606  
E 673228  
Derived From Hand-Held GPS (+/-5 m)  
UTM Zone 20 Naparima Co-ordinates

SCALE 1:1250  
Distances are in METRES

