

Cadastral Sheet B.17.E. $\frac{13E}{4/b}$

Ward of St. Anns

County of St. George

Inset

Process 304109181

Not to Scale

Location Plan

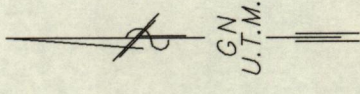
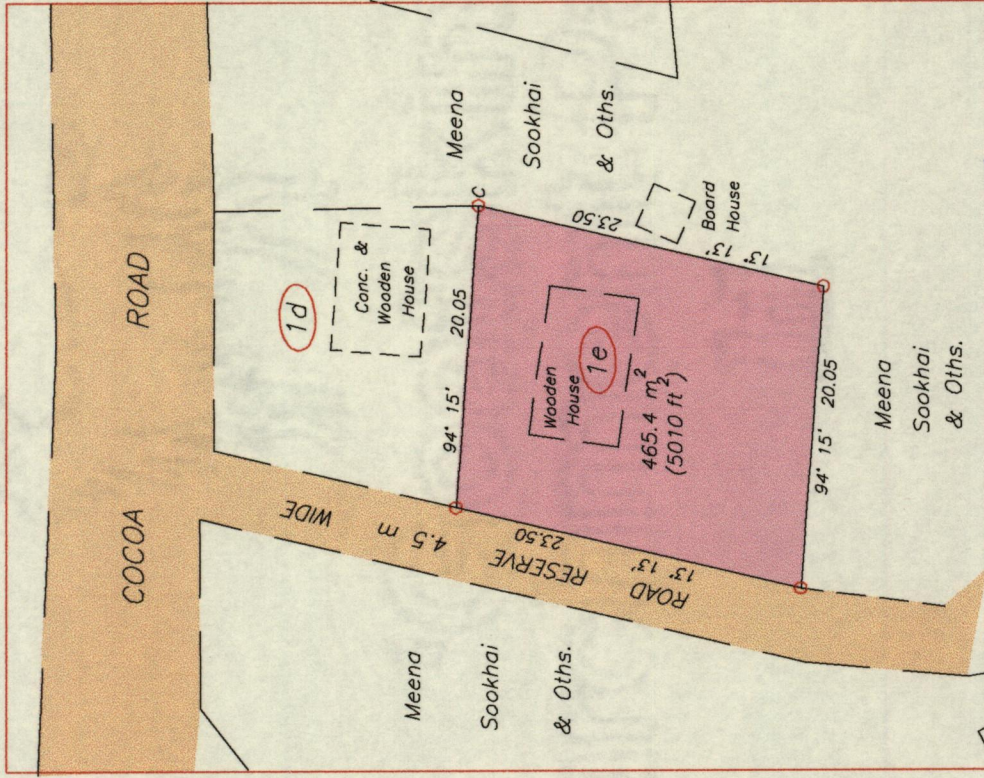
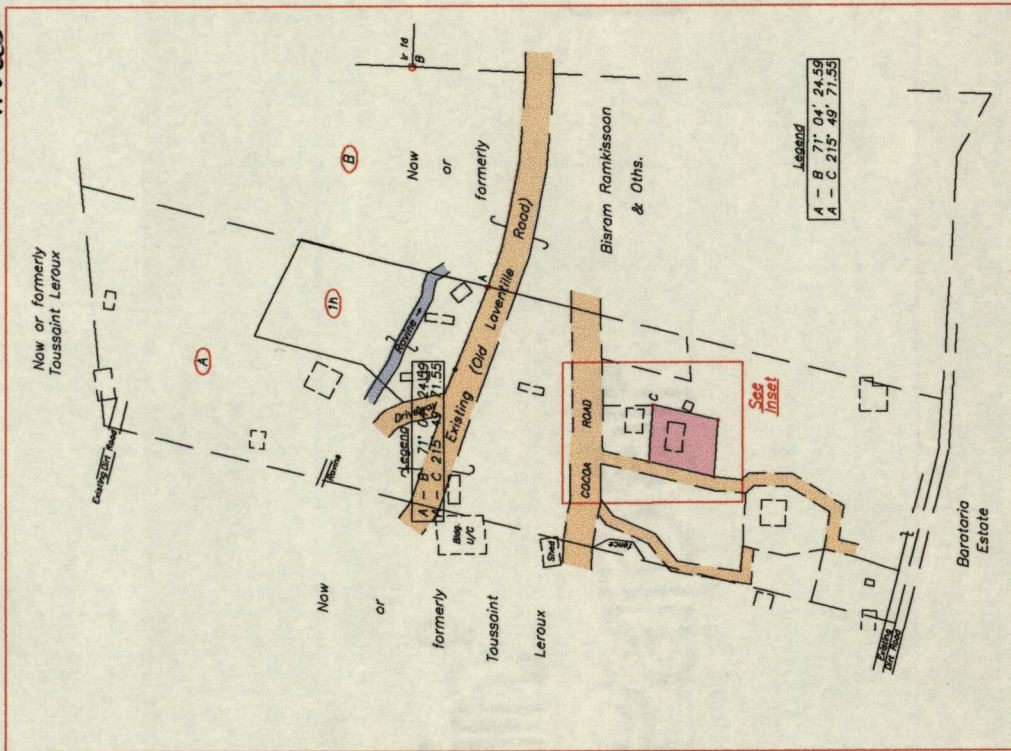

1561

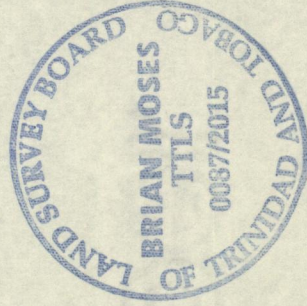

B - N 1179590
E 667671
Derived From Hand-Held GPS (+/-5 m)
UTM Zone 20 Naparima Co-ordinates

SCALE 1:500

Distances are in METRES

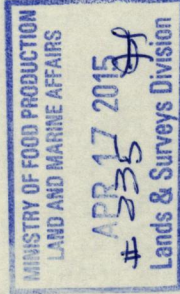

○ Denotes Iron put unless otherwise stated
Bearings are U.T.M. Grid based on Solar observations

PLAN of a Parcel of land coloured pink in the Ward of St. Anns. Containing four six five point four square metres Surveyed by me, with due authority, in March, 2015 for Meena Sookhai & Oths. Certified Correct in accordance with Regulation 25 (1) of the Land Surveyors Regulation 1998.

Brian Moses
Trinidad & Tobago Land Surveyor (T.T.L.S.)
17th APR 2015

67