

Process SA#109166

1561

60

Location Diagram

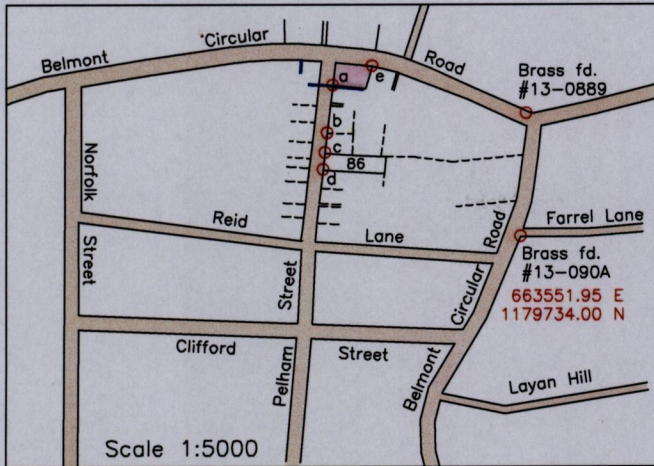

Cadastral Sheet 13E  
3/c A.20.G.  
City of Port of Spain  
County of St. George

Lot 96 Pelham St. also called  
Lot 155 Belmont Circular Rd.  
Belmont

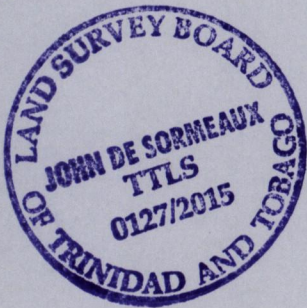
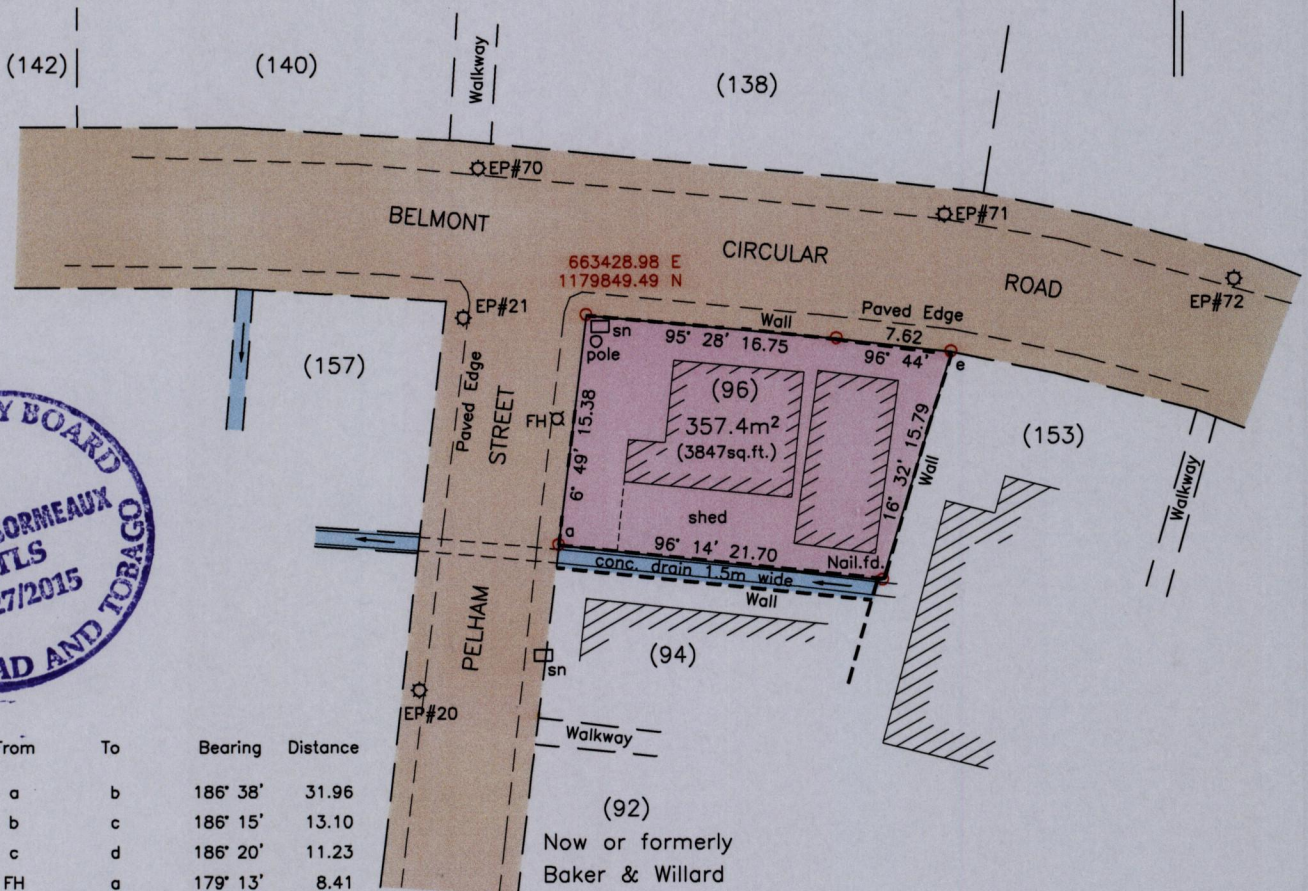
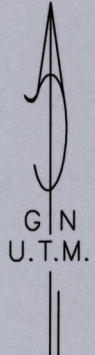

From	To	Bearing	Distance
a	b	186° 38'	31.96
b	c	186° 15'	13.10
c	d	186° 20'	11.23
FH	a	179° 13'	8.41
e	Brass fd. #13-0889	107° 11'	107.24
Brass fd. #13-0889	Brass fd. #13-090A	182° 38'	81.41

Legend

- Electricity Pole      ⊙ EP
- Fire Hydrant        ⊠ FH
- Sign                    □ sn
- Wall                    - - - - -

SCALE 1:500

Distances are in METRES

- Notes: ○ Denotes Ir.f.d. unless otherwise indicated  
 Bearings are U.T.M. Grid based on Solar Observations  
 Previous survey of Lot 96 by Peter Goodridge in June 2001  
 Previous survey of Lot 86 by J. de Sormeaux in Aug. 2014 for Rupert Roy Williams  
 Coordinates (UTM Zone 20, Naparima) obtained from Brass fd. #13-090A

PLAN of a parcel of land coloured pink in the City of Port of Spain  
 Containing three hundred and fifty seven point four square metres  
 Surveyed by me, with due authority, in March 2015 for Rupert Edward McLean  
 Certified Correct in accordance with Regulation 25(1) of the Land Surveyors Regulations 1998.

Checked by  
 Entered on APR 15 2015  
 #187  
 Lands & Surveys Division

John de Sormeaux  
 Trinidad and Tobago Land Surveyor, 14<sup>th</sup> April 2015.