

1561

214

See Plan attached to
Deed No. 2892/65

City of Port of Spain
County of St George
Cadastral Sheet A.20.F. 13d
4/d

Process ID# 111271

PORT OF SPAIN

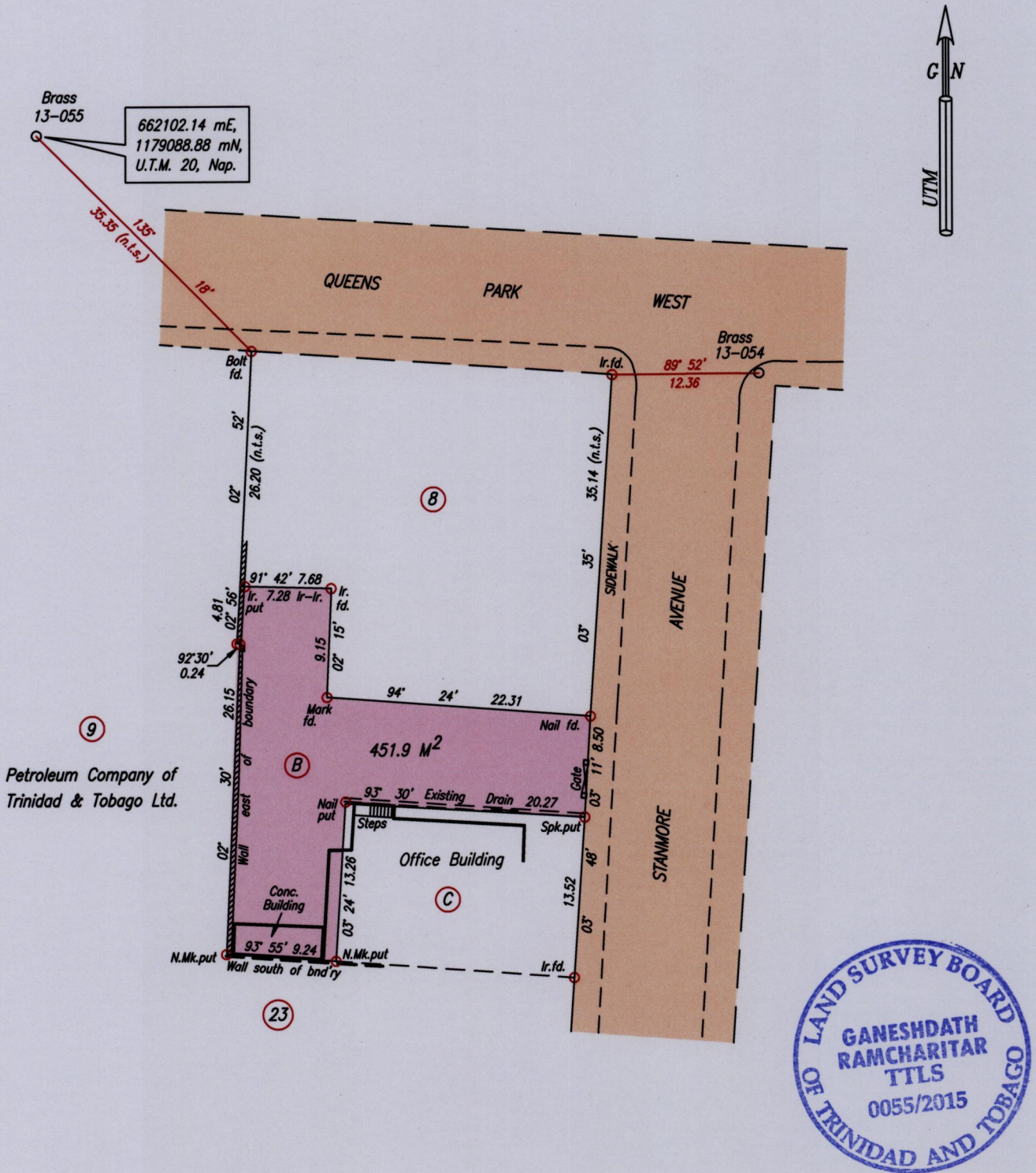

SCALE 1/500

Distances are in metres

Coordinates obtained from L. & S. Records
Bearings are UTM Grid based on Solar Observations
To obtain Cassini bearings, add 18 minutes

PLAN of a Parcel of land coloured pink in the City of Port of Spain
Containing four hundred and fifty one point nine square metres

Surveyed by me with due authority, on July 17th, 2015 at the request of Ian Nath

Certified Correct in accordance with Regulation 25 (1) of The Land Surveyors' Regulations 1998,

Ganeshdath Ramcharitar

Entered on

Trinidad & Tobago Land Surveyor (T.T.L.S) 27/7

