

Process Jd#11177

1561

Cadastral Sheet A.20.A, 13D
City of Port of Spain 3/b
County of St. George

201

GUTHRIE LANDS, ST JAMES

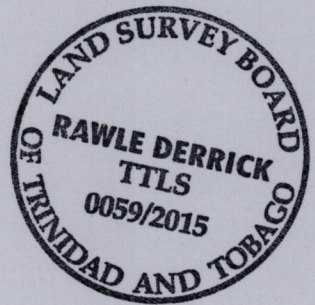
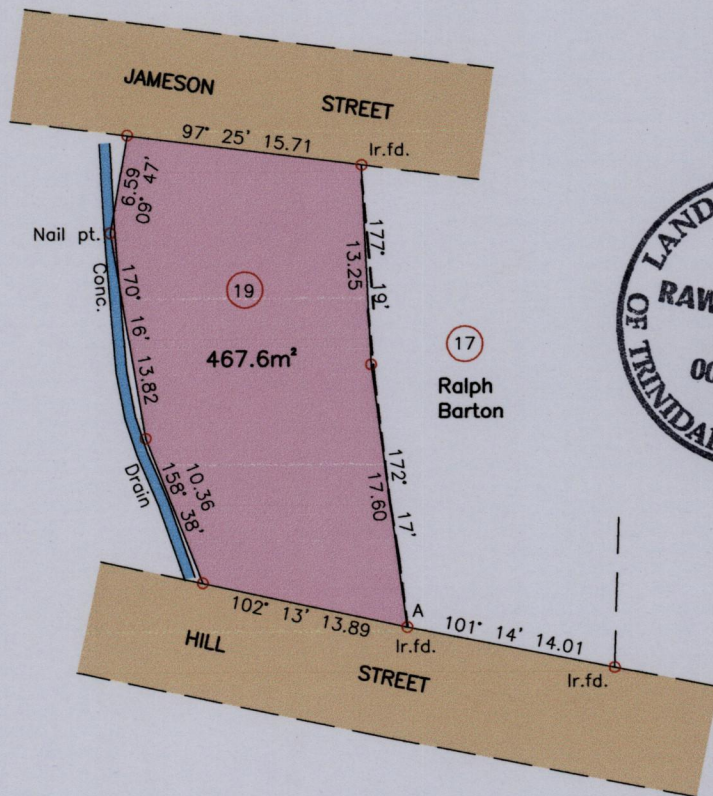

Ir.fd.=A:-N:1180722m
E:660236m
UTM 20, NAP Datum ± 7m
GPS (Hand Held)

Wall Fence - - - - -

SCALE 1/500

Distances are in Metres

○ Denotes Iron put except otherwise stated
Bearings are UTM Grid based on Solar Observations
Plan of a Parcel of land coloured pink in the City of Port of Spain
Containing four six seven point six square metres
Surveyed by me with due authority, in July 2015 for Jean Derrick
Certified Correct in accordance with Regulation 25 (1) of the
Land Surveyors Regulations 1998.

Rawle Derrick

Entered..... Trinidad & Tobago Land Surveyor *July 15*.....2015

