

1561

190

Process ID # 111147

Cadastral Sheet A.15.L. 13B
Ward of St. Anns
County of St. George

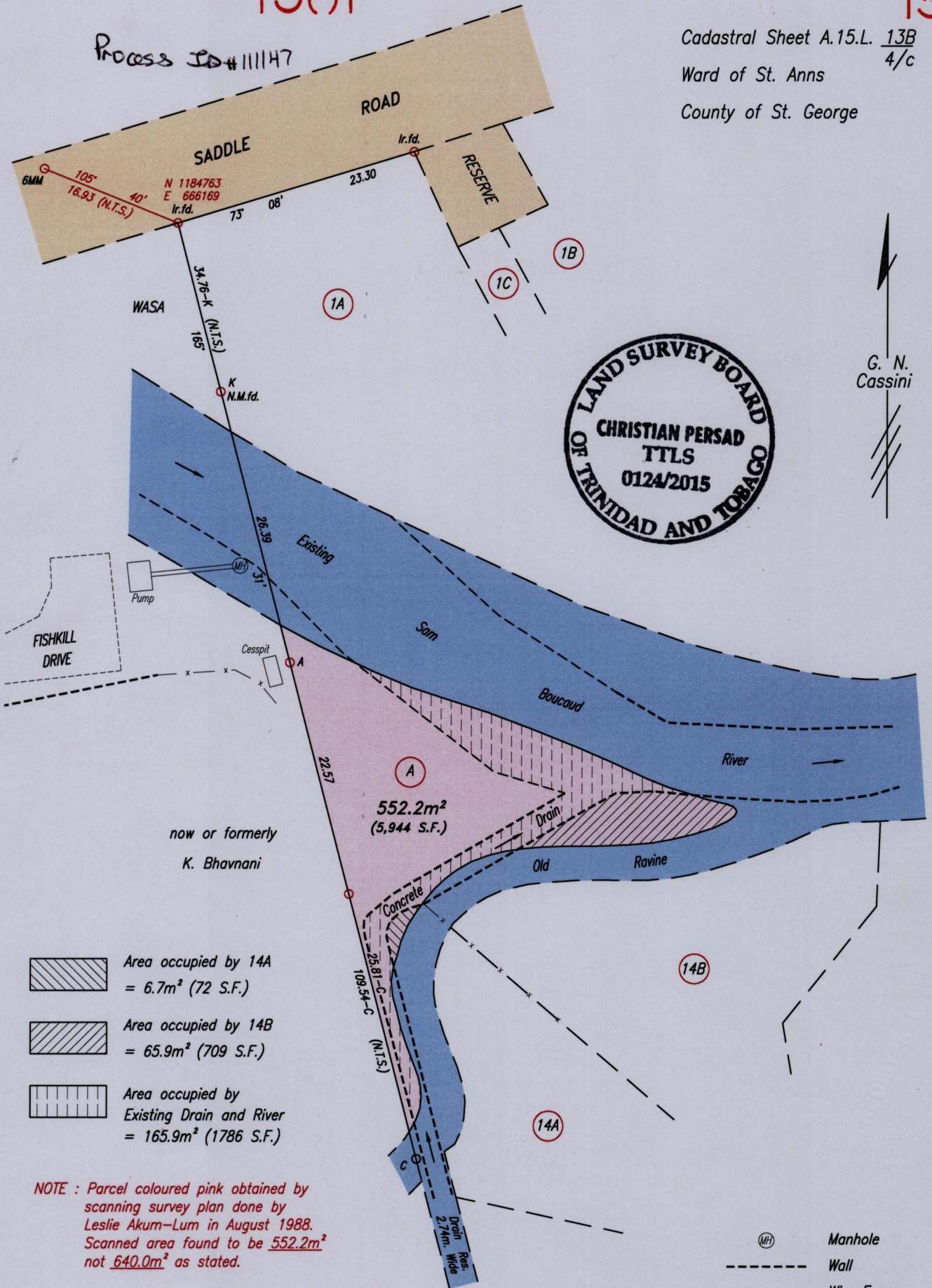

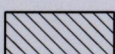
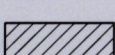
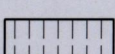
-  Area occupied by 14A = 6.7m² (72 S.F.)
-  Area occupied by 14B = 65.9m² (709 S.F.)
-  Area occupied by Existing Drain and River = 165.9m² (1786 S.F.)

NOTE : Parcel coloured pink obtained by scanning survey plan done by Leslie Akum-Lum in August 1988. Scanned area found to be 552.2m² not 640.0m² as stated.

○ Denotes No mark
 ○ Denotes Iron put except where otherwise stated
 Co-ordinates are Naparima/UTM, derived using handheld GPS (+/-5m)
 Bearings are Cassini Grid based on Solar Observations
 PLAN of a Parcel of land coloured pink in the Ward of St. Anns
 Containing five hundred and fifty two point two square metres
 Surveyed by me, with due authority, on 25th June 2015 at the request of Taurus Services Ltd.
 Certified Correct in accordance with Regulation 25 (1) of the Land Surveyors Regulations 1998

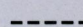
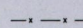
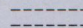
-  Manhole
-  Wall
-  Wire Fence
-  Existing Road

SCALE 1:500
 Distances are in metres

Checked by *Christian Persad*

Entered on Trinidad & Tobago Land Surveyor. 3rd July 2015
 FILE PATH = ADA002 D:\TAURUS SERVICE LTD\TAURUS SERVICE LTD_CADASTRAL.DWG.

MINISTRY OF FOOD PRODUCTION
 LAND AND MARINE AFFAIRS
 JUL - 8 2015
 #126 RR
 Lands & Surveys Division