

1501

154

Process ID# 110643

PLAN AN158  
Survey Order 82/93

Ward of St. Anns  
County of St. George  
Cadastral Sheet B.22C&D 23C  
4/a  
Bamboo # 3

VESTED IN THE HDC BY REGISTERED LEASE 6817/1991

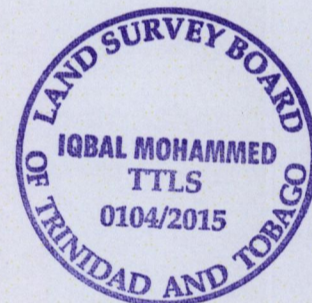
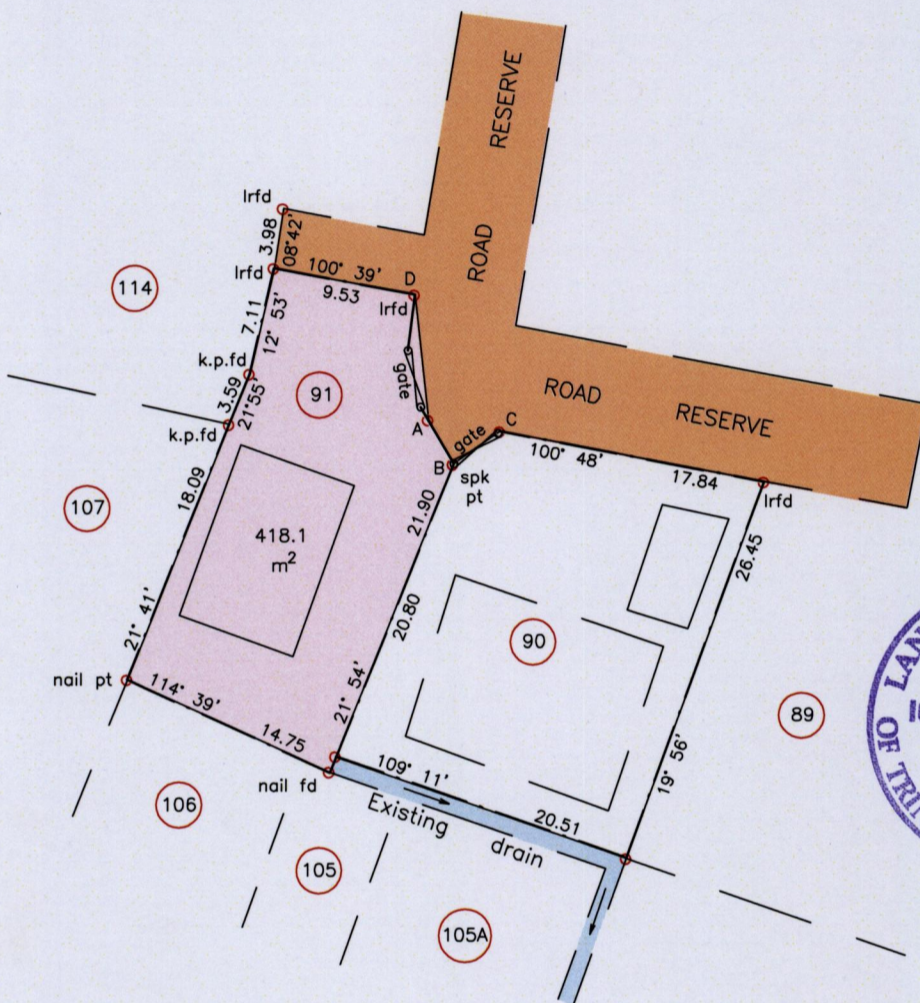

A-B 150° 24' 3.37  
B-C 055° 09' 3.79  
D-A 173° 31' 8.27  
— · — Wall/wire fence  
SCALE 1/750  
Distances are in metres

Iron A  
1175005 mN  
671986 mE

Coordinates are U.T.M. 20, Naparima (+/-3.0m)  
o Denotes Iron put except otherwise stated  
Bearings are Cassini Grid based on Solar Observations  
To obtain UTM bearings subtract 18 minutes  
PLAN of a parcel of land coloured pink in the Ward of St. Anns  
Containing four hundred and eighteen point one square metres  
Surveyed by me with due authority, in June, 2015 for Rosalie Nicholas-Baldeo  
Certified Correct in accordance with Regulation 25 (1) of The Land Surveyors Regulations 1998  
Entered on.....

Trinidad & Tobago Land Surveyor. . . . . 15/6/2015

