

Location Diagram

1501

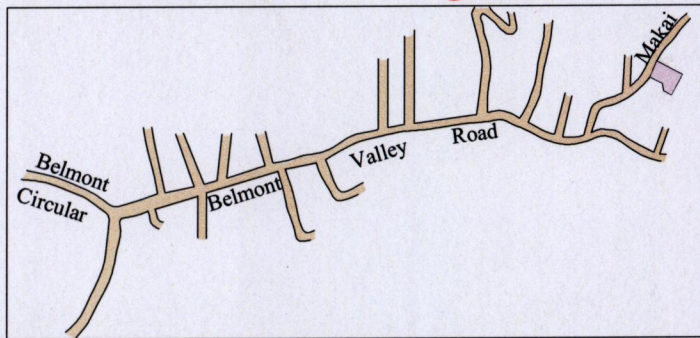

N.T.S

UPPER BELMONT VALLEY

UTM Grid

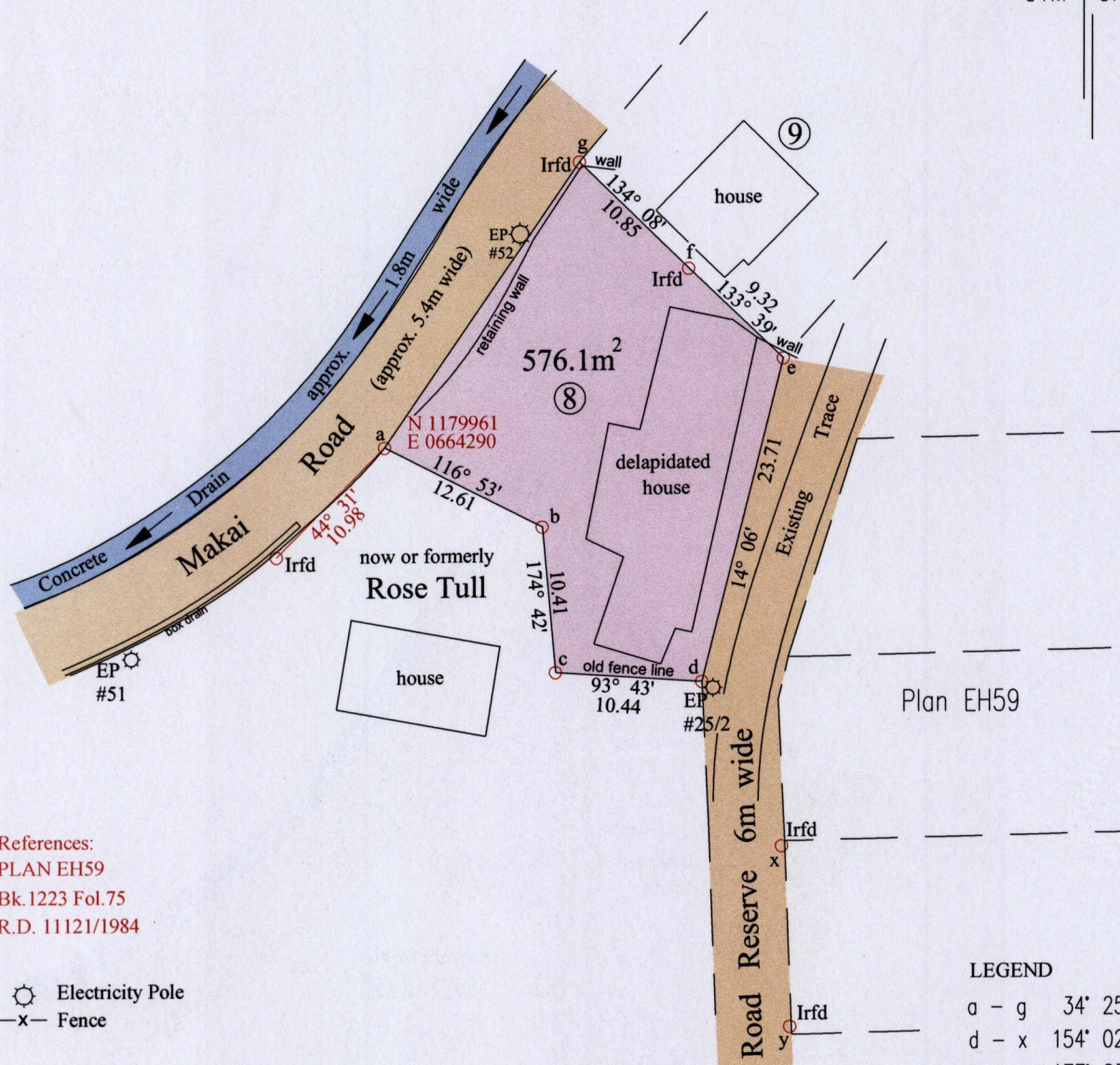

References: PLAN EH59, Bk.1223 Fol.75, R.D. 11121/1984

Electricity Pole, Fence symbols

LEGEND table with boundary measurements: a-g, d-x, x-y

Denotes Iron Put unless otherwise stated

Bearings are UTM Grid based on Solar Observations.

Coordinates obtained using hand held GPS UTM zone 20, Naparima +/- 5.0m

Boundary a,b,c,d as shown on this plan agreed to by KRISHNA NARENE

Boundary e,f,g as shown on this plan agreed to by KAREN DUNCAN-STALLARS

SCALE 1:500

Distances are in Metres

Plan of a Parcel of land coloured pink in the Ward of St. Anns Containing five hundred and seventy six point one square metres Surveyed by me, with due authority, in March 2015 for Portia DeSilva

Certified correct in accordance with Regulation 25(1) of the Land Surveyors' Regulations 1998.

Entered

MINISTRY OF FOOD PRODUCTION LAND AND MARINE AFFAIRS MAY 19 2015 #213 RR Lands & Surveys Division

Signature of Stacey M. Thomas

Trinidad & Tobago Land Surveyor 19th / May 2015

