

1561

1001

Cadastral Sheet B.22.B. 23B  
2/d

Ward of St. Anns

County of St. George

R.D. DE 200900246821

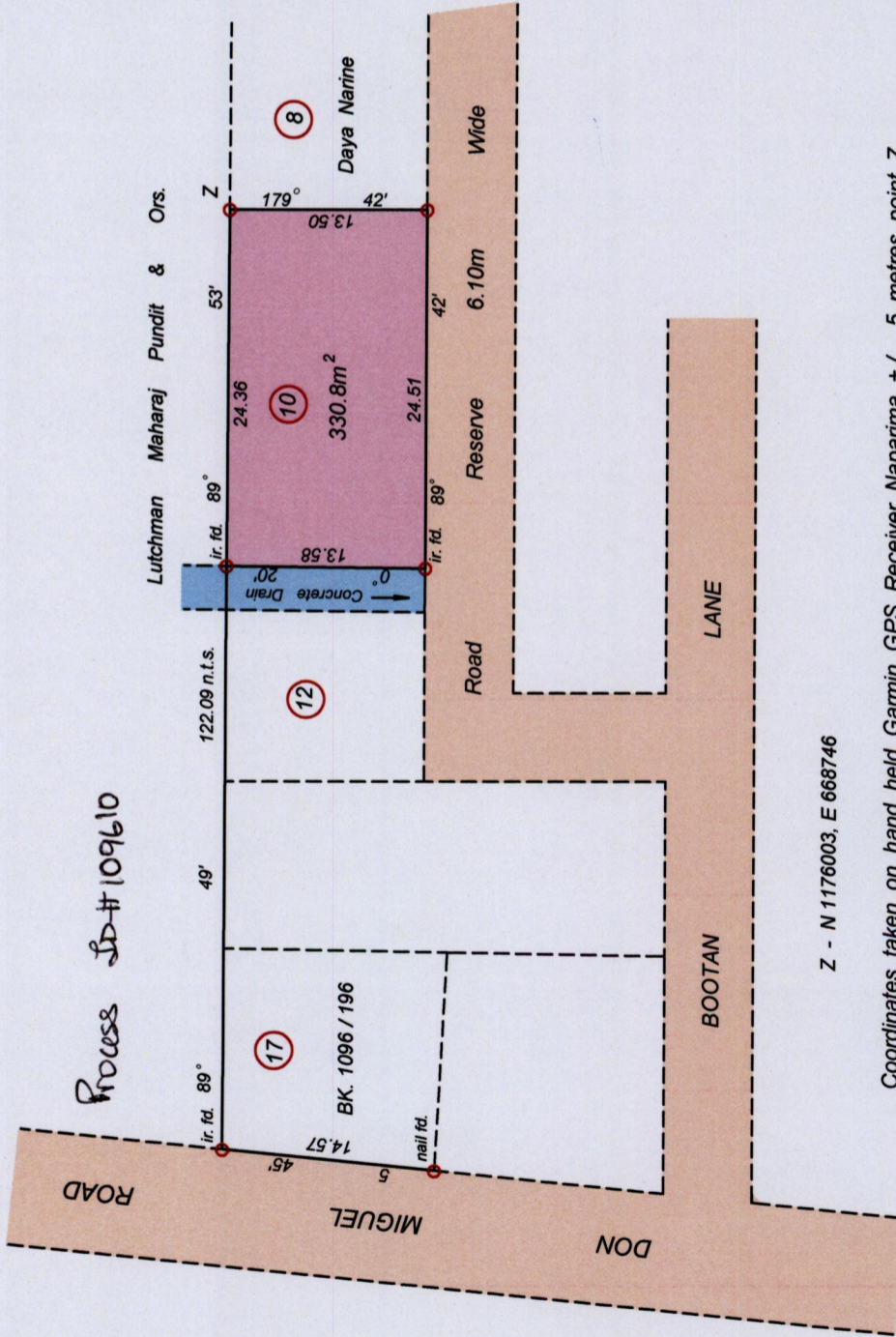
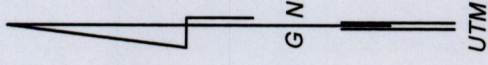

SCALE 1 : 500

Distances are in metres

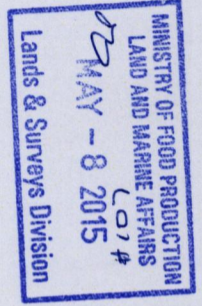
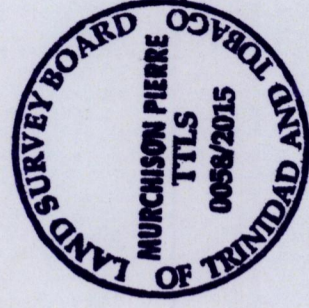

Coordinates taken on hand held Garmin GPS Receiver Naparima +/- 5 metres point Z

- Denotes iron put except otherwise stated
- Bearings are UTM Grid based on Solar Observations

PLAN of a parcel of land coloured pink in the Ward of St. Anns  
Containing three hundred & thirty point eight square metres  
Surveyed by me, with due authority, in April 2015 for Avinash Narine & Kavita Narine  
Certified Correct in accordance with Regulation 25(1) of the  
Land Surveyors Regulations 1998.

Checked by *Murchison Pierre*

Entered on ..... Trinidad & Tobago Land Surveyor *7th May, 2015*

5